

Putting the Pinnacle Brace On

Before putting on the brace, make sure the belt’s pull-tab is on the side, as close to the back pulley mechanism as possible.

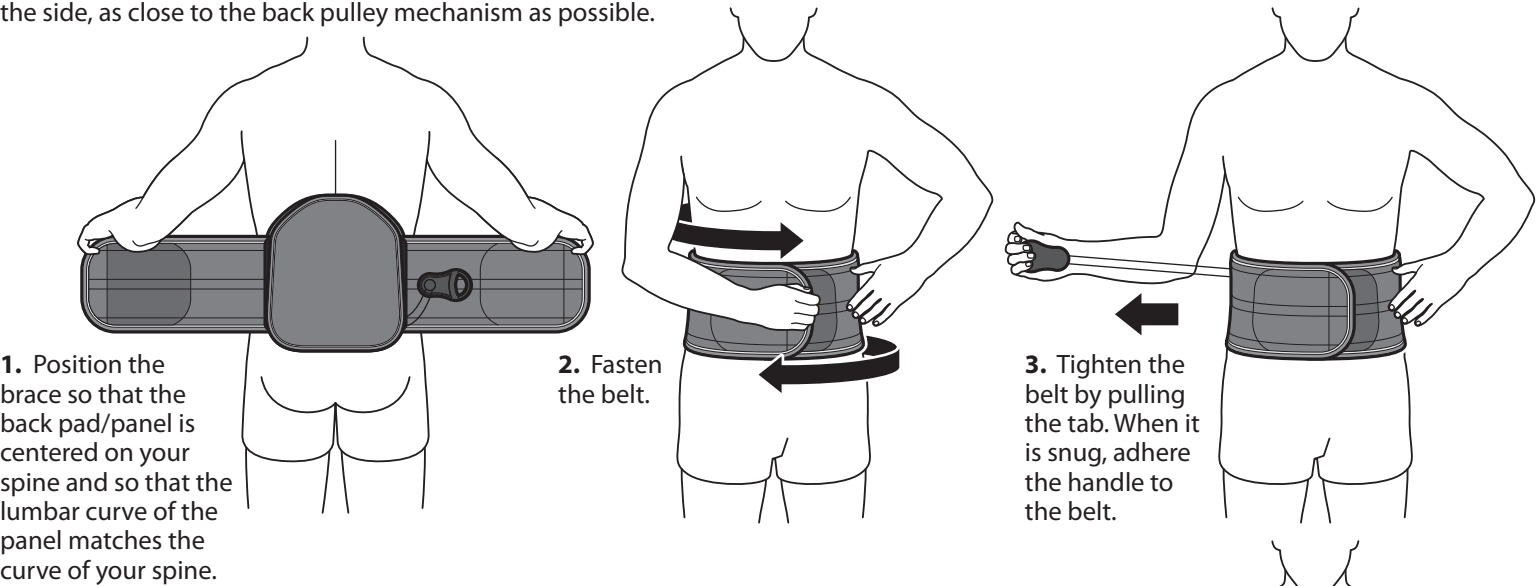

Taking the Pinnacle Brace off

- 1. Loosen the pull-tab in the front of the brace, placing it on the side, as close as possible to the back pulley mechanism.
- 2. Unfasten the belt.

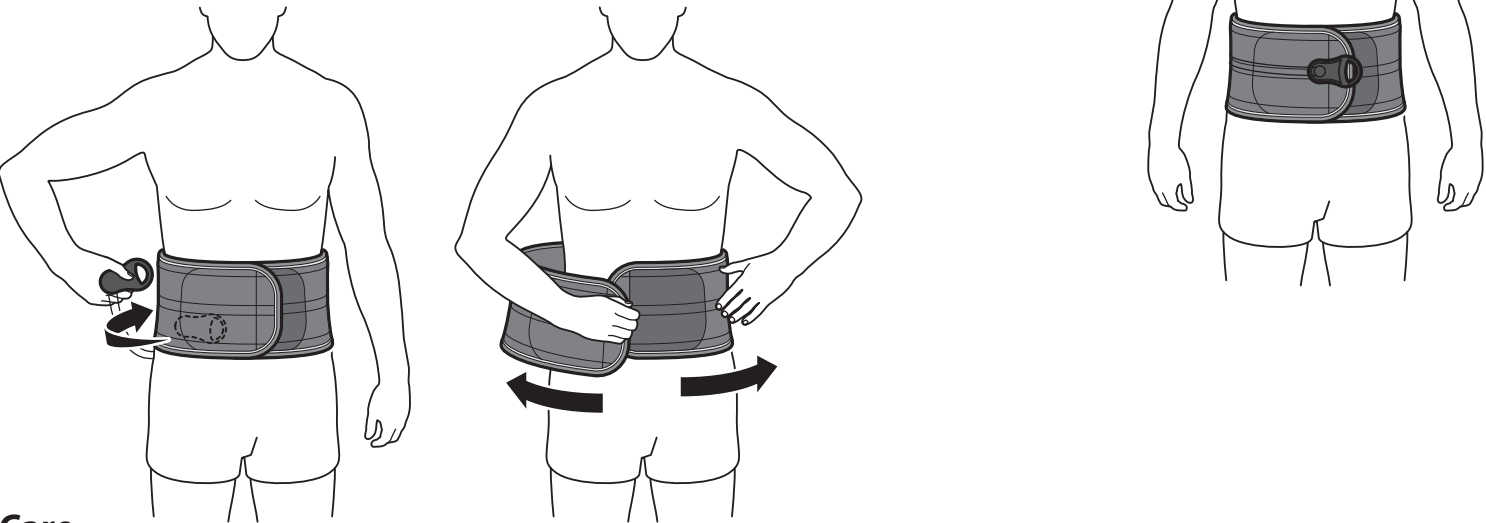

Care

We recommend wearing a cotton t-shirt or similar garment under the brace.

Before you disassemble any part of the brace for cleaning, take care to mark or photograph the location and setup of the brace components so you can return it exactly as it was. Replacing the components inaccurately will destroy the careful fit your healthcare provider has created.

Remove the front plastic panel from the front of the belt. Remove the back fabric padding from the back plastic panel. Hand-wash the padding and belt with mild soap and cool water. Rinse thoroughly. Lay flat to dry. Dry the padding and belt thoroughly before putting it back on the brace. Wipe the plastic sections with a damp cloth, using a mild soap solution, then wipe clean with a wet cloth.

This device is offered for sale by or on the order of a physician or other qualified medical professional. This device is not intended for reuse on a second patient or for extended use beyond 180 days. This device is not intended to prevent injuries or reduce or eliminate the risk of reinjury.

Indications: Indicated for immediate application following injury or operative procedures to sprains, strains, herniated and bulging discs, stable post-operative discectomies and laminectomies, spondylolysis, spondylosis, spinal stenosis and osteoporosis.

Contraindications: Contraindicated for unstable or displaced fractures.

CAUTION: Carefully read fitting instructions and warnings prior to use. To ensure proper performance of the brace, follow all instructions. Failure to properly position the brace and fasten each strap will compromise performance and comfort.

WARNING: Federal law restricts this device to sale by or on the order of a licensed health care practitioner.

WARNING: Do not leave this device in a car on a hot day or in any other place where the temperature may exceed 150° F (65° C) for any extended period of time. If any additional pain or symptoms occur while using this device, discontinue use and seek medical attention.

WARRANTY: This device is warranted to be free from defects in material and workmanship for a period of 180 days for soft goods and lifetime on all rigid components and mechanisms. These warranties apply to devices that have not been modified or subjected to misuse, abuse or neglect. This device is expressly subject to Bledsoe’s Product Line Limited Warranty. Copies of this limited warranty can be obtained from your medical professional, via the internet at www.BledsoeBrace.com, or by calling 1.800.527.3666.



Pinnacle Brace

APPLICATION INSTRUCTIONS

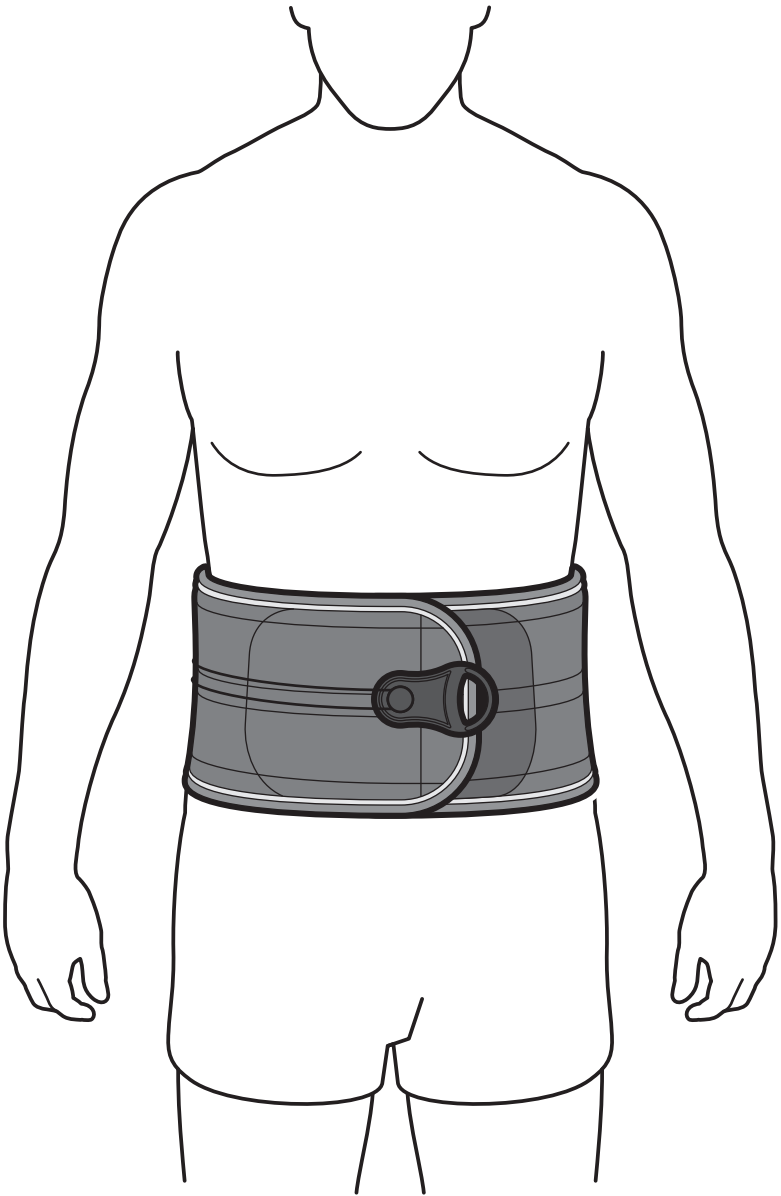

Council Directive 93/42/EEC
of 14 June 1993 concerning
Medical devices

CP020287 Rev A 0114

© 2014 Medical Technology, Inc. dba Bledsoe Brace Systems.
A division of United Orthopedic Group. All rights reserved.
2601 Pinewood Drive, Grand Prairie, Texas, 75051, USA
Toll Free Tel.1.888.BLEDSONE (253.3763)
Or 1.800.527.3666 • Local 972.647.0884
Local FAX 972.660.5495
www.BledsoeBrace.com

EUROPEAN AUTHORIZED REPRESENTATIVE



Emergo Europe
Molenstraat 15
2513 BH The Hague
The Netherlands
Tel: (+31) 70 345 8570
Fax: (+31) 70 346 7299

Sizing the Belt

1. Remove the pulley system and posterior panels from belt to adjust length. This is done by removing the Panel strap tabs from the belt.

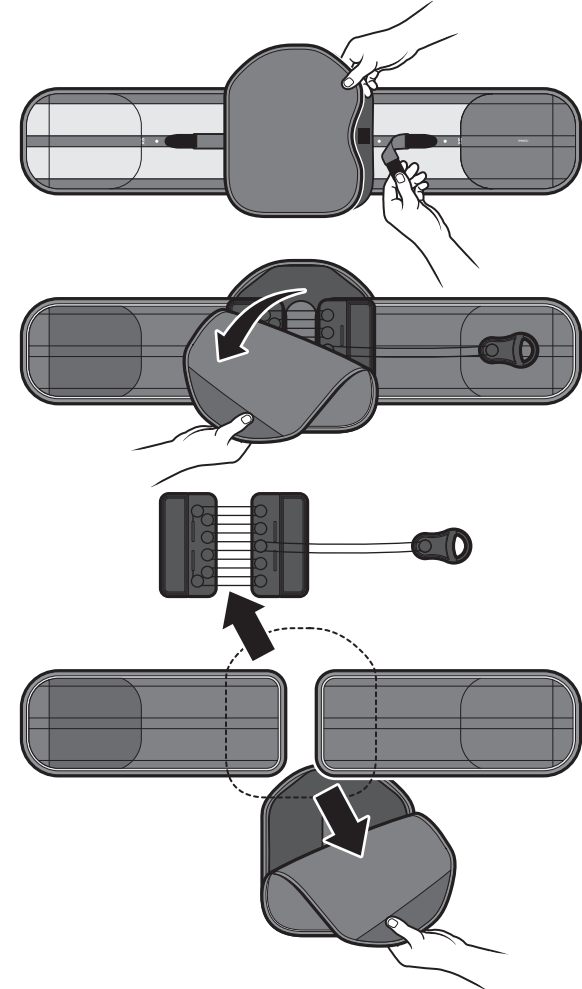

2. Open the size indicator tab (the tab with small hole or window), fold the brace and align the size indicator window over the desired number or dot corresponding with the patient's waist circumference and secure the edges. Repeat this step for both sides of the belt.

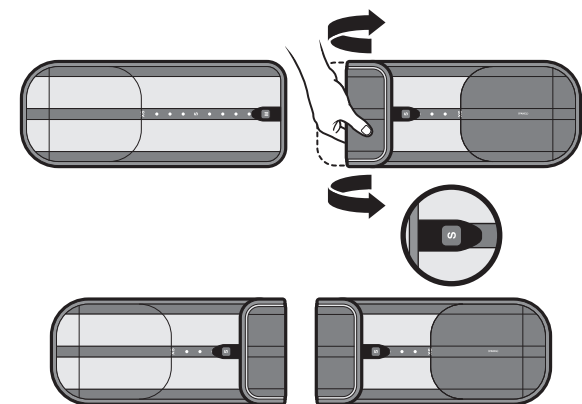

Waist size chart (level of belly button)

S-29" M-35" L-37" XL-41" 2X-47" 3X-53" 4X-59"

3. Reattach pulley system to adjusted belt (ensure edge of the pulley system lines up with the edge of the fabric fold). Press down firmly.

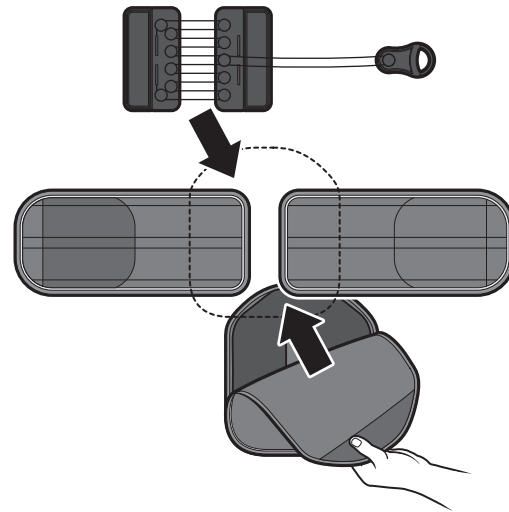

4. Keep belt fully extended and reattach posterior panel and secure it to belt with Velcro straps tabs.

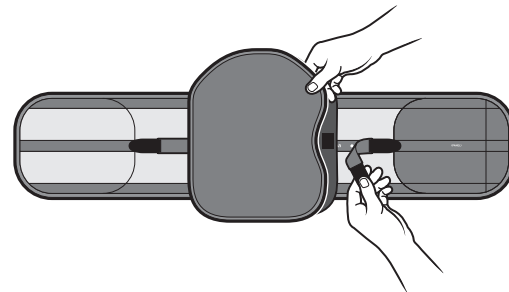

5. Reattach posterior cover.

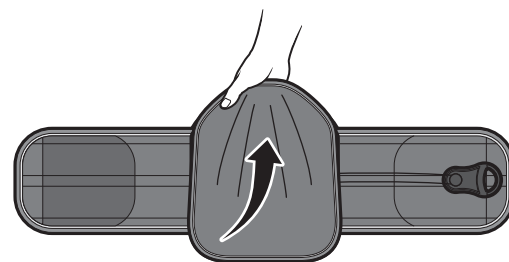

Adjusting Lateral Panels

6. Remove padding from largest posterior panel to reveal the lettering and numbering system for size adjustment.

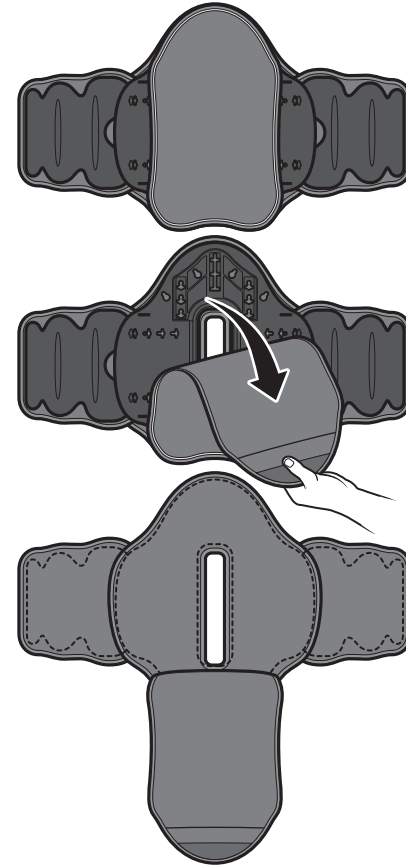

7. Gently push the removable lateral panels inward to unlock and remove from their preset positions.

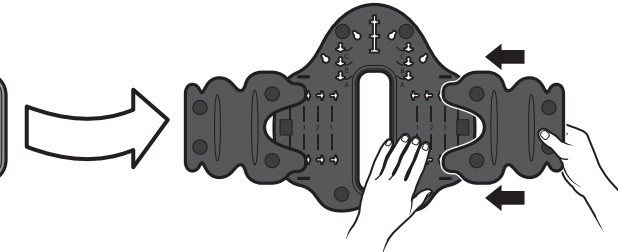

8. Realign the 2 posts with their corresponding letter or number and once the posts are in the correct-sized holes pull them outward to reset to the locked position.

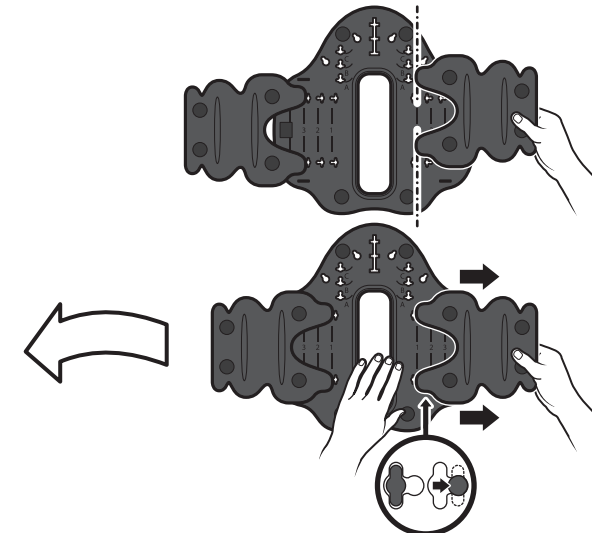

9. Reattach padding and corset.

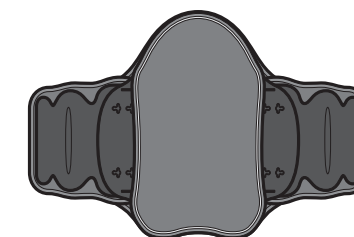

Adjusting Thoracic Panel

10. Remove padding from largest posterior panel to reveal the lettering and numbering system for size adjustment.

11. Gently push the panel downward to unlock and remove from its present position.

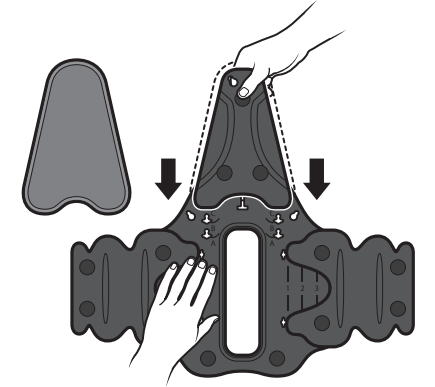

12. Realign the 3 posts with their corresponding letter or number and once the posts are in the correct-sized holes pull them outward to reset to the locked position.

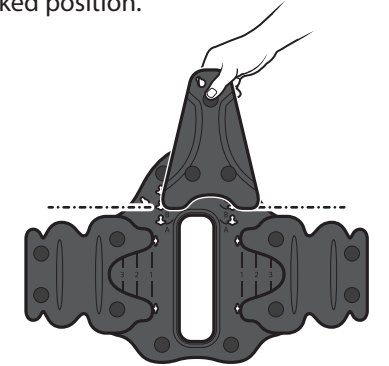

13. Reattach padding to panel and then to corset.

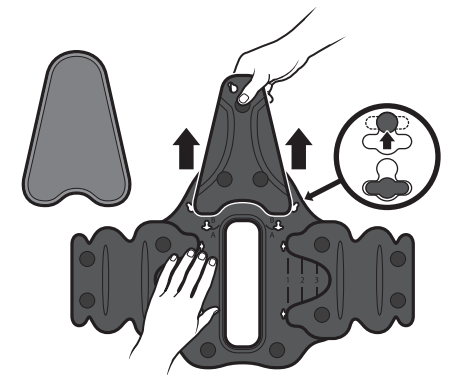

Belt Application on next page.