



ELLuminer Trunk Installation Instructions

*Thanks for purchasing **ELLuminer**—Frunk and Trunk lighting for the Model S.*

IMPORTANT: Although we provide detailed instructions for the installation of ELLuminer, the project may be more than some non-DIYers can manage. If you feel uncomfortable with this installation for any reason, we strongly recommend that you engage a professional installer to do the work for you.

Please read these instructions in their entirety before you begin and then follow each step as you proceed with the installation. An installation video can be found at www.teslaccessories.com.

RECOMMENDATION: We recommend installing the Frunk ELLuminer lighting first. The Frunk install is a bit easier and will enable you to learn the wire connections and approach before you work on the Trunk.

IMPORTANT: **ELLuminer installation should be performed with the car charging cable disconnected from the Model S.**

Tools needed for the installation: a 2-foot piece of 14/2 Romex cable for snaking ELLuminer wire, electrical tape or black duct tape, a flat head screwdriver may also be useful .



ELLuminer Trunk Installation Instructions

Step 1. Disconnect the new ELLuminer wire at the connector as shown.

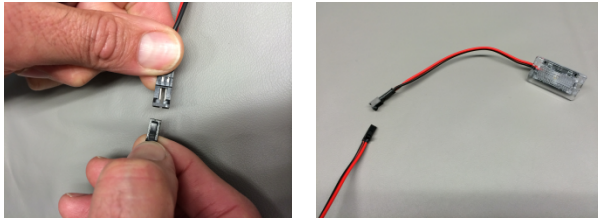

Step 2. Remove the existing Tesla LED Assembly at the bottom rear passenger OR driver side of the trunk wall. The LED assembly snaps out fairly easily with your fingers. You may also use a flat head screwdriver. There are two wires attached to the Tesla LED assembly, and it likely will come out about 2 inches only.

Step 3. Disconnect the Tesla LED assembly from the wires being careful not to allow the wires to retract into the hole. To accomplish this, you must depress the locking clip and slide the connector out from the assembly.



Step 4. After removing the Tesla assembly, place it in the prepaid envelope for recycling.





ELLuminer Trunk Installation Instructions

Step 5. Using your fingers, pull the trunk side panel outward as shown in the photo. DO NOT try to pull it off, just enough to provide an opening as shown.



Step 6. Get a 2-foot piece of scrap 14/2 Romex electrical wire and bend it as shown in the photo.



Step 7. Snake the Romex cable from the LED assembly hole in the lower corner of the trunk upward to the opening as shown in the photo.





ELLuminer Trunk Installation Instructions

Step 8. Tape the connector end of the ELLuminer wire to the Romex cable and pull it through the LED assembly hole so that the connector is hanging out of the hole by 4 – 5 inches.



Step 9. Remove the tape attaching the ELLuminer wire from the Romex cable. The connector end is ready to be reconnected to the New ELLuminer LED light assembly, plug it in to the new LED, push the wires into the hole, and replace the LED assembly in its hole.



ELLuminer Trunk Installation Instructions

Step 10. Pull the ELLuminer wire through the side panel opening and pass it through the large hole near the Tesla Parcel Shelf bracket.



Step 11. Once the wire has been threaded through the hole on the underside of the side panel, align the ELLuminer LED strip on the bottom side of the plastic Tesla Parcel Shelf bracket running along the side, it is a personal preference in positioning the LED strip .



Step 12. Push the side panel back into place.

Step 13. With the supplied Nail Polish Remover Pads wipe the plastic portion on the underside of the Tesla Parcel Shelf bracket to clean the surface for a better adhesion of the LED strip.





ELLuminer Trunk Installation Instructions

Step 14. After the cleaned surface is dry 2-3 minutes, pull off the protective liner from the adhesive on the back of the LED strip, and with firm pressure stick the LED strip to the cleaned surface.

Step 15. Use electrical or black duct tape to fasten the ELLuminer wires to keep them fixed and hidden in the area of the Tesla Parcel Shelf bracket.

You're done!