

74MAXXUM
74 lbs Thrust
24 volt
52" & 62" SHAFT

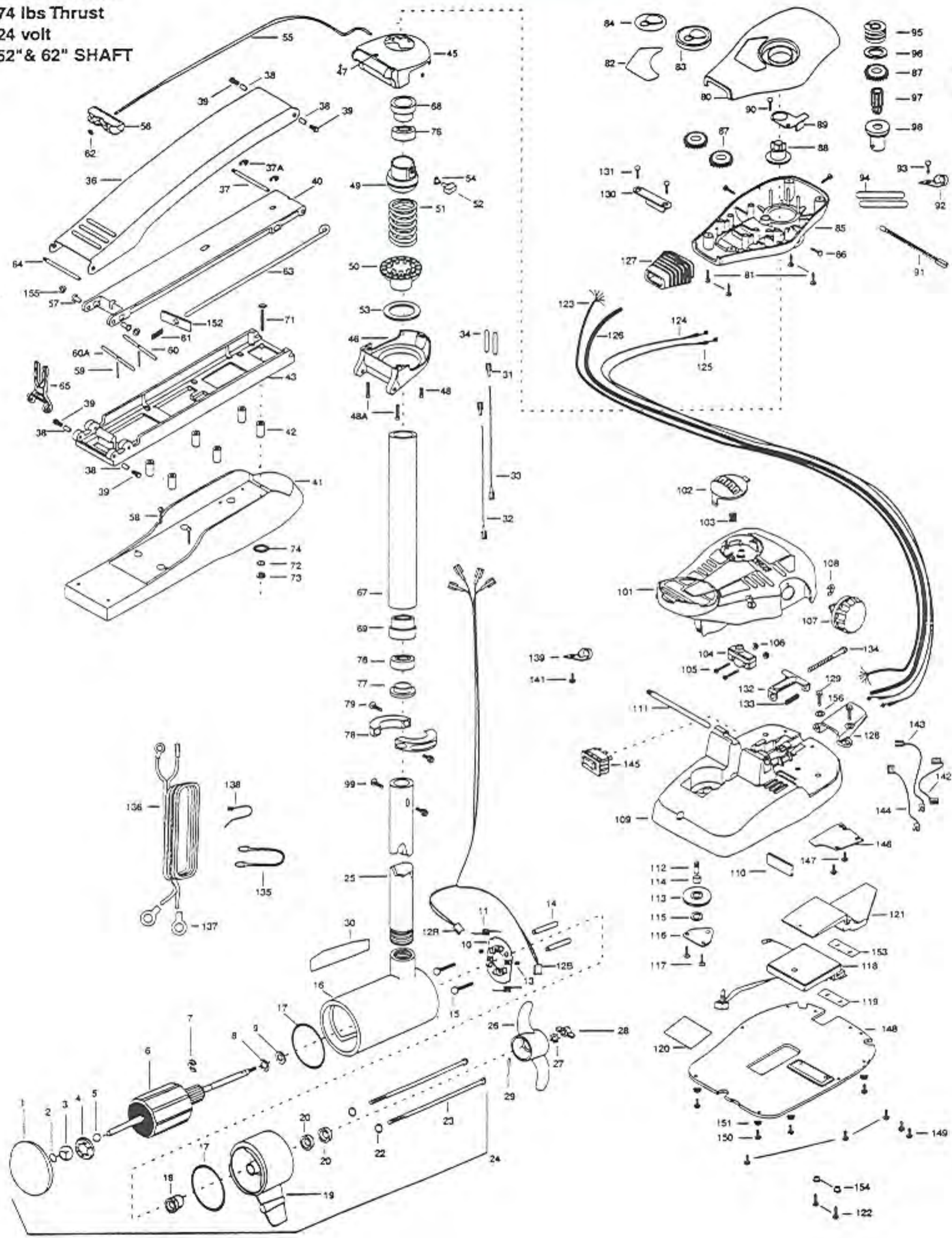

In the U.S.A., replacement parts may be ordered directly from MINN KOTA Parts Dept., 10000 W. Marquette, Minneapolis, Minnesota 55401. In Canada, parts may be ordered from any of the Canadian Authorized Service Centers shown on the enclosed list. Be sure to provide the MODEL and SERIAL numbers of your motor when ordering parts. Please use the correct part numbers from the parts list. Payment for any parts ordered from the MINN KOTA parts department, may be by cash, personal check, Discover Card, MasterCard or VISA. To order, call 1-800-227-6433 or FAX 1-800-527-4464.

Fuera de los Estados Unidos, consultar la lista anexa para ubicar el Centro de Servicio autorizado MINN KOTA. No olvidar de incluir el número del MODELO y el número de SERIE del motor para el cual se solicitan las piezas. Usar siempre los números de pieza correctos indicados en la lista de piezas.

Hors de États-Unis, voir la liste ci-jointe pour le Centre de Service Agréé MINN KOTA le plus proche. Lors d'une commande, ne pas oublier de fournir le numéro de modèle et le numéro de série du moteur. Toujours mentionner le numéro de pièce exact figurant sur la liste des pièces de rechange.

Fora da América do Norte, consultar a lista anexa para identificar o Centro de Serviço Autorizado MINN KOTA. Não deixe de incluir o número do MODELO e o número de SÉRIE do seu motor ao pedir peças. Sempre use os números corretos das peças da lista de peças.

1	409024	PLAIN ENDBELL	*54	2263100	NUT-1/4-20 INSERT	108	2263000	E-RING
2	406050	THRUST DISC	55	2251601	HOPE- 40"	*109	2264550	FOOT PEDAL BASE ASSEMBLY (INCL. 109,110,112)
3	409600	SPHERICAL BEARING	56	2150400	PULL-GRIP	*110	2266413	PLATE- TENSION SCREW
4	409301	BEARING RETAINER	57	2236000	BEARING NYLONER (2 REQ'D)	111	2260511	PIN-PIVOT
5	405010	BALL-STEEL	58	2263434	SCREW-8-18 X 1 (2 REQ'D)	*112	2260515	PIN-PULLEY-AXLE
6	410203	ARMATURE ASSEMBLY	59	2152610	SPRING-PIN (LOCKBAR) (2 REQ'D)	113	2262300	PULLEY (FOOT PEDAL)
7	409300	E-RING	60	2233600	LOCK BAR- BOW MOUNT	114	2260000	BEARING-PULLEY
8	409170	THRUST WASHER- STEEL (AS REQ'D)	60A	2233602	LOCK BAR- REAR	115	2261705	WASHER-NYLATRON
9	409171	THRUST WASHER- NYLON (AS REQ'D)	61	2152700	SPRING (LOCKBAR)	116	2266400	COVER-PULLEY
10	409402	BRUSH PLATE ASSEMBLY	62	2151700	WASHER-EYE SHAFT .562 OD	117	2301310	SCREW-8-18 X 1/2 (2 REQ'D)
11	406083	BRUSH SPRING (2 REQ'D)	63	2153605	EYE SHAFT-2 LOCKBAR LONG	118	2264011	CONTROL BOARD ASSEMBLY
12R	409073	BRUSH ASSEMBLY-RED	64	2260506	HINGE-PIN, HEADLESS ZINC	119	2365106	INSULATING PAD- 1.1 X 2.75
12B	409074	BRUSH ASSEMBLY-BLK	65	2293810	YOKE, MAXXUM MOUNT	120	2365107	INSULATING PAD- 2.3 X 3.2
13	409343	SET SCREW -BRUSH	66	2992014	TUBE W/BEARING RACE- 62" SHAFT	121	2264018	HEAT SINK, MAXXUM FT
14	405151	BRUSH PLATE SPACER (2 REQ'D)		2992016	TUBE W/BEARING RACE- 52" SHAFT	122	2263447	SCREW-8-32 X 1 (2 REQ'D)
15	405341	BRUSH PLATE SCREW (2 REQ'D)	*67	2272067	TUBE OUTER 24" -ORDER 66	123	2261219	WIRE HARNESS A/T&MAX 82.5
16	409257	CENTER SECTION W/MAGNETS		2272068	TUBE OUTER 34" -ORDER 66	124	2267500	CABLE ASSY-RIGHT (5')
17	409460	O-RING (2 REQ'D)	68	2266260	BEARING RACE	125	2267510	CABLE ASSY-LEFT (5')
18	409000	FLANGE BEARING (SERVICE ONLY)	69	2266220	BEARING RACE-STEEL	126	2265430	CABLE JACKET (5')
19	409033	BRUSH END HOUSING	70	2994830	BAG ASSEMBLY-MAXXUM FW	127	2265110	BOOT-CONTROL BOX
20	409461	SEAL (2 REQ'D)	*71	2263431	SCREW 1/4-20 X 3.5 (6 REQ'D)-ORDER 70	128	2265115	BOOT-FOOT PEDAL BASE
22	409462	O-RING - THRU BOLT (2 REQ'D)	*72	2261713	WASHER-1/4 FLAT (6 REQ'D) ORDER 70	129	2372100	SCREW-8-18 X 5/8 FT. PDL (2 REQ'D)
23	409352	THRU BOLT (2 REQ'D)	*73	2263103	NUT-1/4-20 NYLOC JAM (6 REQ'D-ORDER 70)	130	2261900	BRACKET-CONDUIT
24	2317033	MOTOR ASSEMBLY 52"-62"	*74	2301720	WASHER-MOUNTING, RUBBER (6 REQ'D) ORDER 70	131	2301310	SCREW-8-18 X 1/2 (2 REQ'D)
25	2032067	TUBE- COMPOSITE 52"	75	2266610	DECAL-ON/OFF SWITCH	132	2263210	BRACKET-CONDUIT ADJUSTMENT
	2032068	TUBE- COMPOSITE 62"	76	2266000	BEARING BALL-STEEL (2 REQ'D)	133	2262720	SPRING-CONDUIT ADJUSTMENT
26	2331120	PROPELLER (W.WEDGE)	77	2266115	BEARING CONE	134	2263460	SCREW-1/4-20 X 2"
27	2091700	LOCKWASHER-PROP	78	2771615	COLLAR HALVES KIT	135	2340610	CONNECTOR CABLE-(12", 4GA)
28	2093100	NUT-PROP	79	2263450	SCREW-10-24 X 7/8 (2 REQ'D)	136	2261227	LEADWIRE -VARIABLE
29	2092600	PIN-DRIVE	80	2260283	CONTROL BOX COVER-MAXXUM	137	2020700	TERMINAL RING, 3/8" (2 REQ'D)
30	2006601	DECAL-LOWER UNIT	81	2372100	SCREW-8-18 X 5/8 (4 REQ'D)	138	2256300	TIE WRAP-5.5" BLACK
31	2030710	CONNECTOR BUTT (2 REQ'D) (62" SHAFT)	82	2265532	DECAL COVER, MAXXUM 74	139	2263201	CLAMP WIRE HARNESS MICRO
32	2030317	WIRE EXTENSION-18" -RED (62" SHAFT)	83	2260150	POINTER DISC TRNSLCNT RED	141	2332103	SCREW-6-20 X 3/8
33	2030316	WIRE EXTENSION-18" -BLACK (62" SHAFT)	84	2265800	DECAL-INDICATOR	142	2260316	CONNECTING WIRE (VAR.SPD)
34	2375400	SHRINK TUBE-1/40D X 1-3/4 (2 REQ'D) (62" SHAFT)	85	2262531	CONTROL BOX-PLASTIC	143	2260312	WIRE-BLK/WHT 19 1/4"
35	2991974	MOUNT, BOW ASSEMBLY- LONG	86	2262109	SCREW-8-32 X 1/2 (3 REQ'D)	144	2260323	WIRE-BLK/GRN VARIABLE
36	2264216	ARM UPPER-FW LONG	87	2267800	GEAR-INDICATOR (3 REQ'D)	145	2254031	SWITCH-MOM/OFF/COM
37	2260513	HINGE PIN (MAX A/T)	88	2262220	INDICATOR-DRIVE	146	2266412	SWITCH PLATE, FT PEDAL
37A	2263010	E-RING 3/8 DIA SHAFT (2 REQ'D)	89	2261905	BRACKET/INDICATOR	147	2332103	SCREW-6-20 X 3/8 (2 REQ'D)
38	2293501	BUSHING (4 REQ'D)	90	2301310	SCREW-8-18 X 1/2	148	2264510	BOTTOM PLATE, MAXXUM
39	2263500	BOLT, SHOULDER (4 REQ'D)	91	2264015	LIGHT/INDICATOR	149	9953104	SCREW-8 X 1/2 (5 REQ'D)
40	2774316	ARM-LOWER FW LONG	92	2263201	CLAMP WIRE HARNESS	150	2263455	SCREW #12-14 X 1/2 (4 REQ'D)
41	2999265	MOTOR REST ASSEMBLY LONG	93	2301310	SCREW-8-18 X 1/2	151	2265126	BUMBER PAD, FOOT PEDAL (4 REQ'D)
42	2261505	SPACER, MOTOR REST (6 REQ'D)	94	2355410	SHRINK TUBE-3/8 OD X 2' (2 REQ'D)	152	2262703	SPRING STOP
43	2251972	BOW PLATE, LONG	95	2232360	PULLEY-CABLE DRUM	153	2265105	INSULATING PAD
44	2991988	BOWGUARD ASSEMBLY FT CTL MAX XL (INCL 45-54)	96	2261730	WASHER-NYLON	154	2261712	WASHER- INSULATED
*45	2991992	BRACKET BASE-TOP W/INSERT	*97	2267805	PINION DRIVE	155	2261707	WASHER- 3/8 X 1/2 (2 REQ'D)
*46	2991993	BRACKET BOTTOM W/BEARING ASSEMBLY	*98	2266246	TOP BEARING RACE	156	2261714	WASHER-MAX FT PDL (2 REQ'D)
*47	2232351	EYELET-ROPE	99	2263410	SCREW-8-32 X 5/16 (2 REQ'D)			
*48	2263402	SCREW 1/4-20 X 3/4	100	2992023	FOOT PEDAL ASSEMBLY			
*48A	2263420	BOLT 1/4-20 X 2 (2 REQ'D)	101	2790002	FOOT PEDAL/PLUG ASSEMBLY			
*49	2261525A	SPRING-SLEEVE UPPER	102	2263700	PUSH-BUTTON, FOOT PEDAL			
*50	2261532	SPRING SLEEVE LWR	103	2302732	SPRING-LOWER PEDAL			
*51	2262706	SPRING, BOWGUARD, NIK PL	104	2264023	SWITCH-SEALED ASSEMBLY			
52	2011365	SCREW-COLLAR/NEW KNOB	105	2262114	SCREW-MOUNTING/SWITCH (2 REQ'D)			
53	2261531	BEARING- BOWGUARD	106	2233100	NUT-SWITCH MOUNT (2 REQ'D)			
			107	2260160	KNOB-SPEED CONTROL			

PARTS LIST

MAX 74 - 52" & 62"

* This item is part of an assembly. This item cannot be sold separately due to machining and /or assembly that is required.

Max 74

