

76 lbs Thrust
24 Volt

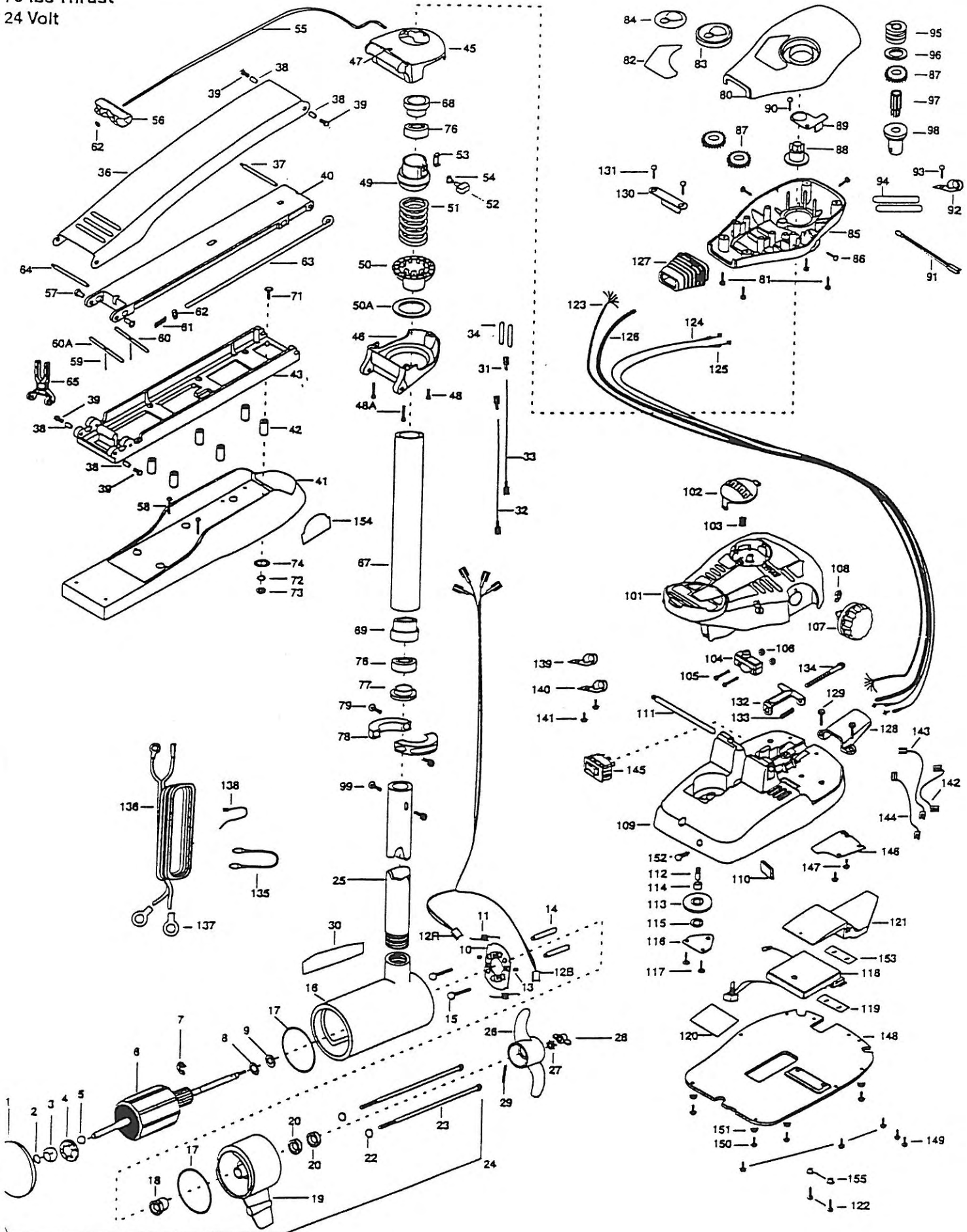

PARTS DIAGRAM

numbers of your motor when ordering parts. Please use the correct part numbers from the parts list. Payment for any parts ordered from Card MasterCard or VISA. MINN KOTA parts department, may be by cash, personal check, Discover or VISA. For more information on the enclosed list, be sure to provide the MODEL and SERIAL number of your motor. MINN KOTA parts department, may be by cash, personal check, Discover or VISA. For more information on the enclosed list, be sure to provide the MODEL and SERIAL number of your motor.

Ne pas oublier de fournir les numéros de Modèle et de Série de votre Moteur lorsque vous placez une commande. Employez les numéros de pièce exact se trouvant sur la list des pièces de remplacement.

para identificar el Centro de Servicio Autorizado MINN KOTA. Não deixe de incluir o número do MODELO e o número de SÉRIE do seu motor ao pedir peças. Sem o uso dos números corretos das peças da lista de peças de reposição, não será possível identificar o Centro de Serviço Autorizado MINN KOTA.

PARTS LIST

1	409024	PLAIN ENDBELL	52	2011385	SCREW-TENSION/NEW KNOB	103	2302732	SPRING-LOWER PEDAL
2	406050	THRUST DISC	*53	2262800	TENSION BLOCK -ALUMINUM	104	2284023	SWITCH-SEALED ASSEMBLY
3	409600	SPHERICAL BEARING	*54	2263100	NUT-1/4-20 INSERT	105	2262114	SCREW-MOUNTING/SWITCH (2 REQ'D)
4	409301	BEARING RETAINER	55	2251801	ROPE- 40"	106	2233100	NUT-SWITCH MOUNT (2 REQ'D)
5	405010	BALL-STEEL	56	2150400	PULL-GRIP	107	2260160	KNOB-SPEED CONTROL
6	410203	ARMATURE ASSEMBLY	57	2238000	BEARING NYLINER (2 REQ'D)	108	2263000	E-RING
7	409300	E-RING	58	2283434	SCREW-8-18 X 1 (2 REQ'D)	*109	2264550	FOOT PEDAL BASE ASSEMBLY (INCL. 109,110,112)
8	409170	THRUST WASHER- STEEL (AS REQ'D)	59	2152810	SPRING-PIN (LOCKBAR) (2 REQ'D)	*110	2268413	PLATE- TENSION SCREW
9	409171	THRUST WASHER- NYLON (AS REQ'D)	60	2233800	LOCK BAR- BOW MOUNT	111	2260511	PIN-PIVOT
10	409401	BRUSH PLATE ASSEMBLY	60A	2233802	LOCK BAR- REAR	*112	2260515	PIN-PULLEY-AXLE
11	406083	BRUSH SPRING (2 REQ'D)	61	2152700	SPRING-(LOCKBAR)	113	2262300	PULLEY (FOOT PEDAL)
12A	409076	BRUSH ASSEMBLY-RED 82"	62	2161700	WASHER-EYE SHAFT .562 OD	114	2280000	BEARING-PULLEY
12B	409077	BRUSH ASSEMBLY-BLK 82"	63	2153605	EYE SHAFT- LONG	115	2261705	WASHER-NYLATRON
13	409343	SET SCREW -BRUSH	64	2260508	HINGE-PIN, HEADLESS ZINC	116	2266400	COVER-PULLEY
14	405151	BRUSH PLATE SPACER (2 REQ'D)	65	2293810	YOKE, MAXXUM MOUNT	117	2301310	SCREW-8-18 X 1/2 (2 REQ'D)
15	405341	BRUSH PLATE SCREW (2 REQ'D)	68	2992014	TUBE W/BEARING FACE- 82" SHAFT	118	2264011	CONTROL BOARD ASSEMBLY
16	409257	CENTER SECTION W/MAGNETS	*67	2272068	TUBE OUTER 34" -ORDER 66	119	2385106	INSULATING PAD- 1.1 X 2.75
17	409460	O-RING (2 REQ'D)	68	2266260	BEARING RACE	120	2385107	INSULATING PAD- 2.3 X 3.2
18	409000	FLANGE BEARING (SERVICE ONLY)	69	2288220	BEARING RACE-STEEL	121	2264018	HEAT SINK, MAXXUM FT
19	409033	BRUSH END HOUSING	70	2994830	BAG ASSEMBLY-MAXXUM FW	122	2283434	SCREW-8-18 X 1 (2 REQ'D)
20	409461	SEAL (2 REQ'D)	*71	2283431	SCREW 1/4-20 X 3.5 (8 REQ'D)-ORDER 70	123	2261217	WIRE HARNESS
22	409462	O-RING -THRU BOLT (2 REQ'D)	*71A	2283435	SCREW 1/4-20 X 3.5 (2 REQ'D)-ORDER 70	124	2287500	CABLE ASSY-RIGHT (5')
23	409342	THRU BOLT (2 REQ'D)	*72	2281713	WASHER-1/4 FLAT (8 REQ'D)-ORDER 70	125	2267510	CABLE ASSY-LEFT (5')
24	2317033	MOTOR-ASSEMBLY 82"	*73	2283102	NUT-1/4-20 (8 REQ'D-ORDER 70)	126	2265430	CABLE JACKET (5')
25	2032066	TUBE- COMPOSITE 82"	*74	2301720	WASHER-MOUNTING, RUBBER (8 REQ'D)-ORDER 70	127	2265110	BOOT-CONTROL BOX
26	2331120	PROPELLER (W.WEDGE)	75	2266610	DECAL-ON/OFF SWITCH	128	2265115	BOOT-FOOT PEDAL BASE
27	2091700	LOCKWASHER-PROP	76	2266000	BEARING BALL-STEEL (2 REQ'D)	129	2262113	SCREW-8-18 X 1/2 FT.PDL (2 REQ'D)
28	2093100	NUT-PROP	77	2266115	BEARING CONE	130	2261900	BRACKET-CONDUIT
29	2092800	PIN-DRIVE	78	2771815	COLLAR HALVES KIT	131	2301310	SCREW-8-18 X 1/2 (2 REQ'D)
30	2006601	DECAL-LOWER UNIT	79	2283450	SCREW-10-24 X 7/8 (2 REQ'D)	132	2263210	BRACKET-CONDUIT ADJUSTMENT
31	2030710	CONNECTOR BUTT (2 REQ'D)	80	2260283	CONTROL BOX COVER-MAXXUM	133	2262720	SPRING-CONDUIT ADJUSTMENT
32	2030317	WIRE EXTENSION-18" -RED	81	2372100	SCREW-8-18 X 5/8 (4 REQ'D)	134	2263460	SCREW-1/4-20 X 2"
33	2030318	WIRE EXTENSION-18"-BLACK	82	2265538	DECAL COVER, MAXXUM 76	135	2340610	CONNECTOR CABLE-(12", 4GA)
34	2375400	SHRINK TUBE-1/40D X 1-3/4 (2 REQ'D)	83	2260150	POINTER DISC TRNSLCNT RED	136	2261227	LEADWIRE -VARIABLE
35	2991974	MOUNT, BOW ASSEMBLY- LONG	84	2265800	DECAL-INDICATOR	137	2020700	TERMINAL RING, 3/8" (2 REQ'D)
36	2264216	ARM UPPER-FW LONG	85	2262630	CONTROL BOX-PLASTIC	138	2258300	TIE WRAP-5.5" BLACK
37	2260507	HINGE PIN (THREADED)	86	2262109	SCREW-8-32 X 1/2 (3 REQ'D)	139	2263201	CLAMP WIRE HARNESS MICRO
38	2293501	BUSHING (4 REQ'D)	87	2287800	GEAR-INDICATOR (3 REQ'D)	140	2263200	CLAMP-WIRE HARNESS
39	2263500	BOLT, SHOULDER (4 REQ'D)	88	2282220	INDICATOR-DRIVE	141	2332103	SCREW-6-20 X 3/8 (2 REQ'D)
40	2774312	ARM-LOWER FW LONG	89	2281905	BRACKET/INDICATOR	142	2260318	CONNECTING WIRE (VAR.SPD)
41	2999265	MOTOR REST ASSEMBLY LONG	90	2301310	SCREW-8-18 X 1/2	143	2260311	CONNECTING WIRE 19 1/4"
42	2261505	SPACER, MOTOR REST (8 REQ'D)	91	2284015	LIGHT/INDICATOR	144	2260321	CONNECTING WIRE-VARIABLE
43	2251972	BOW PLATE, LONG	92	2263201	CLAMP WIRE HARNESS	145	2254031	SWITCH-MOM/OFF/COM
44	2271935	BRACKET ASSEMBLY (INCL 45-54)	93	2301310	SCREW-8-18 X 1/2	146	2268412	SWITCH PLATE, FT PEDAL
*45	2261937	BRACKET BASE-TOP	94	2355410	SHRINK TUBE-3/8 OD X 2" (2 REQ'D)	147	2332103	SCREW-6-20 X 3/8 (2 REQ'D)
*46	2282040	BRACKET BASE BOTTOM	95	2232360	PULLEY-CABLE DRUM	148	2264510	BOTTOM PLATE, MAXXUM
*47	2232351	EYELET-ROPE	96	2281730	WASHER-NYLON	149	2303412	SCREW-6-20 X 5/8 (5 REQ'D)
*48	2283402	SCREW 1/4-20 X 3/4	*97	2287805	PINION DRIVE	150	2283455	SCREW #12-14X1/2 (4 REQ'D)
*48A	2263420	BOLT 1/4-20 X 2 (2 REQ'D)	*98	2288246	TOP BEARING RACE	151	2265126	BUMBER PAD, FOOT PEDAL (4 REQ'D)
*49	2281520	SPRING-SLEEVE UPPER	99	2263410	SCREW-8-32 X 5/16 (2 REQ'D)	152	2262651	PUSH PIN
*50	2281533	SPRING SLEEVE LWR	100	2992023	FOOT PEDAL ASSEMBLY	153	2265105	INSULATING PAD
*50A	2281531	BEARING- BOWGUARD	101	2790002	FOOT PEDAL/PLUG ASSEMBLY	154	2265602	DECAL- NAWA
*51	2282702	SPRING, BOWGUARD, NIK PL	102	2283700	PUSH-BUTTON, FOOT PEDAL	155	2281712	SHOLDR WASHER (2 REQ'D)

76 MAXXUM NAWA

This item is part of an assembly. This item cannot be sold separately due to machining and/or assembly that is required.

WIRING DIAGRAM

