

50AT
50 lbs Thrust
12 Volt

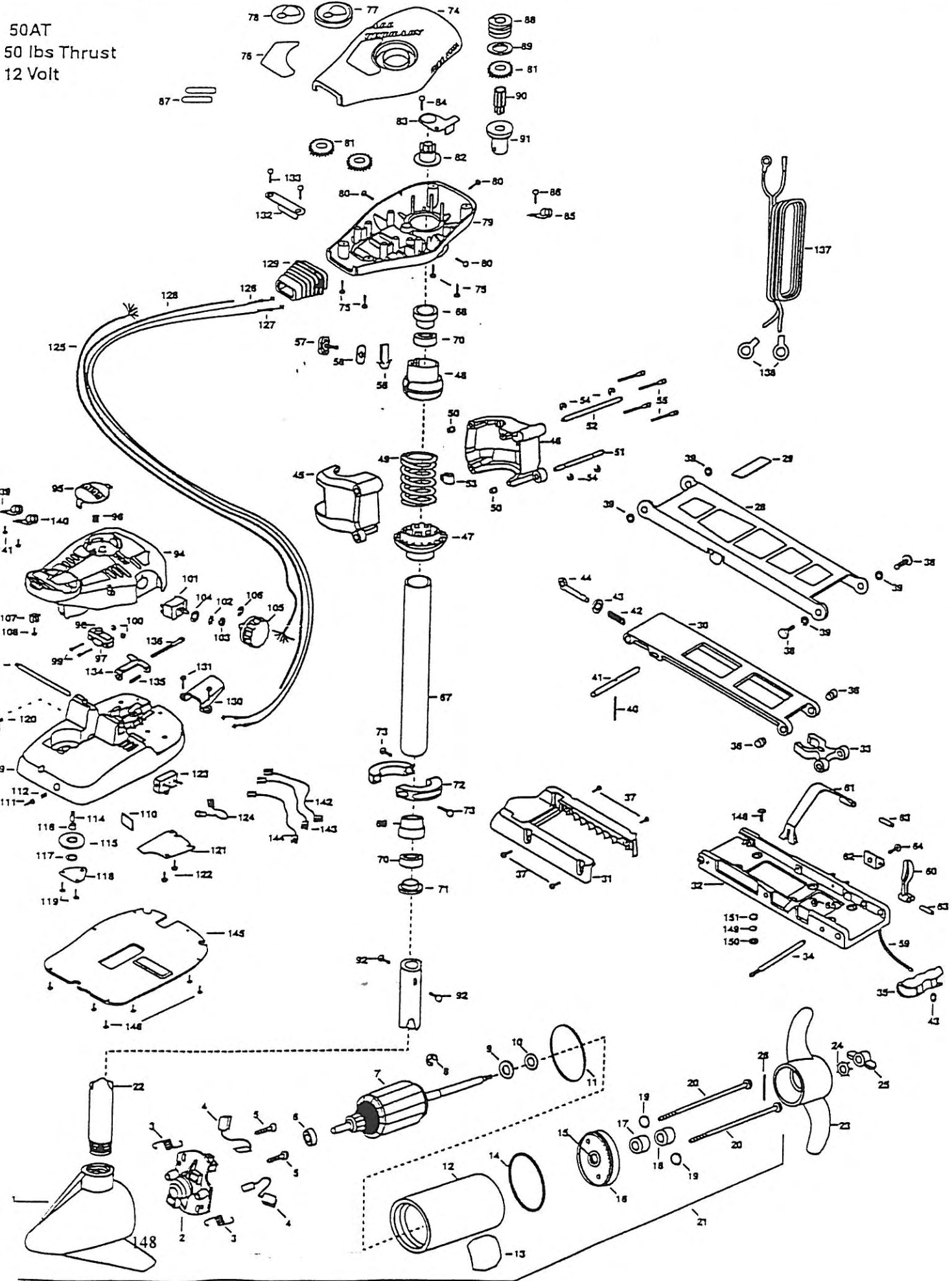

any parts ordered from MINN KOTA parts department, may be by cash, personal check, Discover Card, MasterCard or VISA/ order, call 1-800-227-6433 or FAX 1-800-527-4484.

of votre Moteur lorsque vous placez une commande. Employez le numéro de pièce exact se trouvant sur la liste des pièces de remplacement.

Não deixe de incluir o número do MODELO e o número da SÉRIE do seu motor ao pedir peças. Sempre use os números corretos das peças da lista de pe

1	409028	BRUSH END HOUSING W/COIL	58	2263100	NUT-1/4-20 INSERT	115	2262300	PULLEY (FOOT PEDAL)
2	406403	BRUSH PLATE ASSY 3.5/8 DIA	59	2251600	ROPE	116	2260000	BEARING-PULLEY
3	406082	SPRING- BRUSH (2 REQ'D)	60	2287200	LATCH LEVER	117	2261705	WASHER-NYLATRON
4	406071	BRUSH (2 REQ'D)	61	2263800	STRAP-HOLD DOWN	118	2266400	COVER-PULLEY
5	406342	BRUSH PLATE SCREW (2 REQ'D)	62	2261910	BRACKET HOLD DOWN STRAP	119	2301310	SCREW-8-18 X 1/2 (2 REQ'D)
6	406010	BALL BEARING	63	2260500	PIN-ROLL LATCH LEVER (2 REQ'D)	120	2254031	SWITCH-MOM/OFF/COM
7	406211	ARMATURE ASSEMBLY	64	2263440	SCREW-10-24 X 3/4	121	2266412	SWITCH PLATE, FT PEDAL
8	405300	E-RING-ARMATURE	65	2333101	NUT-HEX	122	2332103	SCREW-6-20 X 3/8 (2 REQ'D)
9	406170	WASHER-THRUUST (STEEL)	66	2992015	TUBE W/BEARING RACE ASSY	123	2268200	CIRCUIT BREAKER-30AMP
10	405171	WASHER-NYLATRON THRUUST	67	2272068	TUBE OUTER-18"	124	2260601	WIRE CNTG-10GA.BREAKER
11	408490	GASKET	68	2266260	BEARING RACE-(565T)	125	2261207	WIRE HARNESS
12	406257	CENTER HOUSING FIELD ASSY	69	2266220	BEARING RACE- STEEL	126	2267500	CABLE ASSY-RIGHT (5')
13	2006609	DECAL,MOT-LWR UN STGRALN	70	2266000	BEARING- BALL (2 REQ'D)	127	2267510	CABLE ASSY-LEFT (5')
14	408470	O-RING	71	2266115	BEARING CONE	128	2265430	CABLE JACKET (5')
15	406600	BEARING-(FLANGE,SERVICE ONLY)	72	2261615	COLLAR HALF (2 REQ'D)	129	2265110	BOOT-CONTROL BOX
16	406033	PLAIN END HOUSING	73	2263450	SCREW-10-24 X 7/8 (2 REQ'D)	130	2265115	BOOT-FOOT PEDAL BASE
17	406461	SEAL	74	2260265	COVER-CTR BOX	131	2262113	SCREW-8-18 X 1/2FT.PDL (2 REQ'D)
18	406471	SEAL-W/CUP	75	2372100	SCREW-8-18 X 1/2 (4 REQ'D)	132	2261900	BRACKET-CONDUIT
19	405462	O-RING THRU BOLT (2 REQ'D)	76	2265519	DECAL-COVER 50AT	133	2301310	SCREW-8-18 X 1/2 (2 REQ'D)
20	408353	THRU BOLT (2 REQ'D)	77	2260150	POINTER DISC TRNSLCNT RED	134	2263210	BRACKET-CONDUIT ADJUST
21	2099030	MOTOR ASSEMBLY	78	2265800	DECAL-INDICATOR	135	2202720	SPRING-CONDUIT
22	2032063	TUBE COMP W/CSK HOLE	79	2262530	CONTROL BOX-PLASTIC	136	2263460	SCREW-1/4-20 X 2
23	2091150	PROPELLER (W.WEDGE)	80	2262109	SCREW-8-32 X 1/2 (3 REQ'D)	137	2261224	LEADWIRE-W/WRING TERM.
24	2051700	LOCKWASHER-PROP (MEDIUM)	81	2267800	GEAR-INDICATOR (3 REQ'D)	138	2020700	TERMINAL RING, 3/8 (2 REQ'D)
25	2053100	NUT-PROP (MEDIUM)	82	2262220	INDICATOR-DRIVE	139	2263201	CLAMP WIRE HARNESS MICO
26	2092600	PIN-DRIVE	83	2261905	BRACKET-INDICATOR	140	2332103	CLAMP-WIRE HARNESS
27	2991987	BOWGUARD 360 ASSY FW	84	2301310	SCREW-8-18 X 1/2	141	2260301	SCREW-8-20 X 3/8 (2 REQ'D)
28	2264201	ARM-UPPER FW/STD,BWGRD	85	2263201	CLAMP WIRE HARNESS MICRO	142	2260311	CONNECTING WIRE (SWITCH)
29	2265120	BUMPER (UPPER ARM)	86	2301310	SCREW-8-18 X 1/2	143	2260320	CONNECTING WIRE 19 1/4
30	2254345	ARM-LWR FW	87	2355410	SHRINK TUBE-3/8 (2 REQ'D)	144	2266411	CONNECTING WIRE-12
31	2263900	MOTOR REST	88	2232360	PULLEY-CABLE DRUM	145	2332103	COVER PLATE
32	2251942	BOW PLATE	89	2281730	WASHER-NYLON	146	2994803	SCREW-8-20 X 3/8 (8 REQ'D)
33	2293801	TUBE LOCK	*90	2267805	PINION DRIVE	147	2153501	BAG ASSY-(BOLTS,NUTS,WASHERS)
34	2260508	HINGE-PIN (HEADLESS)	*91	2266248	TOP BEARING RACE	*148	2151728	BOLT-MOUNTING- (4 REQ'D)
35	2150400	PULL-GRIP	92	2263410	SCREW-8-32 X 5/16	*149	2151728	WASHER-5/16 (4 REQ'D)
36	2236000	BEARING NYLINER (2 REQ'D)	93	2992020	FOOT PEDAL ASSY	*150	2153100	NUT-5/16-MOUNTING (4 REQ'D)
37	2303431	SCREW 1/4-20X5/8 (4 REQ'D)	*94	2790002	FOOT PEDAL/PLUG ASSY	*151	2301720	WASHER-RUBBER (6 REQ'D)
38	2293511	BOLT-UPPER ARM (2 REQ'D)	95	2263700	PUSH-BUTTON FOOT PEDAL	152	2266610	DECAL-ON/OFF SWITCH
39	2293500	BUSHING-SHOULDER (4 REQ'D)	96	2302732	SPRING-LOWER PEDAL			
40	2152810	SPRING-PIN (LOOKBAR)	97	2264020	SWITCH MOMENTARY			
41	2233600	LOCK BAR- (BOW MOUNT)	98	2265140	BOOT-MICROSWITCH			
42	2152700	SPRING-(LOCKBAR)	*99	2262114	SCREW-MOUNTING/SWITCH (2 REQ'D)			
43	2151700	WASHER-EYE SHAFT (2 REQ'D)	100	2233100	NUT-SWITCH MOUNT (2 REQ'D)			
44	2153600	EYE SHAFT	101	2284028	SWITCH-5 SPEED			
45	2261921	BRACKET BASE-LEFT	102	2281701	LOCKWASHER-STAR			
46	2261931	BRACKET BASE-RGHT	103	2283105	NUT-HEX			
47	2261530	SPRING SLEEVE LWR	104	2281715	SPACER-SWITCH			
48	2261520	SPRING-SLEEVE UPPER	105	2260170	KNOB-SPEED CONTROL			
49	2262701	SPRING-BREAKAWAY	106	2283000	E-RING			
50	2267300	BUSHING-DOWEL (2 REQ'D)	107	2260730	CONNECTOR 1/4 MALE TAB			
51	2260530	HINGE PIN-LOWER	108	2332103	SCREW-6-20 X 3/8			
52	2260520	HINGE PIN-UPPER	109	2284550	FOOT PEDAL BASE,			
53	2262310	GUIDE-ROPE	*110	2266413	TENSION SCREW-PLATE			
54	2263010	E-RING 3/8 DIA. SHAFT (4 REQ'D)	111	2282650	PIN, CIRCUIT BREAKER			
55	2263470	SCREW-1/4-20 X 1-3/4 (4 REQ'D)	112	2262721	SPRING, RESET PIN			
56	2262800	TENSION BLOCK	113	2260511	PIN-PIVOT			
57	2011385	SCREW-TENSION KNOB	114	2260515	PIN-PULLEY-AXLE			

PARTS LIST

SOA/T

This item is part of an assembly. This item cannot be sold separately due to machining and /or assembly that is required.

