

36AT
36 lbs Thrust
12 volt

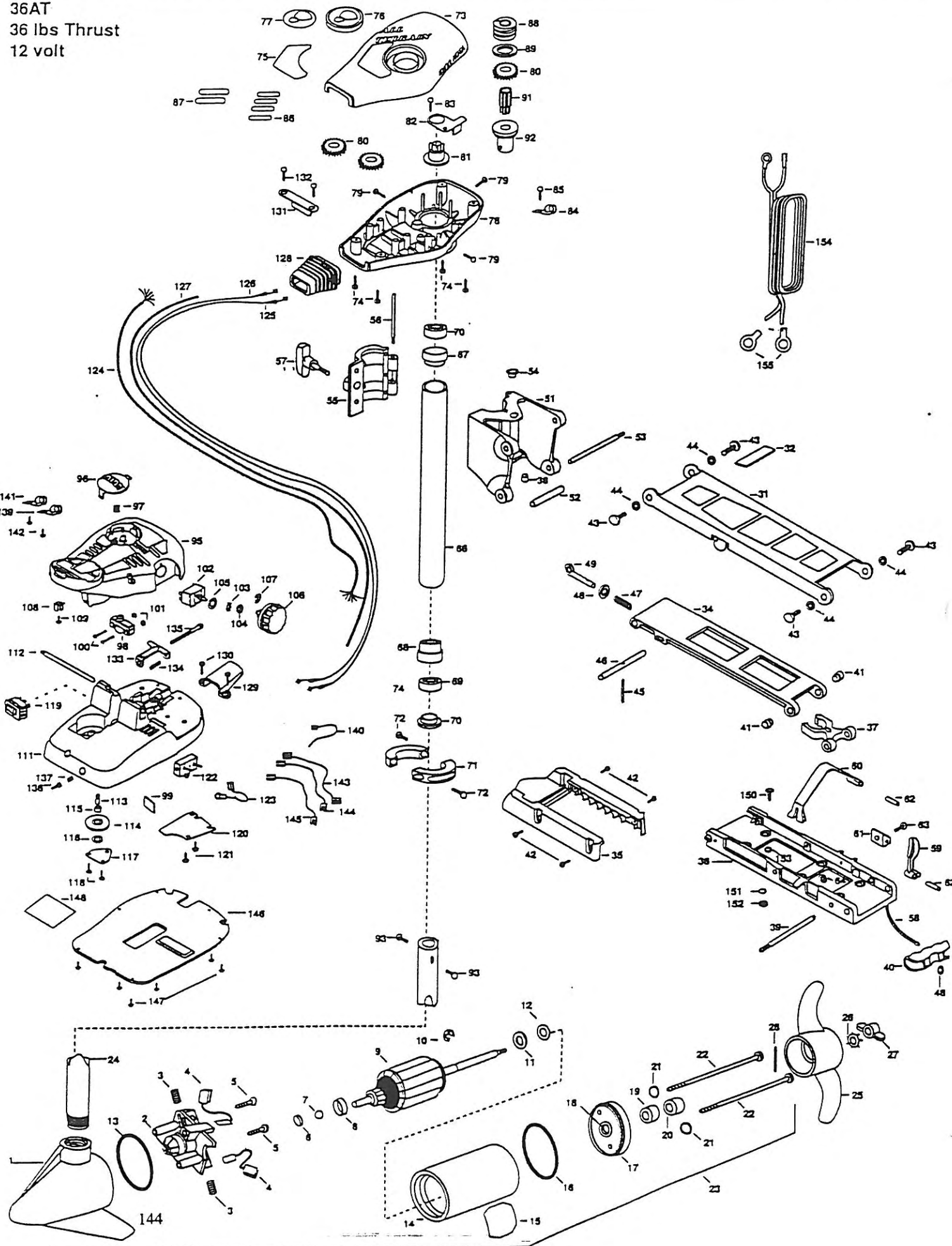

ordering parts. Please use the correct part numbers from the parts list. Payment for any parts ordered from MINN KOTA parts department, may be by cash, personal check, Discover Card, MasterCard or VISA. For more information, call 1-800-227-8433 or FAX 1-800-527-4464.

ne pas oublier de fournir les numéros de Modèle et de Série de votre Moteur lorsque vous placez une commande. Employez toujours le numéro de pièce exact se trouvant sur la liste des pièces de remplacement.

Não deixe de incluir o número do MODELO e o número da SÉRIE do seu motor ao pedir peças. Sem estes números corretos das peças da lista de peças de reposição, não poderá ser feita a entrega autorizada MINN KOTA.

1	406027	BRUSH END HOUSING	58	2251600	ROPE- 31"	115	2260000	BEARING- PULLEY
2	406406	BRUSH PLATE ASSEMBLY	59	2287200	LATCH LEVER	116	2261705	WASHER- NYLATRON
3	406084	BRUSH SPRING (2 REQ'D)	60	2283800	STRAP- HOLD DOWN	117	2268400	COVER- PULLEY
4	406074	BRUSH ASSEMBLY (2 REQ'D)	61	2261910	BRACKET- HOLD DOWN STRAP	118	2301310	SCREW- 8-18 X 1/2" (2 REQ'D)
5	406341	BRUSH PLATE SCREW (2 REQ'D)	62	2260500	PIN- ROLL LATCH LEVER (2 REQ'D)	119	2254031	SWITCH- MOM/OFF/CON
6	403050	THRUST DISC	63	2263440	SCREW- 10-24 X 3/4"	120	2268412	SWITCH PLATE
7	403010	BALL	64	2333101	NUT- HEX	121	2332103	SCREW- 6-20 X 3/8 (2 REQ'D)
8	406090	BRUSH HOLDER	65	2992015	TUBE W/BEARING RACE ASSEMBLY 18"	122	2268200	CIRCUIT BREAKER- 30AMP
9	405205	ARMATURE ASSEMBLY	66	2272068	TUBE OUTER- 18" ORDER 68	123	2260601	WIRE CONNECTING- 10GA.
10	405300	E-RING	67	2266260	BEARING- RACE	124	2261207	WIRE HARNESS 5'
11	406170	THRUST WASHER- STEEL (AS REQ'D)	68	2266220	BEARING- RACE STEEL	125	2267500	CABLE ASSEMBLY- RIGHT 5'
12	405171	THRUST WASHER- NYLON (AS REQ'D)	69	2266000	BEARING BALL- STEEL (2 REQ'D)	126	2267510	CABLE ASSEMBLY- LEFT 5'
13	403460	O-RING	70	2268115	BEARING CONE	127	2265430	CABLE JACKET 5'
14	405259	CENTER SECTION W/ MAGNETS	71	2281815	COLLAR (2 REQ'D)	128	2265110	BOOT- CONTROL BOX
15	2006609	DECAL- MOTOR	72	2283450	SCREW- 10-24 X 7/8" (2 REQ'D)	129	2265115	BOOT- FOOT PEDAL BASE
16	406460	O-RING	73	2260264	COVER- CONTROL BOX	130	2262113	SCREW- 8-18 X 1/2" (2 REQ'D)
17	406035	PLAIN END HOUSING	74	2372100	SCREW- 8-18 X 5/8" (4 REQ'D)	131	2261900	BRACKET- CONDUIT
18	406600	FLANGE BEARING (SERVICE ONLY)	75	2265525	DECAL- COVER	132	2301310	SCREW- 8-18 X 1/2" (2 REQ'D)
19	406481	SEAL	76	2260150	POINTER DISC TRANSLUCENT RED	133	2263210	BRACKET- CONDUIT ADJUSTMENT
20	406471	SEAL- CUP	77	2265800	DECAL- INDICATOR	134	2262720	SPRING- CONDUIT
21	401462	O-RING- THRU BOLT (2 REQ'D)	78	2262530	CONTROL BOX	135	2263460	SCREW- 1/4-20 X 2"
22	405352	THRU BOLT (2 REQ'D)	79	2262109	SCREW- 8-32 X 1/2" (3 REQ'D)	136	2262650	PIN- CIRCUIT BREAKER RESET
23	2069041	MOTOR- ASSEMBLY	80	2267800	GEAR- INDICATOR (3 REQ'D)	137	2262721	SPRING- RESET PIN
24	2032062	TUBE- COMPOSITE 36"	81	2262220	INDICATOR- DRIVE	139	2283200	CLAMP-WIRE HARNESS
	2032063	TUBE- COMPOSITE 42"	82	2281905	BRACKET/INDICATOR	140	2256300	TIE WRAP- 5.5" BLACK
25	2061125	PROP- WEEDLESS WEDGE	83	2301310	SCREW- 8-18 X 1/2"	141	2263201	CLAMP- WIRE HARNESS
26	2051700	LOCKWASHER- PROP	84	2263201	CLAMP- WIRE HARNESS	142	2332103	SCREW- 6-20 X 3/8 (2 REQ'D)
27	2053100	NUT- PROP	85	2301310	SCREW- 8-18 X 1/2"	143	2260301	CONNECTING WIRE- SWITCH
28	2092600	PIN- DRIVE	86	2375400	SHRINK TUBE- 1/4 OD X 1-3/4" (4 REQ'D)	144	2260311	CONNECTING WIRE- 19-1/4
29	2881954	STD- BOWMOUNT ASSEMBLY	87	2355410	SHRINK TUBE- 3/8 OD X 2" (2 REQ'D)	145	2260320	CONNECTING WIRE- 12"
30	2264201	ARM- UPPER	88	2232360	PULLEY- CABLE DRUM	146	2266411	COVER PLATE
31	2265120	BUMPER- UPPER ARM	89	2281730	WASHER- NYLON	147	2332103	SCREW- 6-20 X 3/8" (6 REQ'D)
32	2774310	ARM- LOWER ASSEMBLY	90	2776203	TOP BEARING RACE ASSEMBLY INCLUDES 91,92	148	2265608	DECAL
33	2254342	ARM- LOWER— ORDER 33 -INCL 34,40,45,46	*91	2287805	PINION DRIVE	149	2994803	BAG ASSEMBLY (INCLUDES 150-153)
34	2263900	MOTOR REST	*92	2266245	BEARING RACE- TOP	*150	2153501	BOLT-MOUNTING ORDER (4 REQ'D)
35	2251942	BOW PLATE	93	2263410	SCREW- 8-32 X 5/16" (2 REQ'D)	*151	2151728	WASHER- 5/16" ORDER (4 REQ'D)
36	2293801	TUBE LOCK	*94	2992020	FOOT PEDAL ASSEMBLY- 5 SPEED	*152	2153100	NUT- 5/16" MOUNTING (4 REQ'D)
*38	2264705	INSERT- HINGE BASE	95	2790002	FOOT PEDAL- PLUG ASSEMBLY	*153	2301720	WASHER- RUBBER (6 REQ'D)
39	2260506	HINGE- PIN	96	2263700	PUSH BUTTON- FOOT PEDAL	154	2261224	LEADWIRE- W/ RING TERMINALS
40	2150400	PULL- GRIP	97	2302732	SPRING- LOWER PEDAL	155	2090700	RING TERMINALS (2 REQ'D)
41	2236000	BEARING NYLINER (2 REQ'D)	98	2284020	SWITCH- MOMENTARY			
42	2303431	SCREW- 1/4-20 X 5/8" (4 REQ'D)	*99	2268413	PLATE- TENSION SCREW			
43	2293511	BOLT- UPPER ARM (4 REQ'D)	100	2282114	SCREW- MOUNTING SWITCH (2 REQ'D)			
44	2293500	BUSHING- SHOULDER UPPER ARM (4 REQ'D)	101	2233100	NUT- SWITCH MOUNT (2 REQ'D)			
45	2152610	SPRING- PIN LOCKBAR	102	2284028	SWITCH- 5 SPEED			
46	2233600	LOCK BAR- BOW MOUNT	103	2281701	LOCKWASHER- STAR			
47	2152700	SPRING- LOCKBAR	104	2263105	NUT- HEX			
48	2151700	WASHER- EYE SHAFT (2 REQ'D)	105	2261715	SPACER- SWITCH 5 SP MODELS			
49	2153600	EYE SHAFT	106	2260170	KNOB- SPEED CONTROL 5 SPEED			
50	2771812	HINGE BASE ASSEMBLY- INCLUDES 38,51,54	107	2263000	E-RING			
*51	2261811	HINGE BASE- ORDER 50	108	2260730	CONNECTOR- 1/4 MALE			
52	2231570	SLEEVE ROLLER	109	2332103	SCREW- 6-20 X 3/8"			
*53	2230500	PIN-HINGE (BOW PLATE)	110	2774550	FT PEDAL BASE ASSEMBLY INCLUDES 111,113			
*54	2232350	EYELET-ROPE	*111	2284500	FOOT PEDAL BASE			
55	2261821	HINGE DOOR	112	2260511	PIN- PIVOT FOOT PEDAL			
56	2282640	PIN-HINGE DOOR	*113	2260515	PIN- PULLEY- AXLE			
57	2260180	KNOB- HINGE COVER	114	2262300	PULLEY- FOOT PEDAL			

* This item is part of an assembly. This item cannot be sold separately due to machining and/or assembly that is required.

PARTS LIST

36 AT

