

REV	DESCRIPTION	DATE	APPROVE
P1	PRELIMINARY	13/12/04	YJW

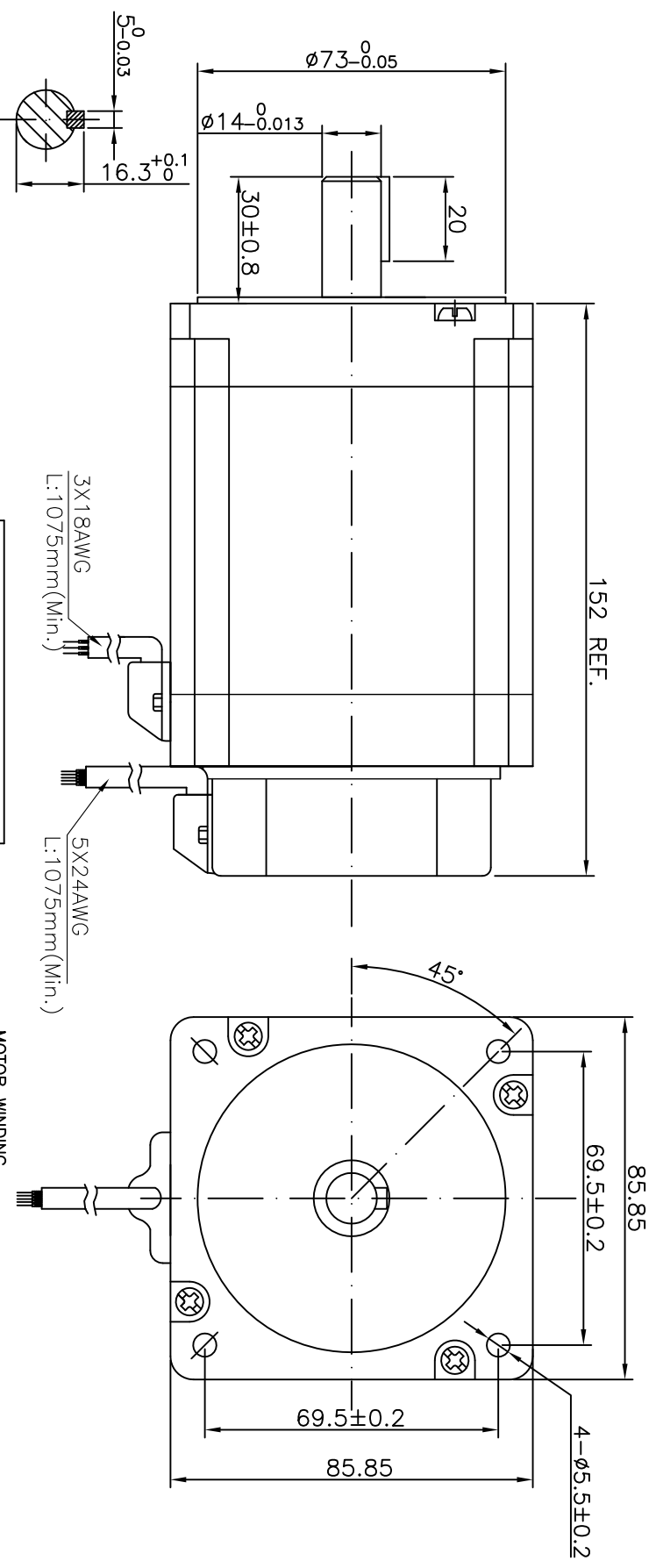

Motor Specification	
Resistance	TBD Ohms $\pm 10\%$
Inductance	TBD mH $\pm 20\%$
Voltage	230 VDC
Rated power	660W
Rated Speed	3000 rpm
Rated Current	3.8 A
Rated Torque	2.1Nm
Peak Current	11.4 A
Peak Torque	6.3 Nm
Ke	41 V/Krpm
Rotor Inertia	2.4 Kg.cm ²
Number of Poles	8
Insulation Class	B
Weight	4.0 Kg

TIMING DIAGRAM							
ELECTRICAL DEGREES	°	60°	120°	180°	240°	300°	360°
HALL A							
HALL B							
HALL C							
PHASE R-S							
PHASE S-T							
PHASE T-R							

ROTATION: CLOCKWISE AS VIEWED FROM SHAFT END.

MOTOR WINDING CONFIGURATION

PHASE S GRN PHASE R YEL

PHASE T BLU

8 POLE AS VIEWED OPPOSITE LEAD END

CONNECTION CHART	
SENSOR	MOTOR
YELLOW	YELLOW
GREEN	GREEN
BLUE	BLUE
YELLOW	YELLOW
GREEN	GREEN
BLUE	BLUE
RED	RED
BLACK	BLACK
	4.5 -24 VDC
	GROUND

NOTE: THIS DRAWING HAS BEEN CREATED BY AUTOCAD. MANUAL REVISIONS ARE NOT ALLOWED.

MATERIAL		TOLERANCE UNLESS OTHERWISE SPECIFIED	
		ISO 2768-1 MEDIUM	
DRAWN	CHECKED	APPROVED - DATE	SCALE
			N/A

Exmex

BRUSHLESS D.C. MOTOR

ME086AS3XX

SHEET 1/1

THIS DRAWING AND THE INFORMATION DISCLOSED HEREIN ARE PROPRIETARY DATA OF EXMEX ELECTRIC, INC. IT IS TO BE IMMEDIATELY RETURNED UPON REQUEST. REPRODUCTION OF THIS DRAWING OR THE INFORMATION DISCLOSED HEREIN IS PROHIBITED WITHOUT THE EXPRESS WRITTEN APPROVAL OF EXMEX.