

- NOTES:
1. HI-POT: 1800VAC/1S, 2mA
 2. SUPPLY THE KEY WITH MOTOR TAPED ON THE SHAFT

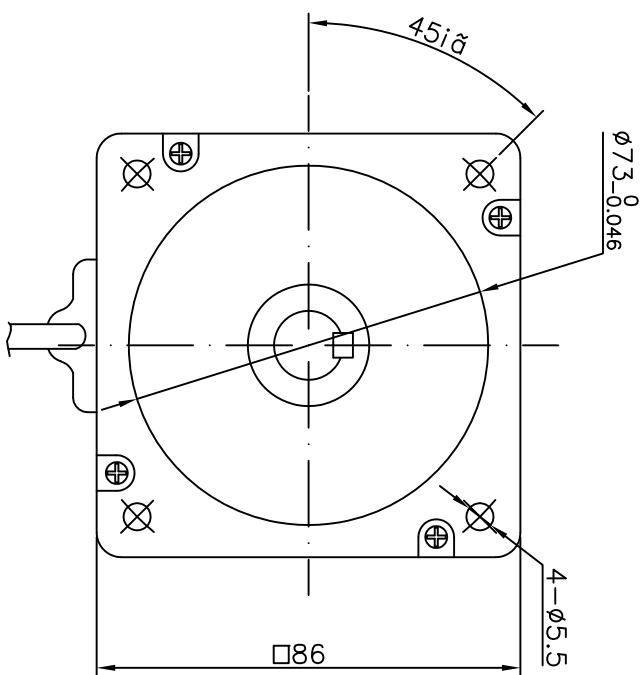
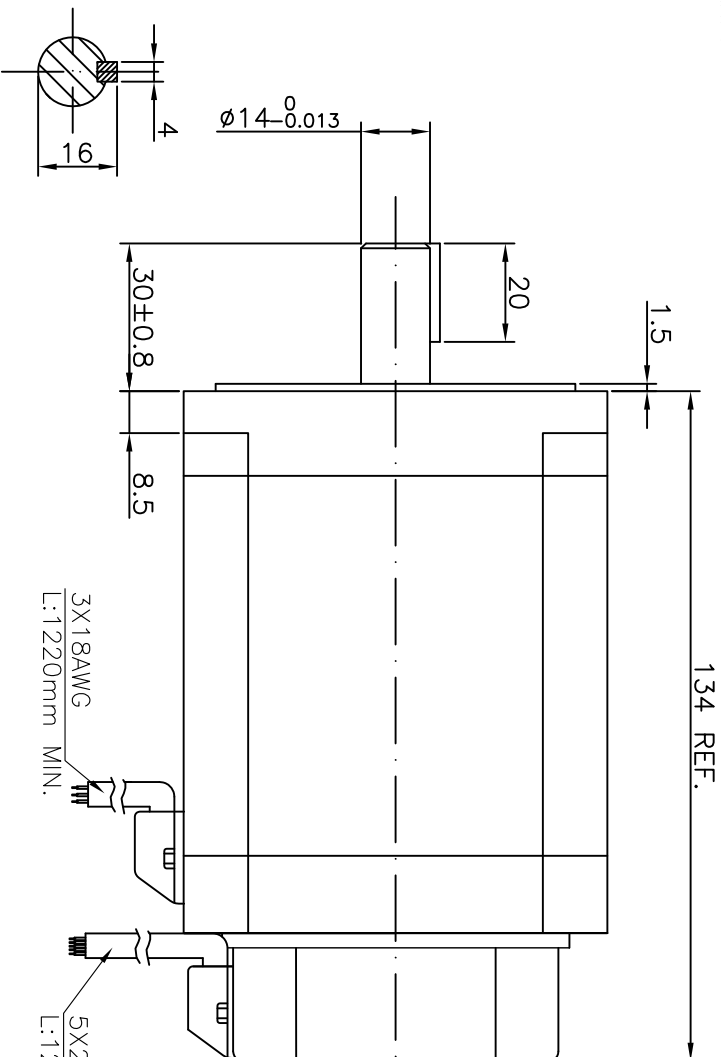

Motor Specification	
Resistance	5 Ohm \pm 10%
Inductance	18 mH \pm 20%
Voltage	310 VDC
Kt	TBD N.m/A
Ke	85 V/Krpm \pm 1V
Load Current	1.65 A
Unload Speed	TBD rpm
Torque	1.4 Nm
Load Speed	3000rpm
Power	440 W
Weight	2.6kg
No. of poles	8

TIMING DIAGRAM

ELECTRICAL DEGREES	60°	120°	180°	240°	300°	360°
HALL A						
HALL B						
HALL C						
PHASE R-S						
PHASE S-T						
PHASE T-R						

ROTATION: CLOCKWISE AS VIEWED FROM SHAFT END.

MOTOR WINDING CONFIGURATION

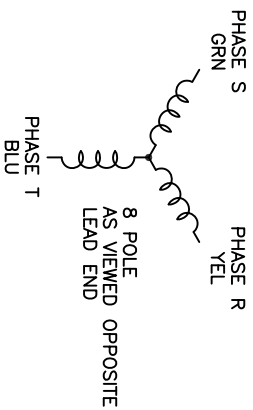

CONNECTION CHART

SENSOR	MOTOR	COLOR	FUNCTION
YELLOW	YELLOW	YELLOW	PHASE R
GREEN	GREEN	GREEN	PHASE S
BLUE	BLUE	BLUE	PHASE T
YELLOW	YELLOW	YELLOW	HALL A
GREEN	GREEN	GREEN	HALL B
BLUE	BLUE	BLUE	HALL C
RED	RED	RED	4.5 -24 VDC
BLACK	BLACK	BLACK	GROUND

NOTE: THIS DRAWING HAS BEEN CREATED BY AUTOCAD. MANUAL REVISIONS ARE NOT ALLOWED.

MATERIAL

TOLERANCE UNLESS OTHERWISE SPECIFIED
ISO 2768-1 MEDIUM

DRAWN	CHECKED	APPROVED	DATE	FILENAME	DATE	SCALE
xxx					xx/xx/xx	N/A

DC SERVER MOTOR

Exmex

ME086AS213

SHEET
1/1

REV	DESCRIPTION	DATE	APPROVE
P1	PRELIMINARY	14/03/14	YJW