

USB Charger Installation Instructions



Thank you for choosing the Double Apex USB Charger! If you have any questions about the installation please do not hesitate to email us at support@doubleapex.co or call 978-371-8585. A PDF version of these instructions can be found on the product page at doubleapex.co

Parts Included:

A - USB Port (x1)

B - PassThrough harness (x1)

C - Charger harness (x1)

D - T20 Torx key (x1)

E - Posi-Tap wire tap (x1)

F - Velcro tape (not shown)

Please Note: These instructions are based on a VW MK5 GTI. Your vehicle may be slightly different. If you encounter a substantial difference in the install procedure, we could use your help. If possible please document it with clear photos and contact us. If we use your information you'll receive a store credit towards a future purchase.

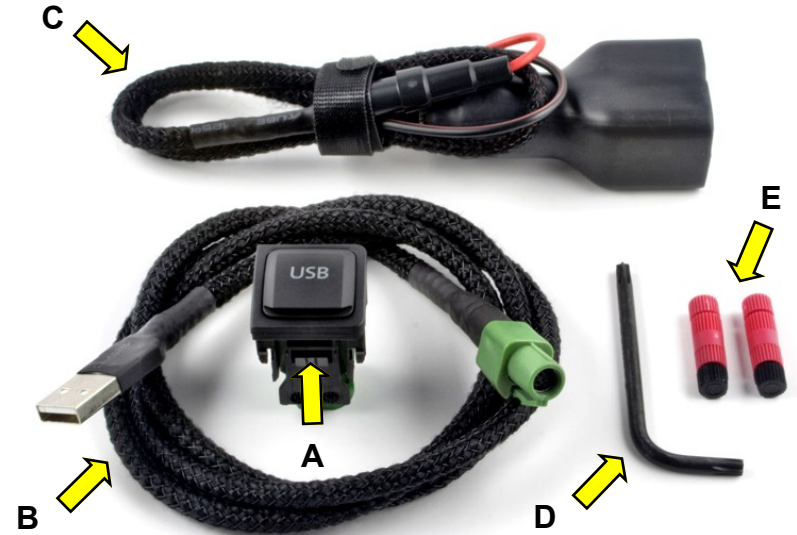

Step 1:

Move the shift lever to the rearmost position.

Use a plastic trim removal tool to detach the trim surrounding the shifter (arrow A).

It may also be possible to grasp the edges of the trim surrounding the shifter, where it meets the shift boot, and pull straight up to detach.

Pull it up and out of the way to expose the Torx screws shown in the next step.



Step 2:

Using the included T20 Torx bit remove the two screws at the front of the button cluster. Be careful not to let the screws fall into the shifter recess. Set the screws aside in a safe place.

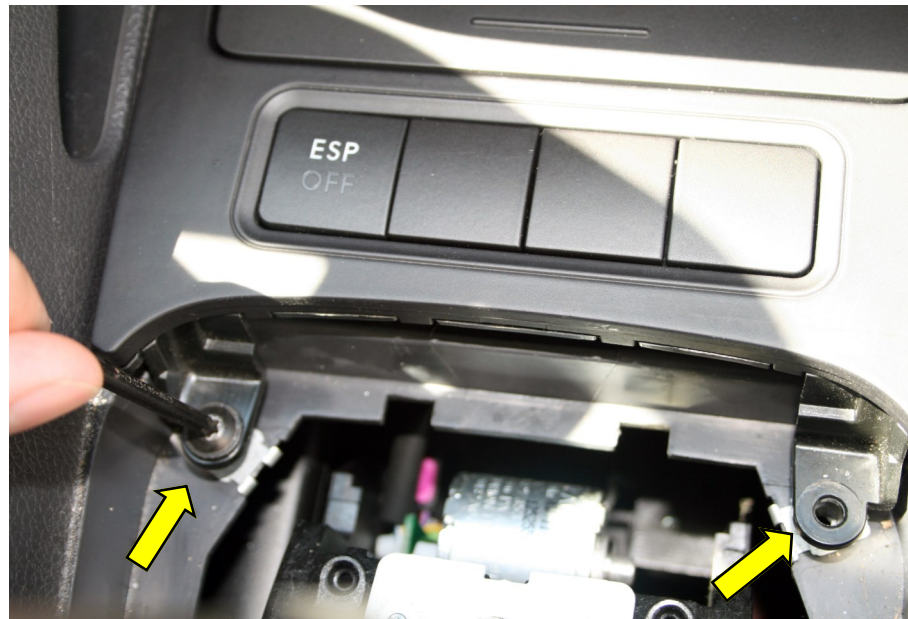

Step 3:

Lift up the front of the button cluster enough to expose the connectors below. **Make sure the key is in the off position.**

1. Disconnect the ESP and any other button harnesses by depressing the tab on the left side of the connector and pulling downward. Put some downward pressure on the button top while doing so to prevent it from moving upward and possibly dislodging its retaining clips.
2. Detach the harness support if equipped. You may want to pry it loose with a small flat head screw driver.
3. Disconnect the 12v power socket by depressing the tab on the connector and pulling downward. On models with the socket on the left, the tab is on the back side.
4. If equipped disconnect the audio input connector by depressing the tab, circled in yellow, with a small screw driver.

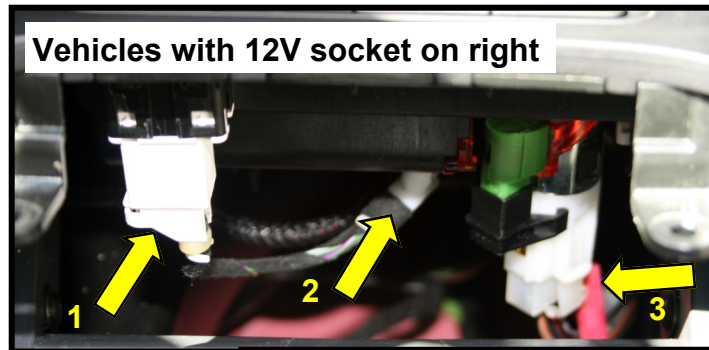

Step 4:

Pull the center tray assembly up and outward from its recess and set it aside for now.

Plug the USB end of the PassThrough cable into the charger harness. Use port APP if you will be charging Apple devices, port UNI for other brand devices.

If you'll be charging Apple and Non-Apple devices please note:

Apple devices can be charged using port UNI but may charge at a slightly slower rate. Port APP may not be compatible with some non-Apple devices and could charge others at a slower rate.

If you plan to use port APP with a non-Apple device we recommend first connecting the charger to power (Step 6) and testing the compatibility with your device by plugging it directly into charger port APP.



Step 5:

Using the included Velcro tape, secure the charger to the left side wall inside the recess as shown.



Step 6:

Make sure the key is in the off position when connecting power.

Connect the charger leads to the 12V socket harness using the included Posi-Taps.

The red wire on the charger harness gets connected to the red and black 12V wire and the red / brown wire gets connected to the brown 12V wire.

Make sure no bare wire is visible outside of the Posi-Taps.

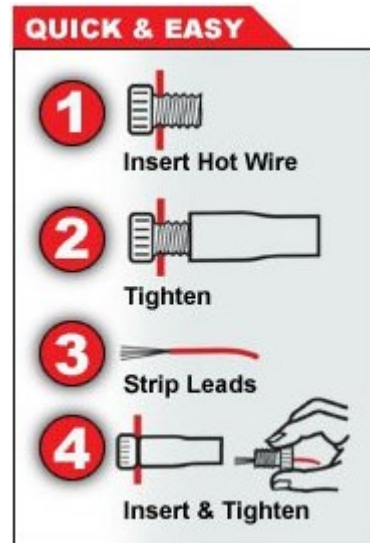
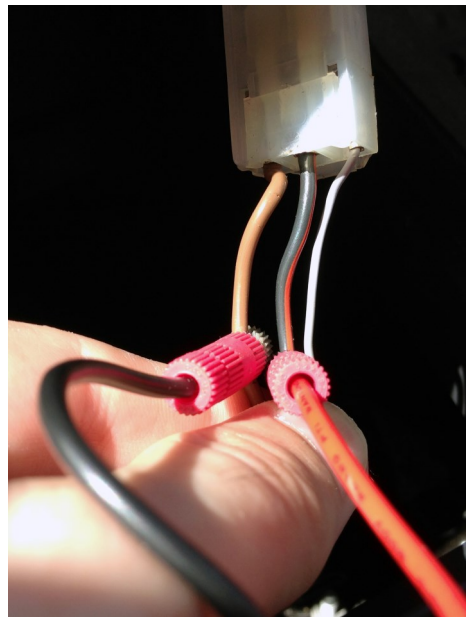

Step 7:

Coil up the PassThrough harness and secure it to the fuse holder and Charger harness using the included Velcro strap (at arrow 1).

Leave some slack on the green end of the PassThrough harness as this will be connected to the USB port.

Position the coiled harness down in the recess to the right of the black HVAC tunnel. (marked in the photo with the green dots, may be covered in some vehicles). If the harness coil is on top of the tunnel the center tray assembly may not install properly.

Make sure the button and 12v socket harness are not entangled with the Charger harnesses.



Step 8:

Remove the end blank from the button cluster by pushing it out from the underside.

Snap the USB Port into the open position from the top side.

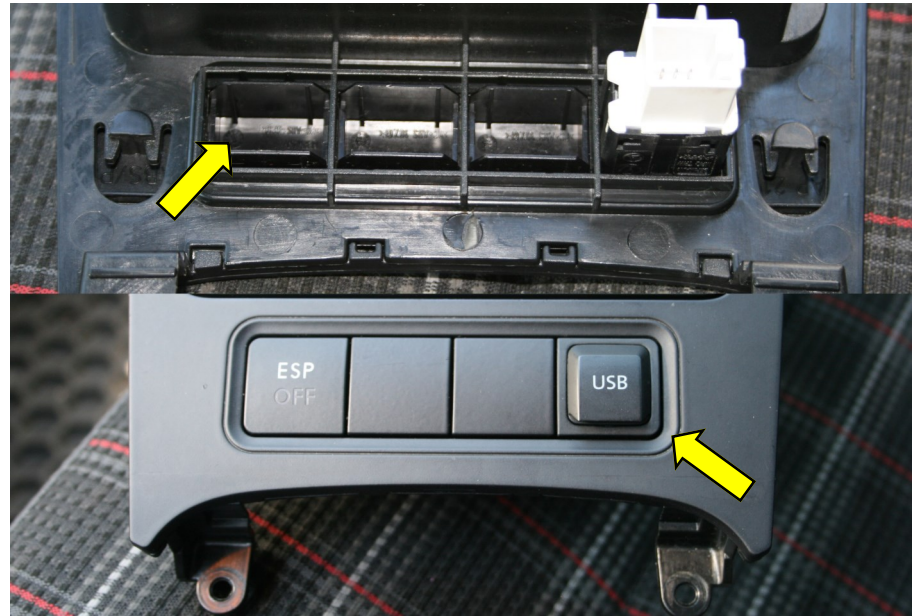

Step 9:

Align the back side of the center tray assembly with the back of the recess and then reconnect the harness support if equipped (1), the button harness (2), the 12v socket (3), the audio input, if equipped (not shown), and connect the green connector to the USB Port (4).

Carefully lower the tray assembly until it is flush and re-secure it with the original Torx screws. If the tray does not sit flush the Charger harnesses may not be sitting low enough in the recess.



Step 10:

Snap the shifter surround trim back in place and the installation is complete!

To charge your device simply plug its USB cable into the port when your key is in the on position.

In the future if you'd like to connect the Port to another USB device, simply remove the charger harness and connect the PassThrough cable where needed.



Thank You!

Thank you again for choosing the Double Apex USB Charger. We believe in continuous improvement so until our products install themselves and respond to telepathic commands there's probably something we could do better. All feedback is appreciated. If you have comments or questions please don't hesitate to contact us at support@doubleapex.co or visit us at doubleapex.co.

Limited Warranty

Double Apex LLC warrants this product, USB Charger, to be free from defects in materials and workmanship for one year from date of purchase to the original retail Purchaser.

Double Apex LLC reserves the right to repair or replace the defective product at their discretion, without charge. This is the only remedy the purchaser has for any loss or damage due to any defect in the product. This warranty does not cover labor, lost profits, down time or loss of use, shipping costs, damage to the vehicle or other incidental, indirect or consequential damages.

This warranty is void if the product is misused, abused or installed incorrectly.

The Purchaser is responsible for ensuring that the product is installed correctly and should immediately stop use of the product if an improper or unsafe condition is observed.

Please contact Double Apex LLC to make a warranty claim before returning the product.



www.doubleapex.co

email: support@doubleapex.co