

iDivide™ your space...

Modern Designer Room Divider Wall Systems

iDivide™ Designer Room Divider Walls are a unique and dynamic alternative to standard divider privacy screen partitions. The flexible modular design enables the creation of a variety of configurations. The interchangeable modular infill panels are available in an assortment of colors and finishes.

StudioWall™ is a modular partition wall system that is made of the highest quality sturdy clear anodized aluminum frames. All iDivide™ Room Dividers and Partition Walls are an easy to assemble do-it-yourself system. The frames can be custom factory painted in a variety of colors.



Design and Product Guide

Contents	Page
Overview & Specifications	2
Modular Wall Sizes	3 - 15
Custom Designs	16
Material & Color Options	19-20
Rolling Doors	21
Wall Accessories	22
Design Idea Gallery	23 - 24

Office Workspace and Home Living Applications

iDivideWalls.com™

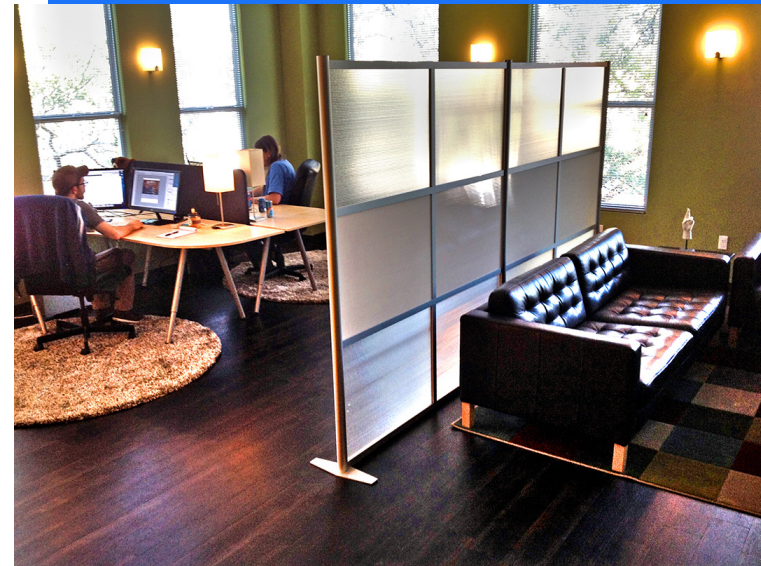

iDivide LLC

Modern Designer Room Divider Wall Systems
212.721.1900
info@iDivideWalls.com

Made in the USA

StudioWall™ Modern Room Dividers



iDivide™ Flexible Modular System

Overview



Specifications

Modular Sizes

Widths 27", 35", 51", 60", 68", 75", 84", 100"
Heights 51", 58", 75"

Frame Finishes

Clear anodized aluminum.
Custom powder coat paint finishes available.

Panels

.25" thick panels are available in a variety of translucent and opaque materials, wood grain laminate and colors.

Support Bases

3/16" thick steel with powder coat paint.
Custom powder coat paint finishes available.

Frames

2" diameter round vertical support post.
.75" thick by 1.375" high horizontal and vertical panel frames.

Features

- Easy to assemble in just minutes
- Flexible modular system allows for almost any configuration
- Easy to change and re-arrange panels and wall layouts
- Solid sturdy aluminum frames in clear anodized finish
- Custom frame paint colors available in durable finishes
- Made in the USA



Simple Hex Key Wrench Connections for Quick Assembly

iDivideWalls.com™



iDivide LLC

Modern Designer Room Divider Wall Systems
212.721.1900
info@iDivideWalls.com

Made in the USA

StudioWall™ Modern Room Dividers

3 Panel High 6' - 3" Tall

2 Panel High 4' - 3" Tall

Width 27" (2'-3")
Height 75" (6'-3")

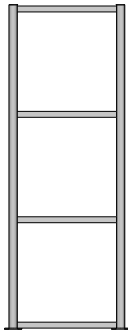

SW2775

Grade 1 \$ 399.
Grade 1A \$ 475.
Grade 2 & 3 (page 19)

Width 35" (2'-11")
Height 75" (6'-3")

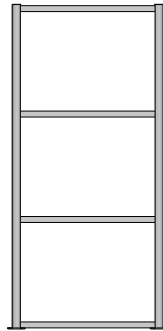

SW3575

Grade 1 \$ 459.
Grade 1A \$ 534.
Grade 2 & 3 (page 19)



Width 68" (5'-8")
Height 75" (6'-3")

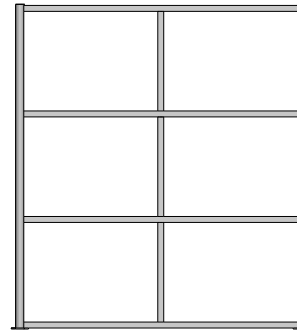

SW6875

Grade 1 \$ 799.
Grade 1A \$ 949.
Grade 2 & 3 (page 19)

Width 27" (2'-3")
Height 51" (4'-3")

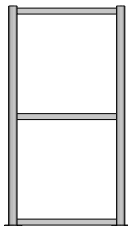

SW2751

Grade 1 \$ 324.
Grade 1A \$ 384.
Grade 2 & 3 (page 19)

Width 35" (2'-11")
Height 51" (4'-3")

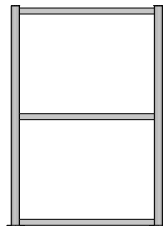

SW3551

Grade 1 \$ 370.
Grade 1A \$ 432.
Grade 2 & 3 (page 19)



Width 68" (5'-8")
Height 51" (4'-3")



SW6851

Grade 1 \$ 639.
Grade 1A \$ 759.
Grade 2 & 3 (page 19)

Details

Frame Options

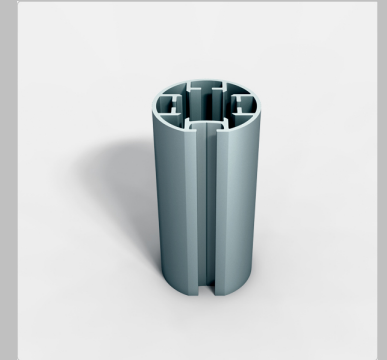

Round Vertical Post

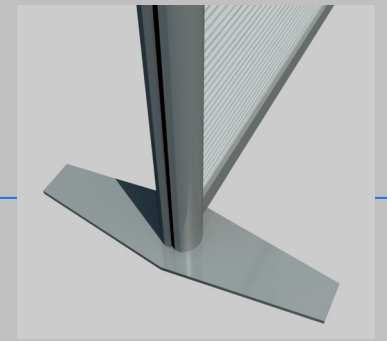

Support Base



SW6875

3 Panel High 6'-3" Tall

Width 101" (8'-5")
Height 75" (6'-3")

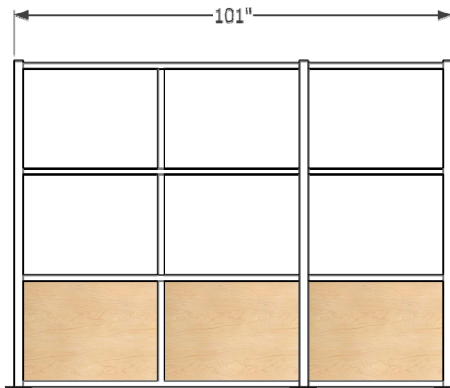

SW10175

Grade 1 \$ 1199.
Grade 1A \$ 1424.
Grade 2 & 3 (page 19)

Width 133" (11'-1")
Height 75" (6'-3")

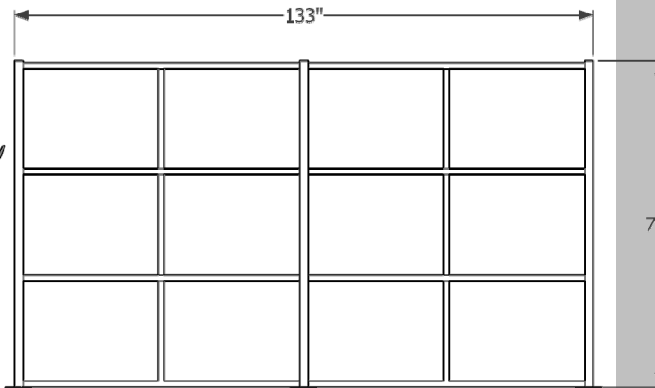

SW13375

Grade 1 \$ 1549.
Grade 1A \$ 1849.
Grade 2 & 3 (page 19)



2 Panel High 4'-3" Tall

Width 101" (8'-5")
Height 51" (4'-3")

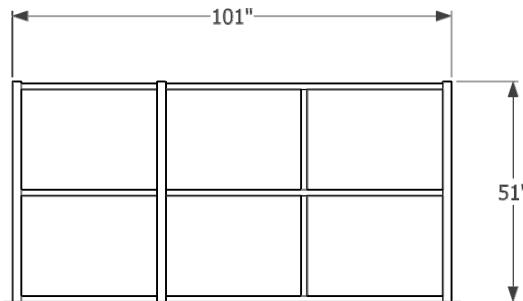

SW10151

Grade 1 \$ 959.
Grade 1A \$ 1139.
Grade 2 & 3 (page 19)

Width 133" (11'-1")
Height 51" (4'-3")

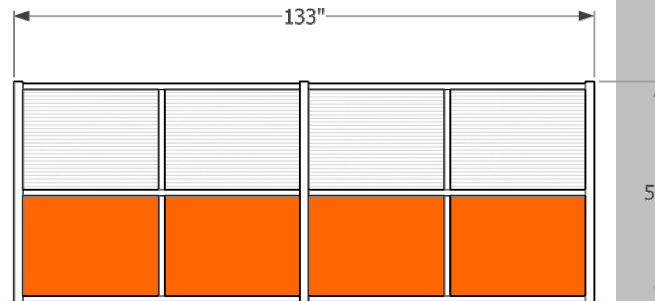

SW13351

Grade 1 \$ 1239.
Grade 1A \$ 1478.
Grade 2 & 3 (page 19)



3 Panel High 6' - 3" Tall

Width 25" (2'-1")
Height 75" (6'-3")



SW2575-ADD
Grade 1 \$ 349.
Grade 1A \$ 419.
Grade 2 & 3 (page 19)

Width 33" (2'-9")
Height 75" (6'-3")

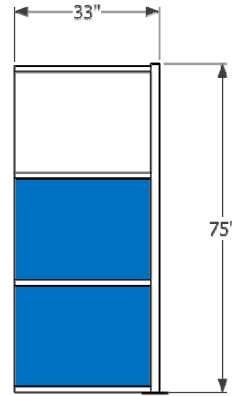

SW3375-ADD
Grade 1 \$ 409.
Grade 1A \$ 484.
Grade 2 & 3 (page 19)



Width 66" (5'-6")
Height 75" (6'-3")

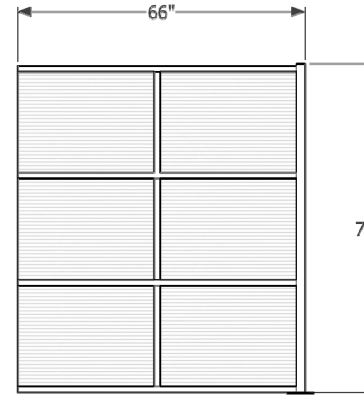

SW6675-ADD
Grade 1 \$ 749.
Grade 1A \$ 899.
Grade 2 & 3 (page 19)

Details

Round Vertical Post Add-on Modules

Connects to a full starter wall section to create a wall that is as long as needed. Add-on modules include only one vertical post that has connection slots on opposite sides.

Square Vertical Post Add-on & Corner Modules

Connects to a full starter wall section to create a wall that is as long as needed. The square vertical post is only available with the connection slots on all four sides, so it can be used to connect a straight or 90 degree angle corner return wall.

2 Panel High 4' - 3" Tall

Width 25" (2'-1")
Height 51" (4'-3")

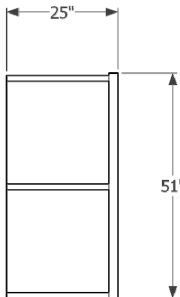

SW2551-ADD
Grade 1 \$ 274.
Grade 1A \$ 334.
Grade 2 & 3 (page 19)

Width 33" (2'-9")
Height 51" (4'-3")

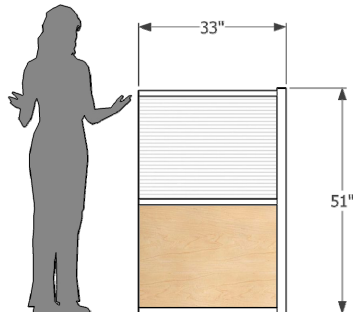

SW3351-ADD
Grade 1 \$ 375.
Grade 1A \$ 425.
Grade 2 & 3 (page 19)

Width 66" (5'-6")
Height 51" (4'-3")

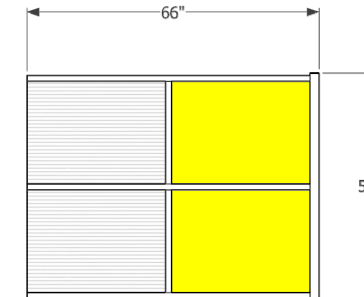

SW6651-ADD
Grade 1 \$ 589.
Grade 1A \$ 709.
Grade 2 & 3 (page 19)



3 Panel High 6' - 3" Tall

Width 25" (2'-1")
Height 75" (6'-3")

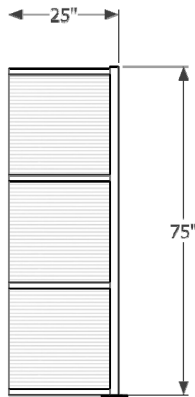

SW2575-CR

Grade 1 \$ 349.
Grade 1A \$ 419.
Grade 2 & 3 (page 19)

Width 33" (2'-9")
Height 75" (6'-3")

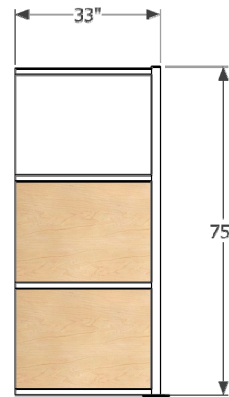

SW3375-CR

Grade 1 \$ 409.
Grade 1A \$ 484.
Grade 2 & 3 (page 19)



Width 66" (5'-6")
Height 75" (6'-3")

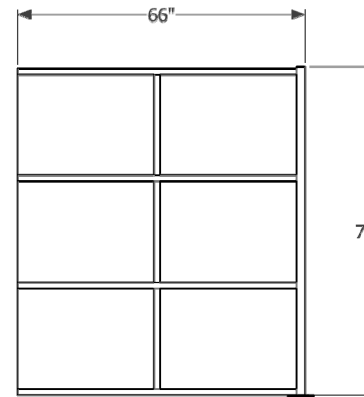

SW6675-CR

Grade 1 \$ 749.
Grade 1A \$ 899.
Grade 2 & 3 (page 19)

Details

Round Vertical Post Corner Modules

Connects to a full starter wall section to create a wall that turns a corner. Corner return modules include only one vertical post that has connection slots on two sides at 90 degrees for a corner connection.

Square Vertical Post Add-on & Corner Modules

Connects to a full starter wall section to create a corner return wall. The square vertical post is only available with the connection slots on all four sides, so it can be used to connect a straight or 90 degree angle corner return wall.

2 Panel High 4' - 3" Tall

Width 25" (2'-9")
Height 51" (4'-3")

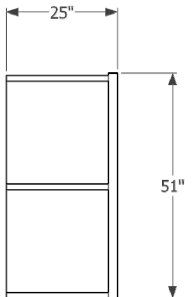

SW2551-CR

Grade 1 \$ 274.
Grade 1A \$ 334.
Grade 2 & 3 (page 19)

Width 33" (2'-9")
Height 51" (4'-3")

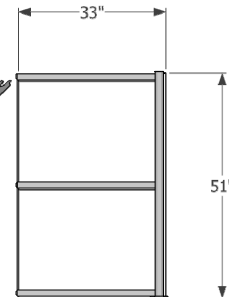

SW3351-CR

Grade 1 \$ 375.
Grade 1A \$ 425.
Grade 2 & 3 (page 19)



Width 66" (5'-6")
Height 51" (4'-3")

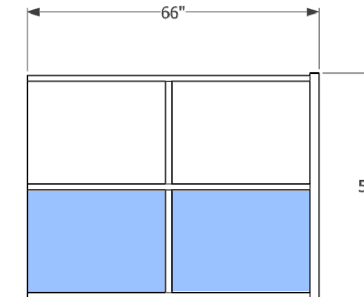

SW6651-CR

Grade 1 \$ 589.
Grade 1A \$ 709.
Grade 2 & 3 (page 19)



3 Panel High 6' - 3" Tall



Width 51" (4'-3")
Height 75" (6'-3")

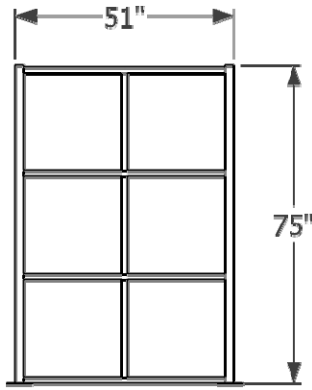

SW5175-1

Grade 1 \$ 749.
Grade 1A \$ 899.
Grade 2 & 3 (page 19)

Width 51" (4'-3")
Height 75" (6'-3")

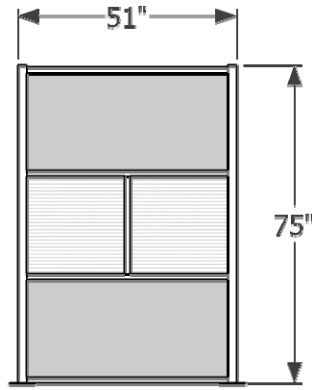

SW5175-2

Grade 1 \$ 729.
Grade 1A \$ 829.
Grade 2 & 3 (page 19)

Width 51" (4'-3")
Height 75" (6'-3")

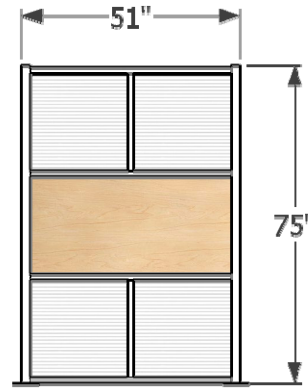

SW5175-3

Grade 1 \$ 739.
Grade 1A \$ 864.
Grade 2 & 3 (page 19)

Width 51" (4'-3")
Height 75" (6'-3")

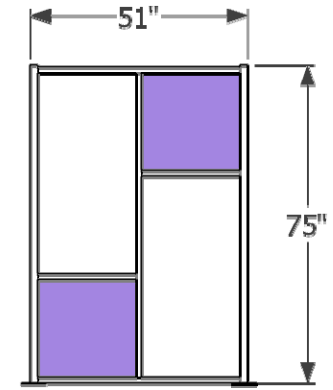

SW5175-4

Grade 1 \$ 729.
Grade 1A \$ 829.
Grade 2 & 3 (page 19)

3 Panel High 6' - 3" Tall

Width 51" (4'-3")
Height 75" (6'-3")

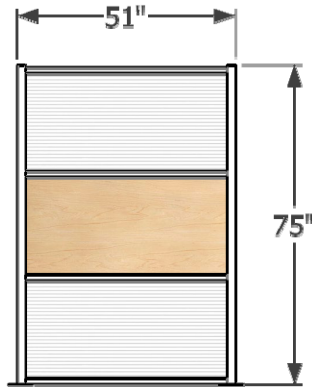

SW5175-5

Grade 1 \$ 699.
Grade 1A \$ 774.
Grade 2 & 3 (page 19)

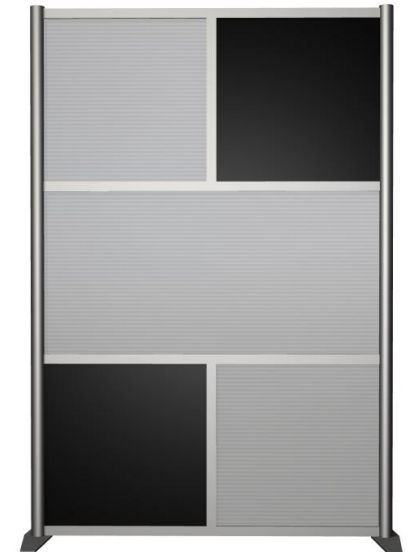
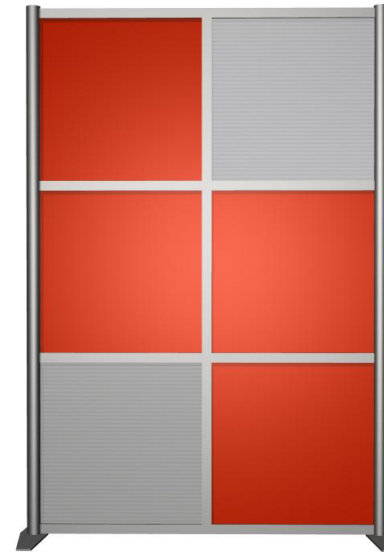
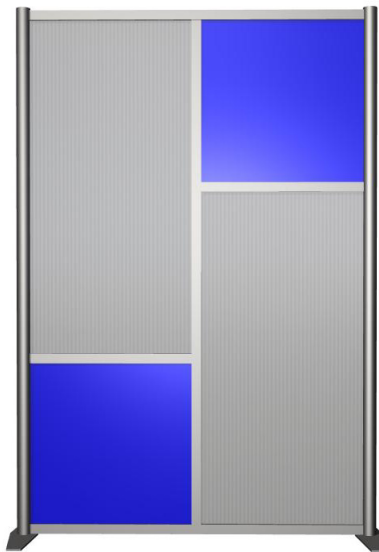

2 Panel High 4' - 3" Tall

Width 51" (4'-3")
Height 51" (4'-3")

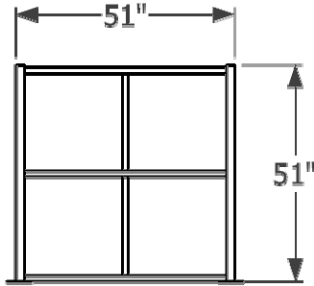

SW5151-1

Grade 1 \$ 599.
Grade 1A \$ 699.
Grade 2 & 3 (page 19)

Width 51" (4'-3")
Height 51" (4'-3")

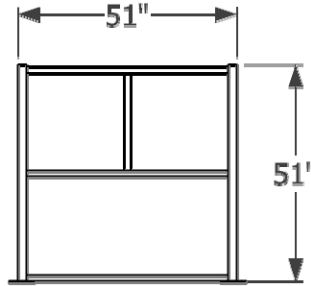

SW5151-2

Grade 1 \$ 599.
Grade 1A \$ 674.
Grade 2 & 3 (page 19)

Width 51" (4'-3")
Height 51" (4'-3")

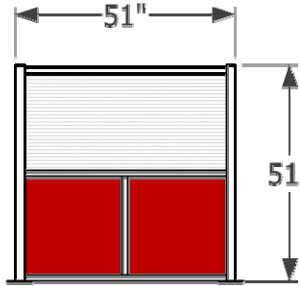

SW5151-3

Grade 1 \$ 599.
Grade 1A \$ 674.
Grade 2 & 3 (page 19)

Width 51" (4'-3")
Height 51" (4'-3")

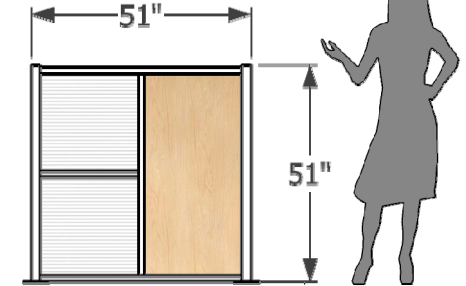

SW5151-4

Grade 1 \$ 599.
Grade 1A \$ 674.
Grade 2 & 3 (page 19)

2 Panel High 4' - 3" Tall

Width 51" (4'-3")
Height 51" (4'-3")

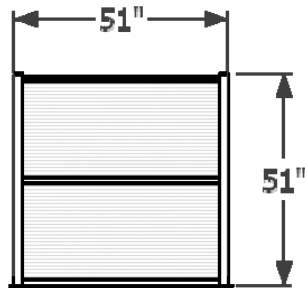

SW5151-5

Grade A1 \$ 579.
Grade 1A \$ 629.
Grade 2 & 3 (page 19)

Width 51" (4'-3")
Height 51" (4'-3")

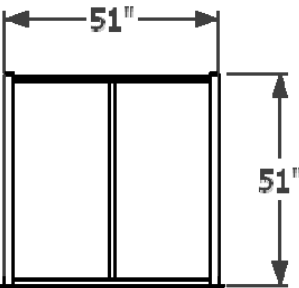

SW5151-6

Grade 1 \$ 579.
Grade 1A \$ 629.
Grade 2 & 3 (page 19)



3 Panel High 6'-3" Tall

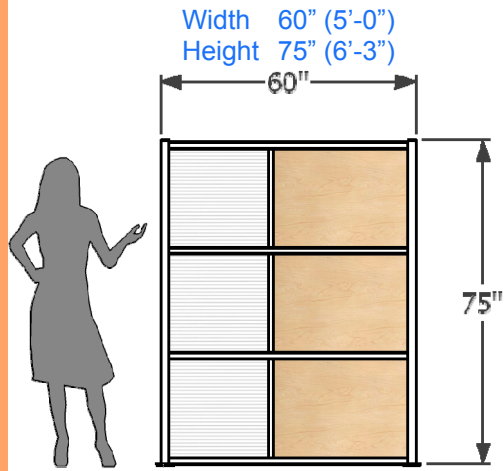

SW6075-1

Grade 1 \$ 769.
Grade 1A \$ 919.
Grade 2 & 3 (page 17)

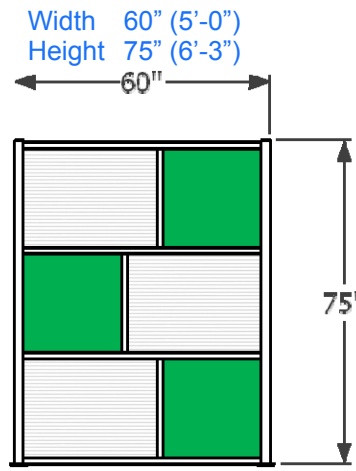

SW6075-2

Grade 1 \$ 769.
Grade 1A \$ 919.
Grade 2 & 3 (page 17)



2 Panel High 4'-3" Tall

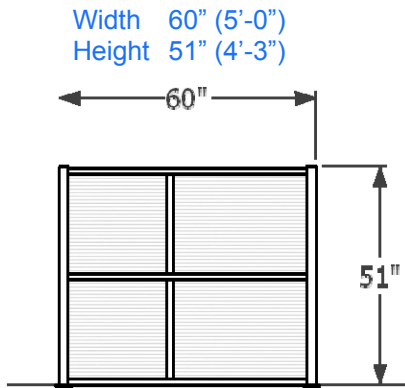

SW6051-1

Grade 1 \$ 579.
Grade 1A \$ 629.
Grade 2 & 3 (page 17)

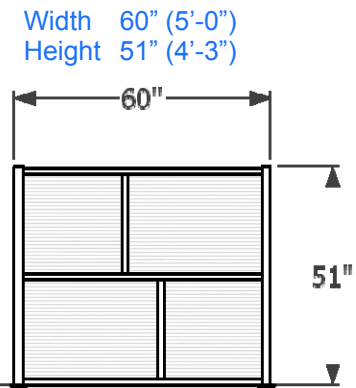

SW6051-2

Grade 1 \$ 579.
Grade 1A \$ 629.
Grade 2 & 3 (page 17)



3 Panel High 6'-3" Tall

Width 75" (6'-3")
Height 75" (6'-3")

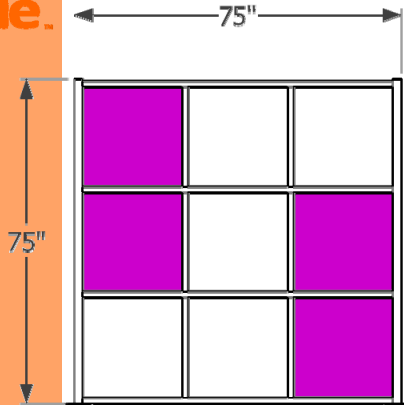

SW7575-1

Grade 1 \$ 1019.
Grade 1A \$ 1219.
Grade 2 & 3 (page 19)

Width 75" (6'-3")
Height 75" (6'-3")

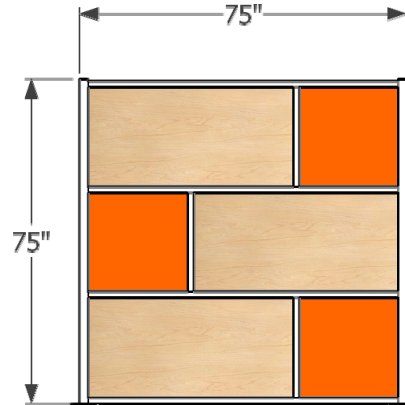

SW7575-2

Grade 1 \$ 899.
Grade 1A \$ 1049.
Grade 2 & 3 (page 19)

Width 75" (6'-3")
Height 75" (6'-3")

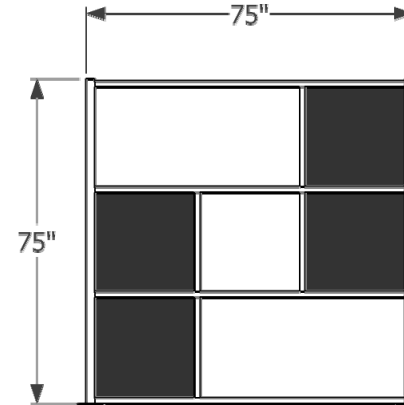

SW7575-3

Grade 1 \$ 939.
Grade 1A \$ 1114.
Grade 2 & 3 (page 19)

Width 75" (6'-3")
Height 75" (6'-3")

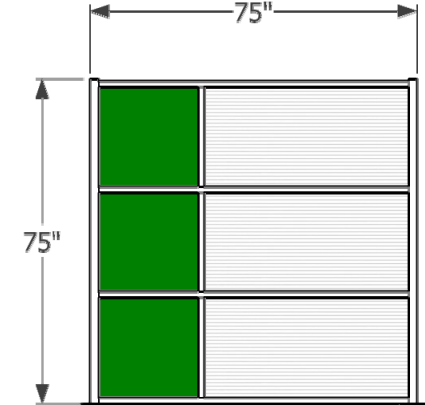

SW7575-4

Grade 1 \$ 899.
Grade 1A \$ 1049.
Grade 2 & 3 (page 19)

3 Panel High 6'-3" Tall

Width 75" (6'-3")
Height 75" (6'-3")

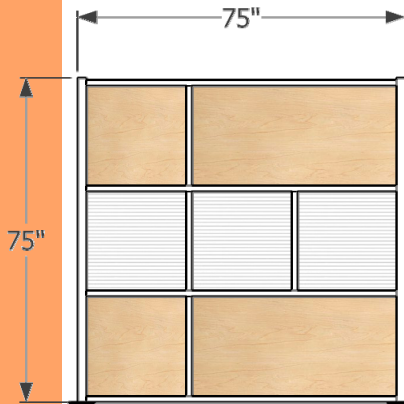

SW7575-5

Grade 1 \$ 939.
Grade 1A \$ 1114.
Grade 2 & 3 (page 19)

Width 75" (6'-3")
Height 75" (6'-3")

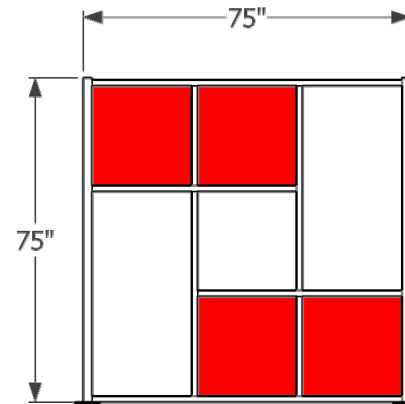

SW7575-6

Grade 1 \$ 939.
Grade 1A \$ 1114.
Grade 2 & 3 (page 19)

Width 75" (6'-3")
Height 75" (6'-3")

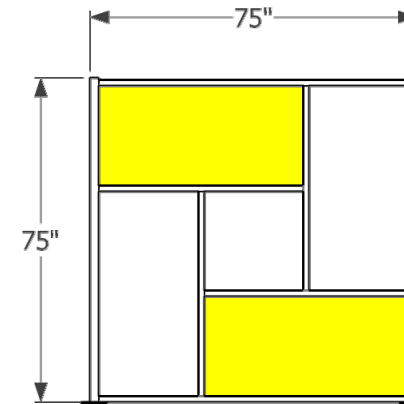

SW7575-7

Grade 1 \$ 939.
Grade 1A \$ 1114.
Grade 2 & 3 (page 19)

Width 75" (6'-3")
Height 75" (6'-3")

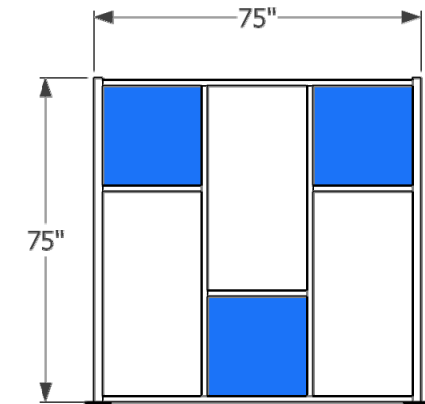

SW7575-8

Grade 1 \$ 899.
Grade 1A \$ 1049.
Grade 2 & 3 (page 19)

2 Panel High 4'-3" Tall

Width 75" (6'-3")
Height 51" (4'-3")

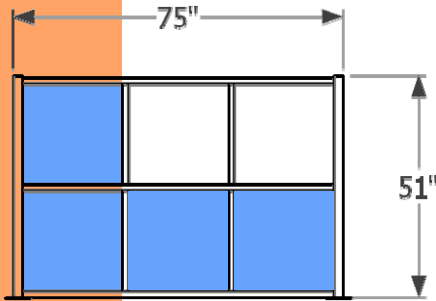

SW7551-1

Grade 1 \$ 799.
Grade 1A \$ 899.
Grade 2 & 3 (page 19)

Width 75" (6'-3")
Height 51" (4'-3")

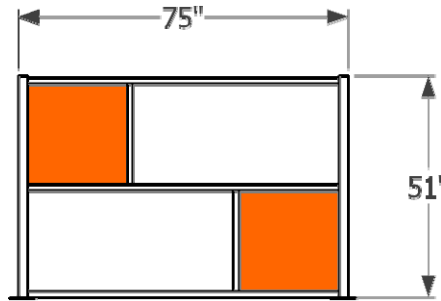

SW7551-2

Grade 1 \$ 749.
Grade 1A \$ 849.
Grade 2 & 3 (page 19)

Width 75" (6'-3")
Height 51" (4'-3")

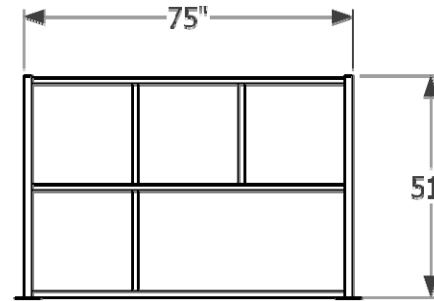

SW7551-3

Grade 1 \$ 789.
Grade 1A \$ 939.
Grade 2 & 3 (page 19)

Width 75" (6'-3")
Height 51" (4'-3")

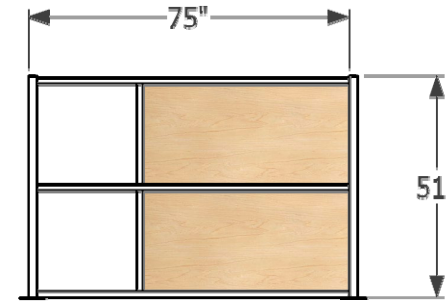

SW7551-4

Grade 1 \$ 749.
Grade 1A \$ 849.
Grade 2 & 3 (page 19)

2 Panel High 4'-3" Tall

Width 75" (6'-3")
Height 51" (4'-3")

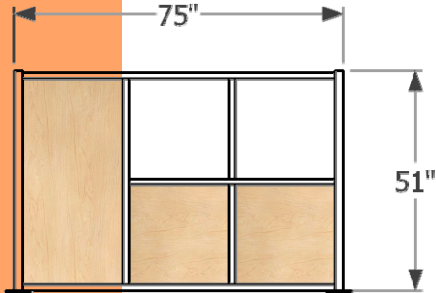

SW7551-5

Grade 1 \$ 789.
Grade 1A \$ 939.
Grade 2 & 3 (page 19)

Width 75" (6'-3")
Height 51" (4'-3")

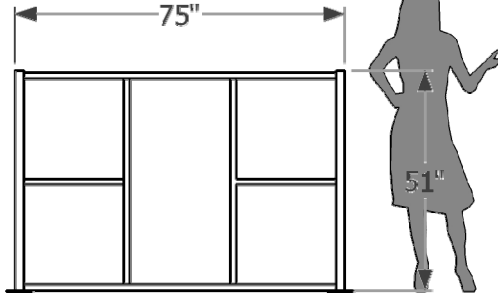

SW7551-6

Grade 1 \$ 789.
Grade 1A \$ 939.
Grade 2 & 3 (page 19)

Width 75" (6'-3")
Height 51" (4'-3")

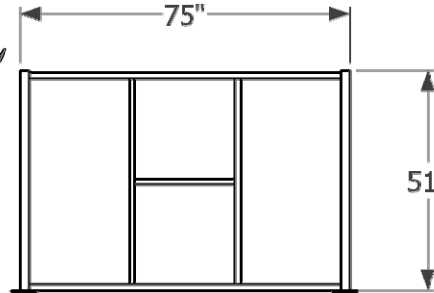

SW7551-7

Grade 1 \$ 789.
Grade 1A \$ 939.
Grade 2 & 3 (page 19)



3 Panel High 6'-3" Tall

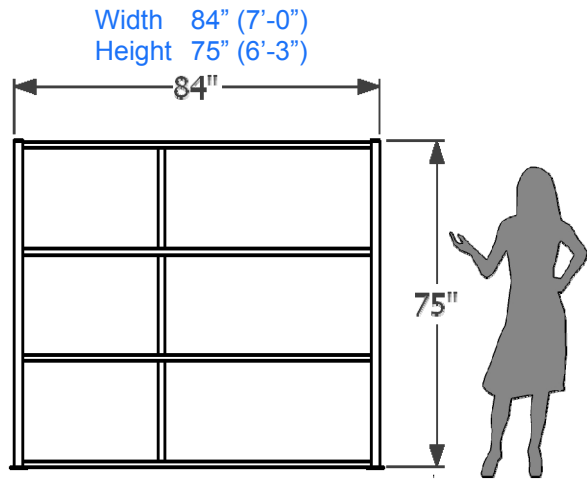

SW8475-1
Grade 1 \$ 999.
Grade 1A \$ 1224.
Grade 2 & 3 (page 19)

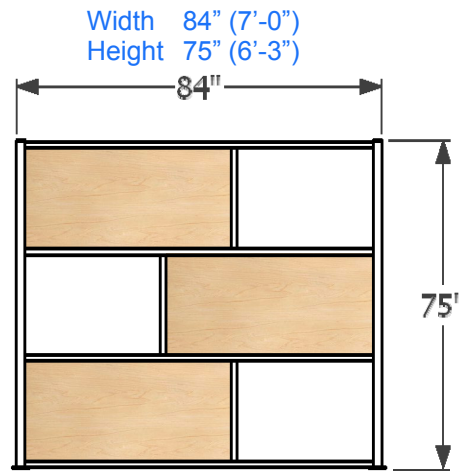

SW8475-2
Grade 1 \$ 999.
Grade 1A \$ 1224.
Grade 2 & 3 (page 19)

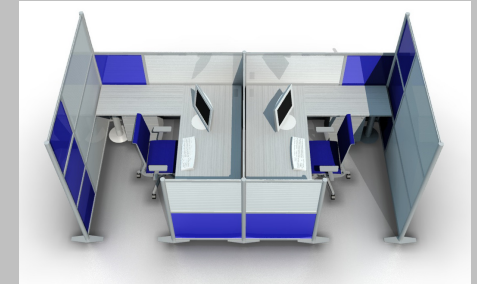

2 Panel High 4'-3" Tall

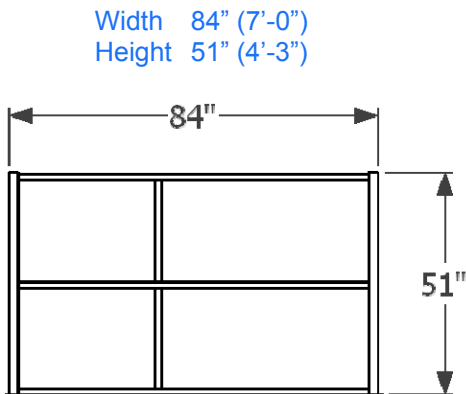

SW8451-1
Grade 1 \$ 799.
Grade 1A \$ 849.
Grade 2 & 3 (page 19)

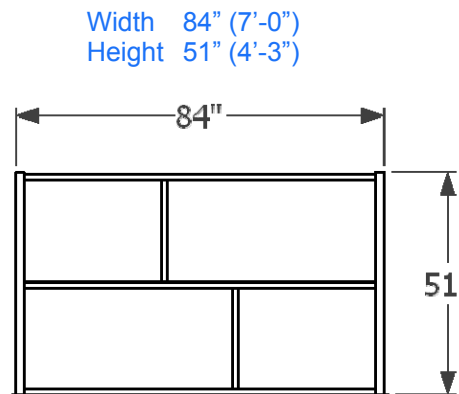

SW8451-2
Grade 1 \$ 799.
Grade 1A \$ 849.
Grade 2 & 3 (page 19)



3 Panel High 6'-3" Tall

Width 100" (8'-4")
Height 75" (6'-3")

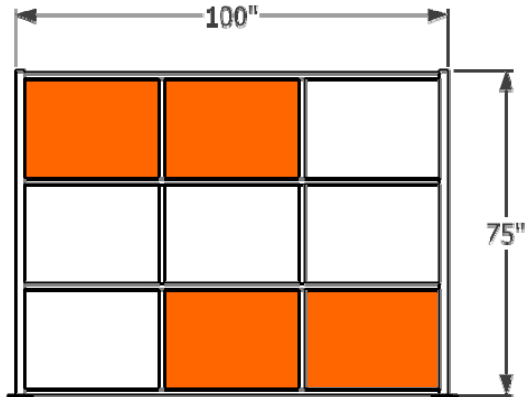

SW10075-1

Grade 1 \$ 1319.
Grade 1A \$ 1469.
Grade 2 & 3 (page 19)

Width 100" (8'-4")
Height 75" (6'-3")

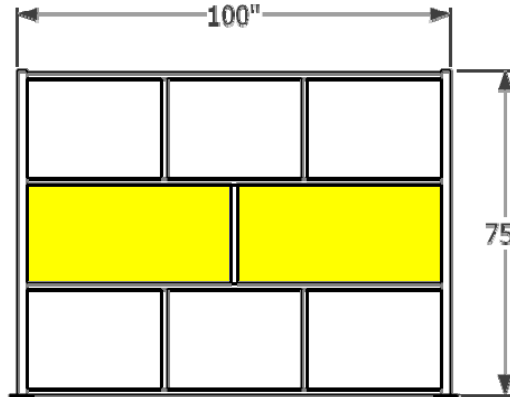

SW10075-2

Grade 1 \$ 1279.
Grade 1A \$ 1429.
Grade 2 & 3 (page 19)

Width 100" (8'-4")
Height 75" (6'-3")

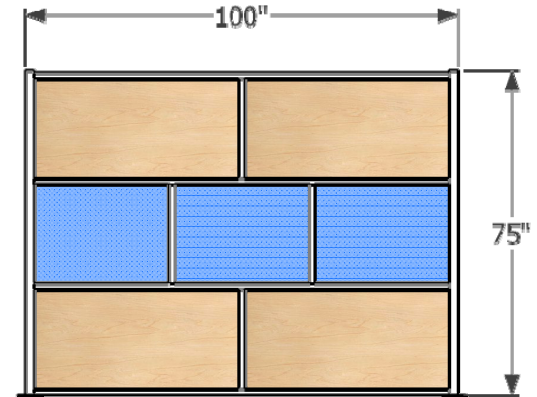

SW10075-3

Grade 1 \$ 1239.
Grade 1A \$ 1389.
Grade 2 & 3 (page 19)

3 Panel High 6'-3" Tall

Width 100" (8'-4")
Height 75" (6'-3")

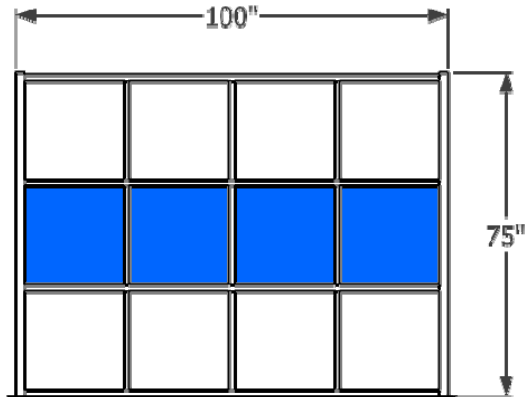

SW10075-4

Grade 1 \$ 1439.
Grade 1A \$ 1589.
Grade 2 & 3 (page 19)

Width 100" (8'-4")
Height 75" (6'-3")

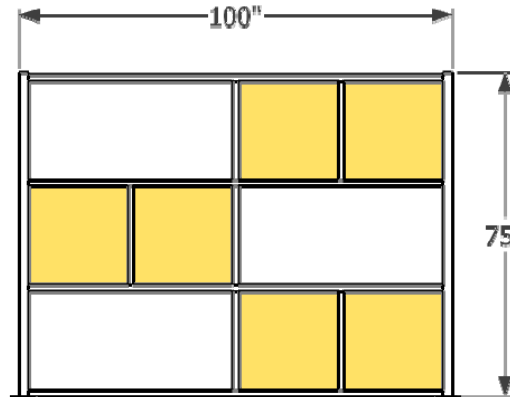

SW10075-5

Grade 1 \$ 1319.
Grade 1A \$ 1469.
Grade 2 & 3 (page 19)

Width 100" (8'-4")
Height 75" (6'-3")

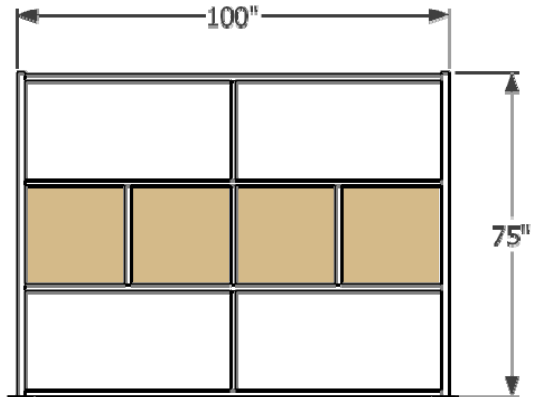

SW10075-6

Grade 1 \$ 1279.
Grade 1A \$ 1429.
Grade 2 & 3 (page 19)

3 Panel High 6'-3" Tall



Width 100" (8'-4")
Height 75" (6'-3")

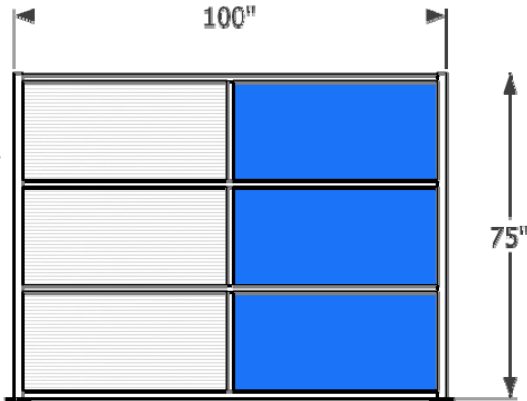

SW10075-7
Grade 1 \$ 1199.
Grade 1A \$ 1349.
Grade 2 & 3 (page 19)

Width 100" (8'-4")
Height 75" (6'-3")

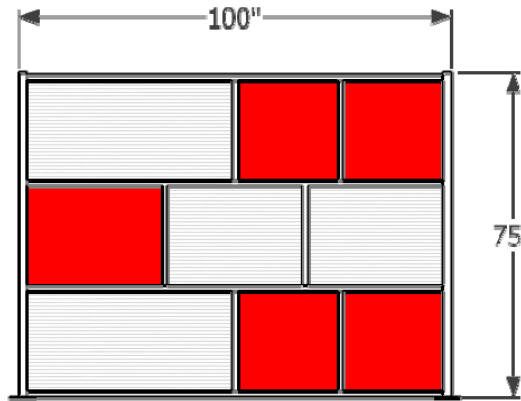

SW10075-8
Grade 1 \$ 1319.
Grade 1A \$ 1469.
Grade 2 & 3 (page 19)

Width 100" (8'-4")
Height 75" (6'-3")

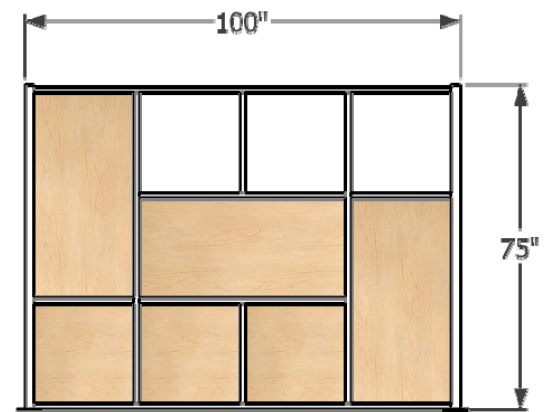

SW10075-9
Grade 1 \$ 1329.
Grade 1A \$ 1479.
Grade 2 & 3 (page 19)

3 Panel High 6'-3" Tall

Width 100" (8'-4")
Height 75" (6'-3")

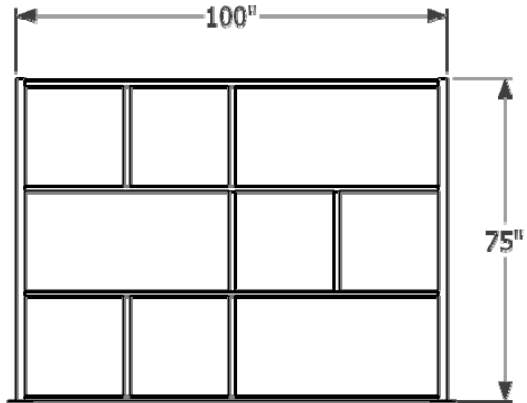

SW10075-10
Grade 1 \$ 1329.
Grade 1A \$ 1479.
Grade 2 & 3 (page 19)

Width 100" (8'-4")
Height 75" (6'-3")

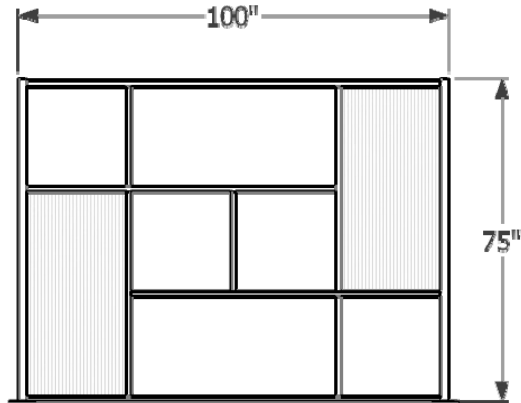

SW10075-11
Grade 1 \$ 1329.
Grade 1A \$ 1479.
Grade 2 & 3 (page 19)

Width 100" (8'-4")
Height 75" (6'-3")

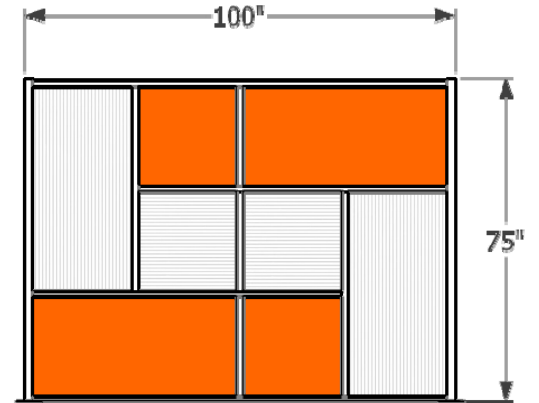

SW10075-12
Grade 1 \$ 1329.
Grade 1A \$ 1479.
Grade 2 & 3 (page 19)

2 Panel High 4'-3" Tall



Width 100" (8'-4")
Height 51" (4'-3")

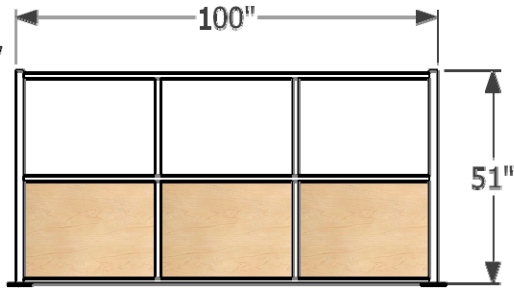

SW10051-1

Grade 1 \$ 959.
Grade 1A \$ 1139.
Grade 2 & 3 (page 19)

Width 100" (8'-4")
Height 51" (4'-3")

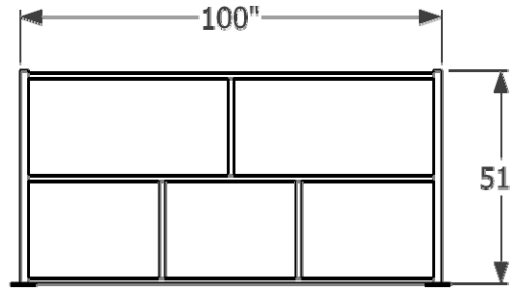

SW10051-2

Grade 1 \$ 919.
Grade 1A \$ 1099.
Grade 2 & 3 (page 19)

Width 100" (8'-4")
Height 51" (4'-3")

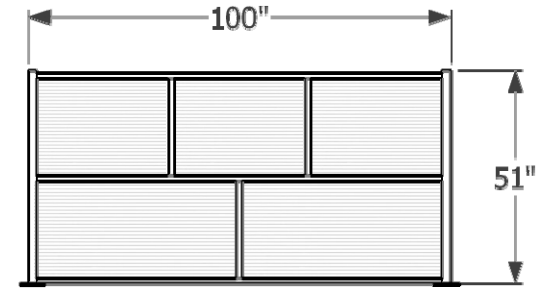

SW10051-3

Grade 1 \$ 919.
Grade 1A \$ 1099.
Grade 2 & 3 (page 19)

2 Panel High 4'-3" Tall

Width 100" (8'-4")
Height 51" (4'-3")

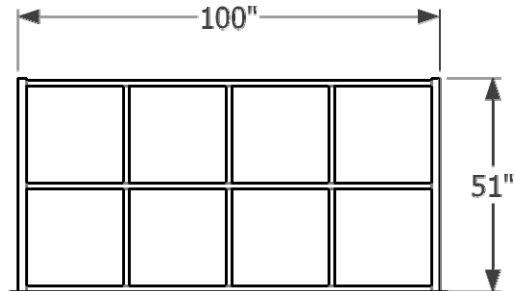

SW10051-4

Grade 1 \$ 1039.
Grade 1A \$ 1219.
Grade 2 & 3 (page 19)

Width 100" (8'-4")
Height 51" (4'-3")

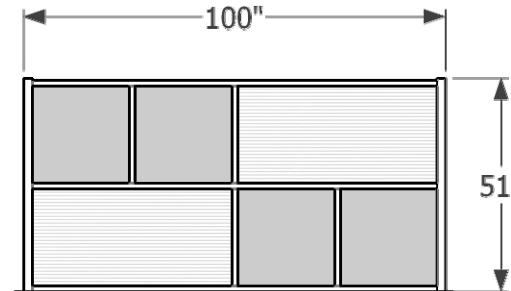

SW10051-5

Grade 1 \$ 959.
Grade 1A \$ 1139.
Grade 2 & 3 (page 19)

Width 100" (8'-4")
Height 51" (4'-3")

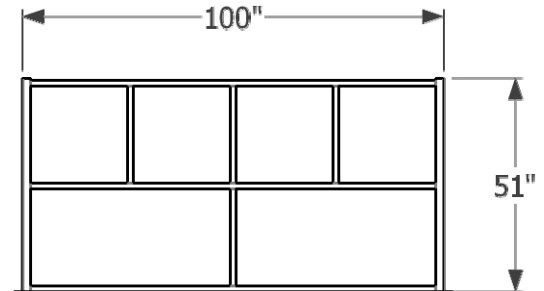

SW10051-6

Grade 1 \$ 959.
Grade 1A \$ 1139.
Grade 2 & 3 (page 19)

2 Panel High 4'-10" Tall



Width 27" (8'-4")
Height 58" (4'-10")

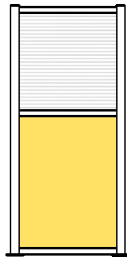

SW2758-1

Grade 1 \$ 349.
Grade 1A \$ 399.
Grade 2 & 3 (page 19)

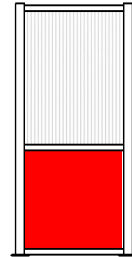

SW2758-2

Width 51" (4'-3")
Height 58" (4'-10")

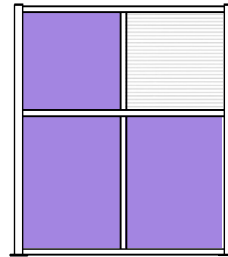

SW5158-1

Grade 1 \$ 629.
Grade 1A \$ 679.
Grade 2 & 3 (page 19)

Width 51" (4'-3")
Height 58" (4'-10")

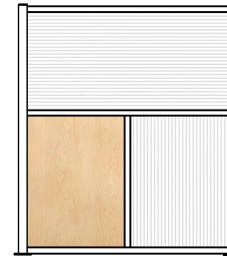

SW5158-2

Grade 1 \$ 619.
Grade 1A \$ 669.
Grade 2 & 3 (page 19)

Width 51" (4'-3")
Height 58" (4'-10")

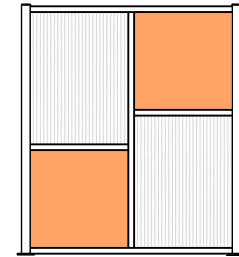

SW5158-3

Grade 1 \$ 629.
Grade 1A \$ 679.
Grade 2 & 3 (page 19)

2 Panel High 4'-10" Tall

Width 75" (6'-3")
Height 58" (4'-10")



SW7558-1

Grade 1 \$ 829.
Grade 1A \$ 879.
Grade 2 & 3 (page 19)

Width 75" (6'-3")
Height 58" (4'-10")

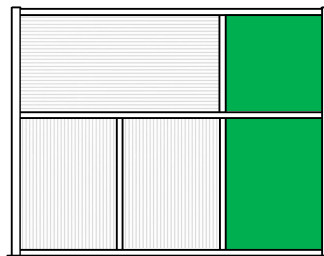

SW7558-2

Grade 1 \$ 819.
Grade 1A \$ 869.
Grade 2 & 3 (page 19)

Width 75" (6'-3")
Height 58" (4'-10")

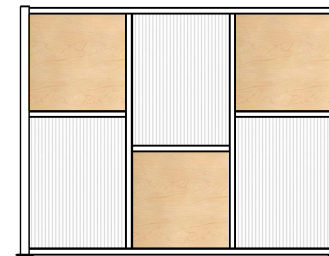

SW7558-3

Grade 1 \$ 829.
Grade 1A \$ 879.
Grade 2 & 3 (page 19)

Width 75" (6'-3")
Height 58" (4'-10")

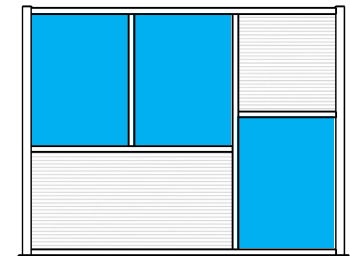

SW7558-4

Grade 1 \$ 819.
Grade 1A \$ 869.
Grade 2 & 3 (page 19)

2 Panel High 4'-10" Tall



Width 100" (8'-4")
Height 58" (4'-10")

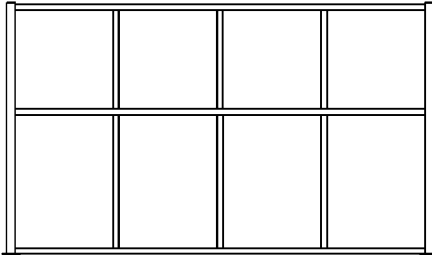

SW10058-1

Grade 1 \$ 929.
Grade 1A \$ 979.
Grade 2 & 3 (page 19)

Width 100" (8'-4")
Height 58" (4'-10")

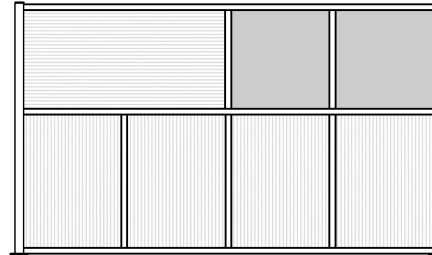

SW10058-2

Grade 1 \$ 919.
Grade 1A \$ 969.
Grade 2 & 3 (page 19)

Width 100" (8'-4")
Height 58" (4'-10")

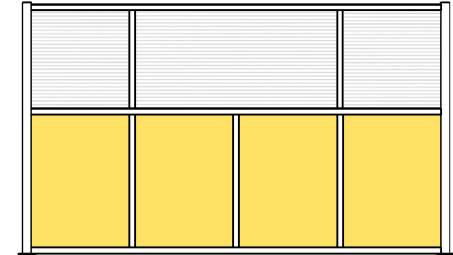

SW10058-3

Grade 1 \$ 919.
Grade 1A \$ 969.
Grade 2 & 3 (page 19)

2 Panel High 4'-10" Tall

Width 100" (8'-4")
Height 58" (4'-10")



SW10058-4

Grade 1 \$ 919.
Grade 1A \$ 969.
Grade 2 & 3 (page 19)

Width 100" (8'-4")
Height 58" (4'-10")

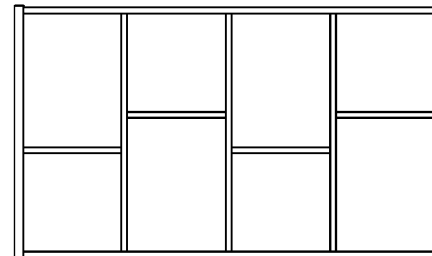

SW10058-5

Grade 1 \$ 939.
Grade 1A \$ 989.
Grade 2 & 3 (page 19)

Width 100" (8'-4")
Height 58" (4'-10")

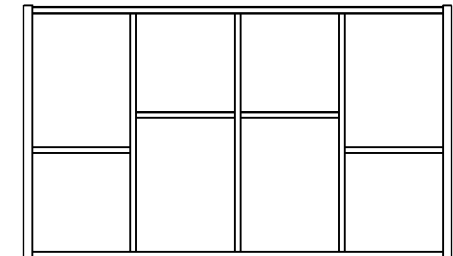

SW10058-6

Grade 1 \$ 939.
Grade 1A \$ 989.
Grade 2 & 3 (page 19)

iDivide your space your way...

Custom Designs

- Just about any configuration is possible
- Design your wall the way you want
- Many color and material options
- Layout and design services available
- Custom wall sizes

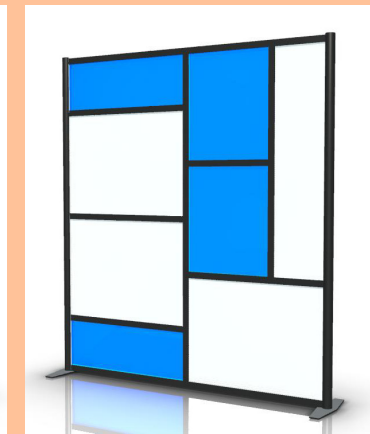
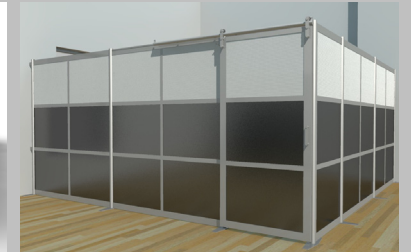
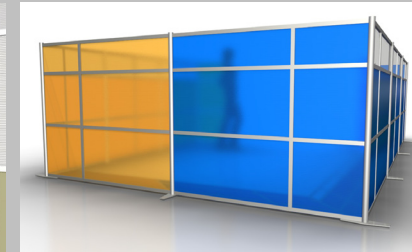
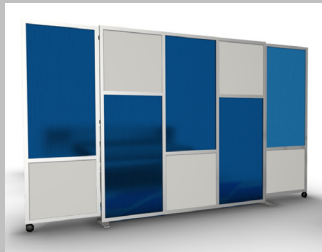
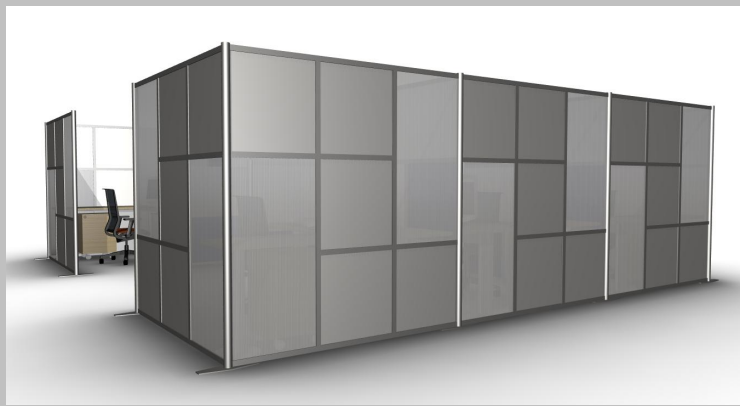

Panel Options

Panel Sizes and Price Grades



Small Square

- Grade 1** Twinwall Translucent single color for all panels in wall
- Grade 1A** Twinwall Translucent combination of white and hammered freeze
- Grade 2** Solid Color Opaque or Wood Grain Panel - Add \$ 50 per panel
- Grade 3** Acrylic Translucent Panel - Add \$ 75 per panel



Medium Rectangular

- Grade 1** Twinwall Translucent single color for all panels
- Grade 1A** Twinwall Translucent combination of white and hammered freeze
- Grade 2** Solid Color Opaque or Wood Grain Panels - Add \$ 65 per panel
- Grade 3** Acrylic Translucent Panel - Add \$ 90 per panel



Large Rectangular

- Grade 1** Twinwall Translucent single color for all panels
- Grade 1A** Twinwall Translucent combination of white and hammered freeze
- Grade 2** Solid Color Opaque or Wood Grain Panels - Add \$ 75 per panel
- Grade 3** Acrylic Translucent Panel - Add \$ 100 per panel

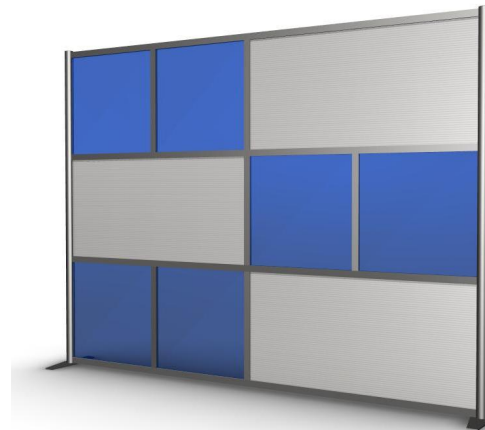

Panel Types

Twinwall Translucent

Hammered Freeze Translucent

- textured ribbed polycarbonate
- high light transmission
- blurs view
- face of panel is smooth
- standard stock panel option

White Translucent

- ribbed polycarbonate
- medium light transmission
- blocks view for full privacy
- face of panel is smooth
- works with dry-erase markers
- standard stock panel option

Clear Translucent (special order)

- ribbed polycarbonate
- maximum light transmission
- clear slightly distorted view
- face of panel is smooth

Natural Maple Wood Grain

- Natural Maple laminate finish
- Solid material
- No light transmission

Solid Opaque Plastic Colors

- Matte surface finish
- Solid color material
- No light transmission
- Assortment of colors available

Translucent Acrylic Colors

- Smooth glossy surface finish
- Varying light transmission depending on the color
- Assortment of colors available

Materials and Colors Panel Grades and Options

Twinwall Translucent Panels - Grade 1 and Grade 1A



Hammered Freeze Translucent

- textured ribbed polycarbonate
- high light transmission
- blurs view
- face of panel is smooth
- standard stock panel option

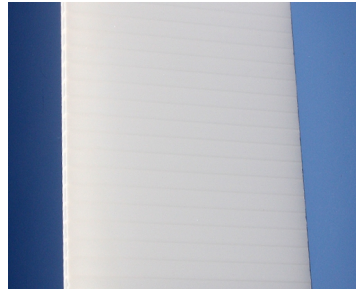

White Translucent

- ribbed polycarbonate
- medium light transmission
- blocks view for full privacy
- face of panel is smooth
- works with dry-erase markers
- standard stock panel option



Clear Translucent (special order)

- ribbed polycarbonate
- maximum light transmission
- clear slightly distorted view with no privacy
- face of panel is smooth
- Non-stock item

Wood Grain Panels - Grade 2



Natural Maple Light (stock item)

- wood grain laminate finish
- solid opaque
- face of panel is smooth
- standard stock panel option

Custom Frame Color Options

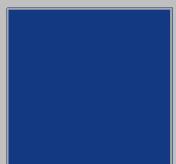
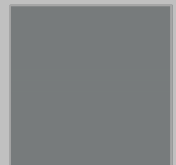

Solid Color Opaque Panels (matte finish) - Grade 2

Solid color opaque panels fabricated to order. Limited stock on some colors.

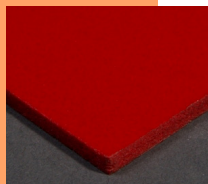

Red

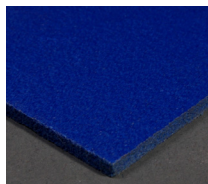

Blue

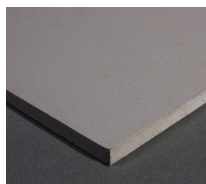

Light Grey

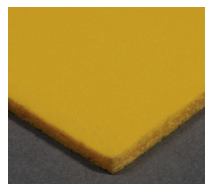

Yellow

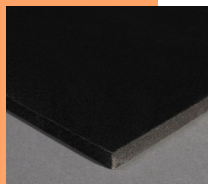

Black

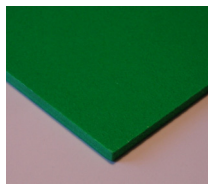

Green



White

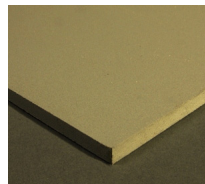

Beige

Translucent Acrylic Color Panels (gloss finish) - Grade 3

Acrylic color panels are fabricated to order. Additional colors available.



Orange



Blue

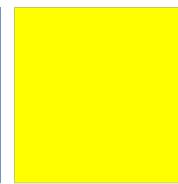

Yellow



Purple



Green



Red



Black



White

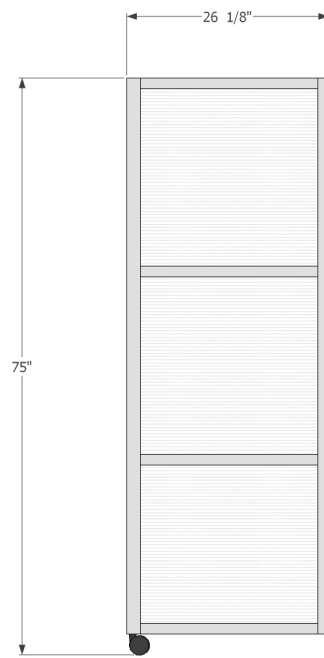
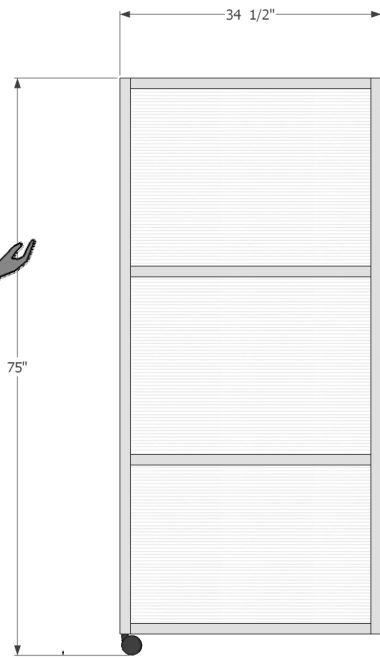
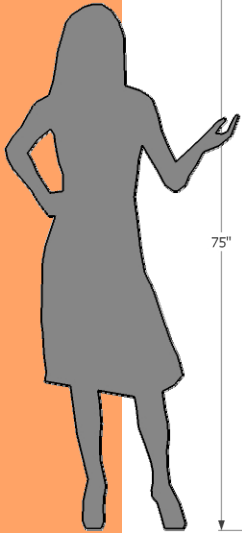

Rolling Door SW-34-R-DOOR & SW-26-R-DOOR

34 1/2" wide x 75" tall

26 1/8" wide x 75" tall

Hinged wall panel with a locking caster.

34 1/2" wide:

Grade 1 \$ 549.

Grade 1A \$ 599.

Grade 2 & 3 (refer to page 19)

26 1/8" wide:

Grade 1 \$ 529.

Grade 1A \$ 579.

Grade 2 & 3 (refer to page 19)

- Available in white, hammered freeze textured translucent and clear twin wall polycarbonate light transmitting panels.
- Also available in solid color opaque and acrylic translucent panels.
- Easy to assemble do-it-yourself system.
- Custom door sizes and designs are available.



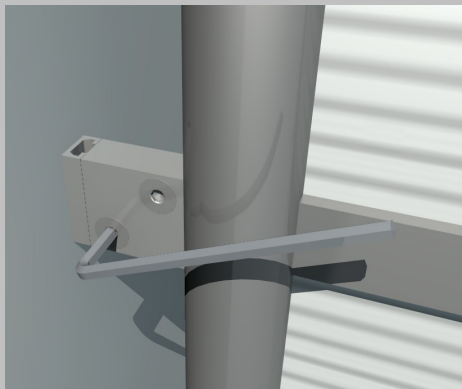

Connector Kit

Wall Connector Kit

- Use to attach any room divider to a wall
- Screws not provided for anchoring into wall material.
- Connects between wall mount channel and vertical slotted end post
- Clear anodized aluminum finish

Wall Connector Kit \$ 25. each

Mounting Plate Dimensions

4 1/2" x 4 1/2" x 1/8" Thick

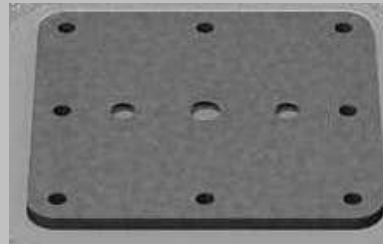

Mounting Base Plate

- Use to screw down any room divider to a floor
- Replaces standard floor base
- Custom paint colors available

Mounting Base Plate \$ 25. each (black paint color)

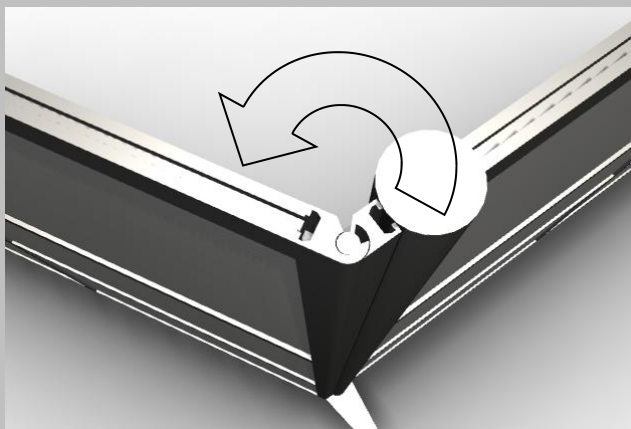

Adjustable Angling Frame Connector

- Attach a wall section and adjust the angle from 90 to 180 degrees
- Create a corner wall at any angle desired
- Clear anodized aluminum finish standard

Adjustable Angling Frame Connector:

Use with 75" Tall Wall \$ 135. each

Combine and Create

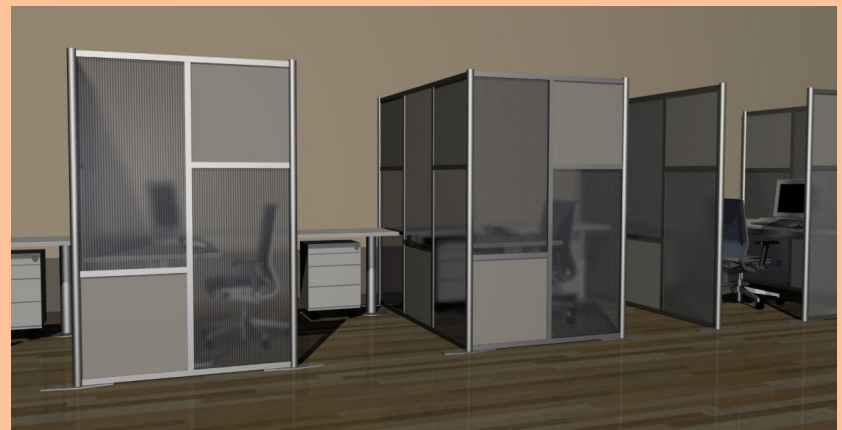
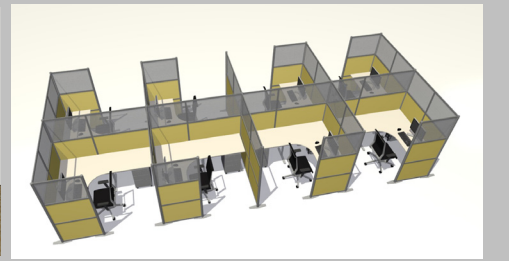
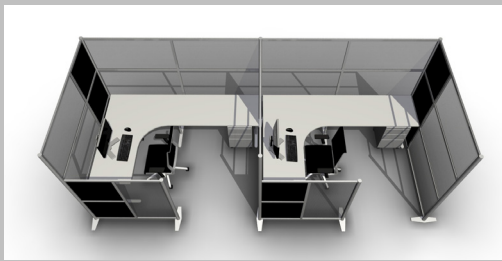
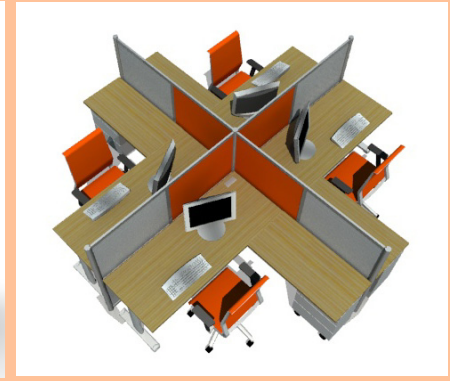

Combine and Create

