

SUZUKI AN650 Burgman and Burgman Executive with ABS brakes

Parts list for MCS 4060D kit

<u>Item</u>	<u>Qty</u>	<u>Part Number</u>	<u>Description</u>
1	1	MCSU 400C	Computer
2	2		M4 x 10 pan head screw
3	2		4mm flat washer
4	2		M4 Nylok nut
5	8cm		Foam mounting tape
<hr/>			
		<u>MCS 4062</u>	<u>Vacuum actuator assembly</u>
6	1	MCS 574	Vacuum actuator (triple solenoid)
7	1	MCS 020B	Actuator mounting bracket
	3		6g x 3/8" self tap screw
8	2	W500	M6 x 16 bolt with flat washer
9	2		6mm flat washer
10	2		M6 Nylok nut
<hr/>			
		<u>MCS 4067</u>	<u>Vacuum hose assembly</u>
11	2	MCS 032	Vacuum stop valve
12	5	MCS 031	Vacuum 'T' connector
13	3	MCS052	Vacuum restrictor
14			4mm Vacuum hose
15	1	MCS 4497A	Vacuum reservoir
16	2pcs		Foam tape (fitted to reservoir)
17	1	MCS 4063	Custom wiring harness
a			Computer plug (26 pin)
b			Fuse holder (3 amp fuse)
c			Speed sensor (co-axial wire)
d			Actuator plug (4 pin)
e			Power & brake sensor (orange and grey wires)
f			Ground connector (black wire)
g			Switch plug (6 pin)
18	1	MCS 820	Control Switch
19	1	MCS 830C	Switch bracket
	4		4 gauge x 1/2" pan head SS self tap screw
20		<u>MCS 4069</u>	<u>Cable Interface Unit (CIU) assembly</u>
21	1	MCS 4069A	CIU housing
22	1	MCS 003F	Actuator spool
23	1	MCS 4066	Dual spool
24	1	MCS 003H	Bush
25	1	MCS 003K	End Cap
26	1		M5 x 45 bolt
27	1		M5 Nylok nut
28	2		5mm plated flat washer
29	1		M4 x 10 pan head screw (actuator cable retainer)
30	1	MCS 4065B	Mounting bracket
31	1		M5 x 12 pan head screw (throttle cable retainer)
32	5		5mm flat washer (throttle cable retainer)

33	3		8mm flat washer (throttle cable adjustment shims)
34	5cm	HST12	12mm heat shrink tube
		<u>MC S4068</u>	<u>Throttle grip cable assembly</u>
35	1	MCS 300S	Throttle grip cable (short inner cable)
36	1	MCS 4068B	Cable retaining clip
37	1		M5 x 12 pan head screw
38	3		5mm flat washer
	1 bottle		Throttle cable oil (Singer industrial sewing machine oil)
	10		100mm cable ties
	5		150mm cable ties

Information, Set up and Operation Manual
 Operation and User Manual
 Installation Manual
 Trouble shooting guide

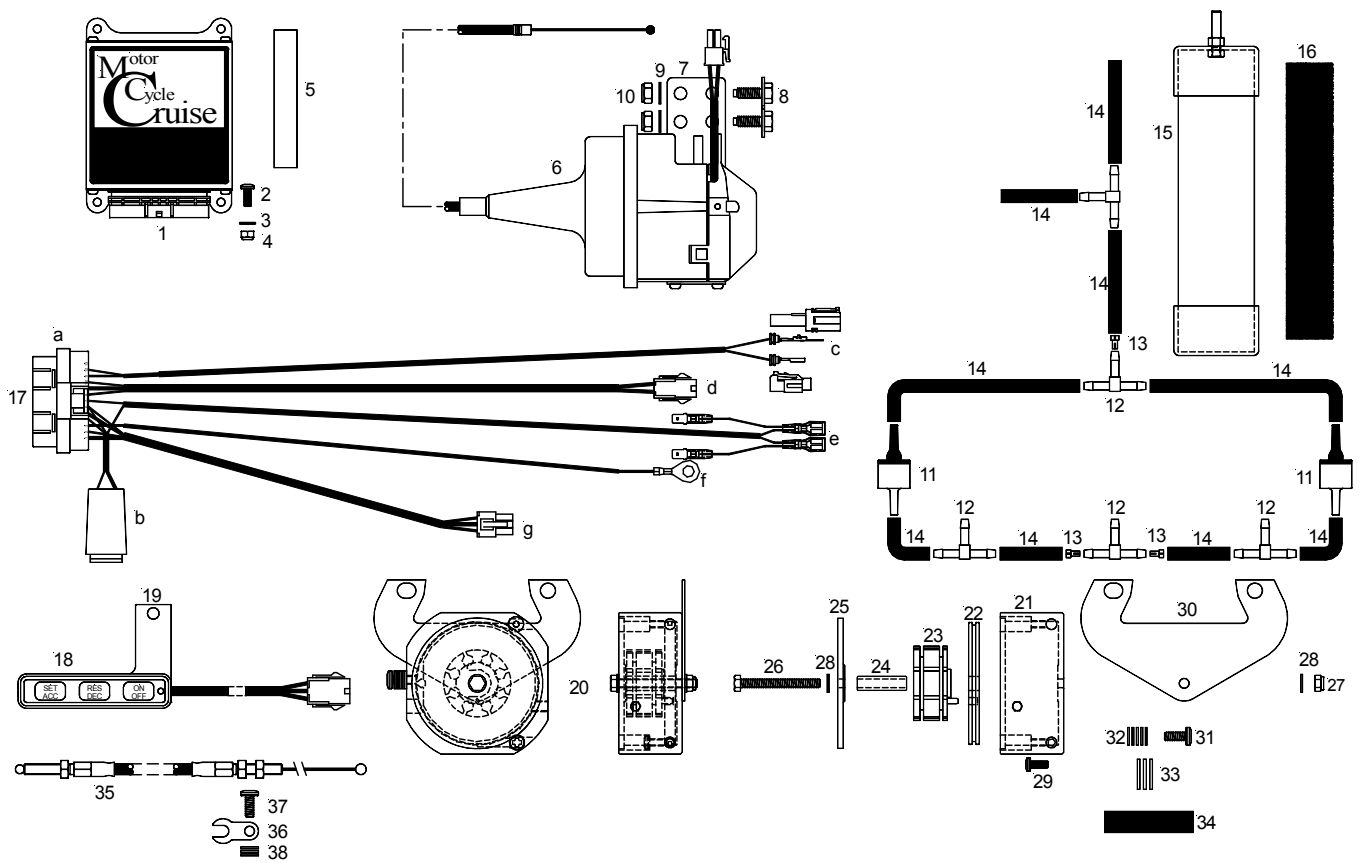

Dual spool hole marking

