

WILDFIRE

vbc racing

1/10 4WD ELECTRIC COMPETITION TOURING CAR KIT

DRIVER Siu Hung DATE 24 Feb 2013

TRACK NAME TITC 2013, RC Addict RESULT _____

TRACK SURFACE Asphalt GRIP CONDITION HI MED LOW

HUMIDITY _____ TRACK TEMP 65C

SETUP SHEET

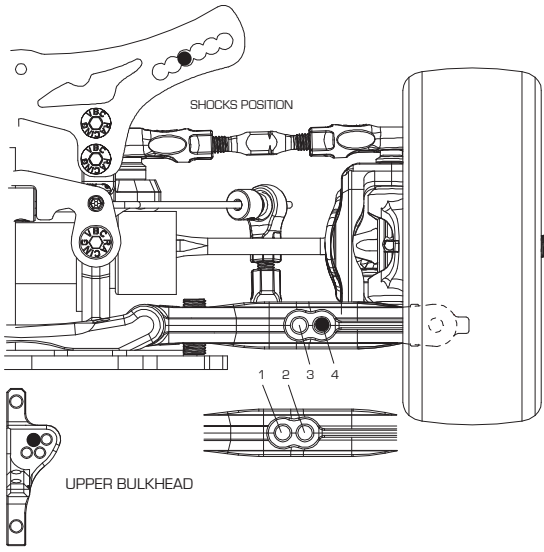

FRONT

GROUND CLEARANCE	<u>5</u> mm	REBOUND	<u>50%</u>
CAMBER ANGLE	<u>-2</u> °	TOE ANGLE	<u>-1</u> °
CASTER BLOCK	°	FRONT DRIVE DIFF (OIL)	<u>DIRECT</u>
STABILIZER	1.2 <u>1.3</u> 1.4	WHEEL SPACER	<u>4.5</u> mm
FRONT SUSPENSION MOUNT SHIM	<u>0.5</u> mm	REAR SUSPENSION MOUNT SHIM	<u>0.5</u> mm
FRONT SUSPENSION MOUNT	<u>E30</u>	REAR SUSPENSION MOUNT	<u>C0</u>
DOWNSTOP	<u>5.8</u> mm		

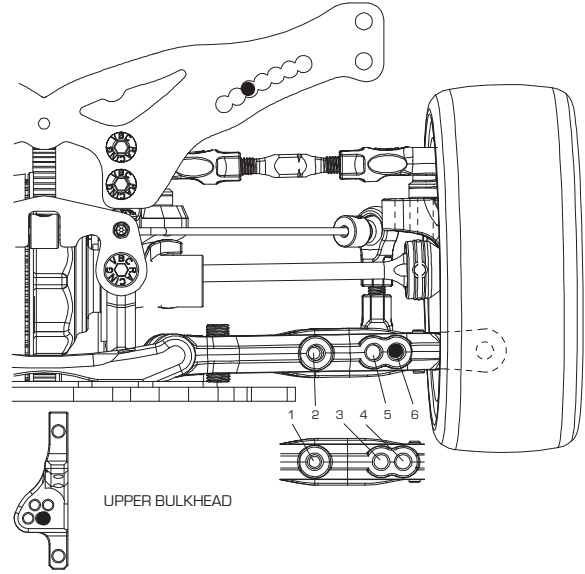

REAR

GROUND CLEARANCE	<u>5.5</u> mm	REBOUND	<u>50%</u>
CAMBER ANGLE	<u>-1.5</u> °	TOE ANGLE	°
		FRONT DRIVE DIFF (OIL)	<u>5000cst</u>
STABILIZER	<u>1.2</u> 1.3 1.4	WHEEL SPACER	<u>5</u> mm
FRONT SUSPENSION MOUNT SHIM	<u>1</u> mm	REAR SUSPENSION MOUNT SHIM	<u>1</u> mm
FRONT SUSPENSION MOUNT	<u>Y05 X05</u>	REAR SUSPENSION MOUNT	<u>E25</u>
DOWNSTOP	<u>5</u> mm		

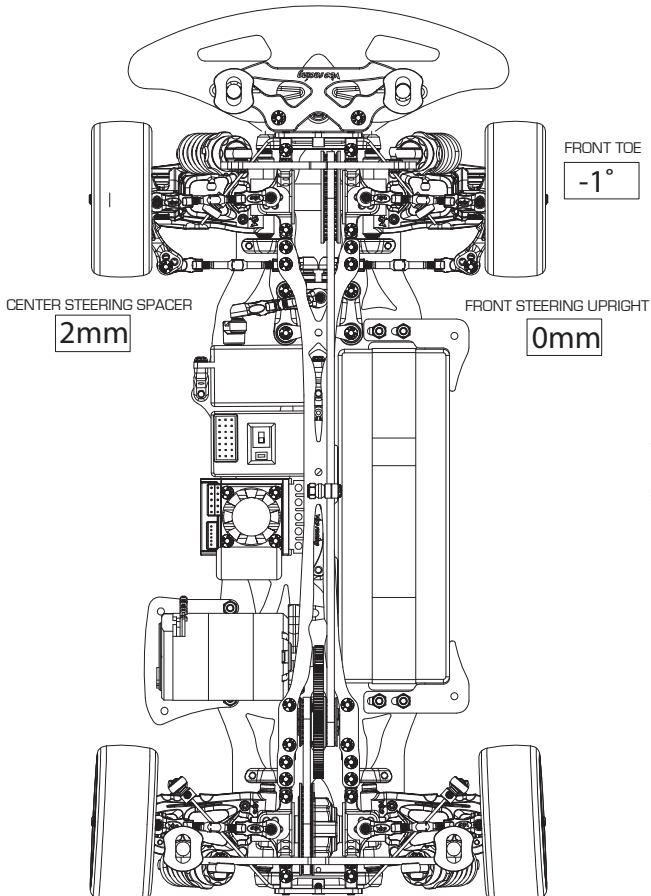

FRONT

SHOCK LENGTH	<u>64mm</u>
PISTON	1 2 <u>3</u> hole(s)
OIL	<u>400</u>
SPRING	<u>VBC Green</u>



REAR

SHOCK LENGTH	<u>64mm</u>
PISTON	1 2 <u>3</u> hole(s)
OIL	<u>400</u>
SPRING	<u>VBC Green</u>

MOTOR	<u>13.5T ORCA</u>	SPUR	<u>108T 64P</u>	PINION	<u>36</u>
TIRE	<u>Ride 26006</u>	TIRE INSERT		WHEEL	
TIRE ADDITIVE	<u>LRP</u>	BODY	<u>LTC-R</u>	BATTERY	<u>Silverback</u>
REMARKS	<u>TITC 2013 Open Brushless 13.5 - Finished B6</u>				
