

SafeTec Approved update 23.05.2014

This amendment applies to all Duck-R devices. Until further notice a copy of this should be supplied with each device and provided to each user with the main information sheet. Future deliveries will show this amendment on the printed information supplied with each unit.



DUCK-R

8

POSITIONING

At all times that the user is stationary the Duck-R should be positioned as high as possible. The Duck-R must always be above the descender or chest ascender and never below its lanyard/cows-tail attachment point (FF1).

Ascent: To move the Duck-R up the rope, hold the lanyard or karabiner- do not hold the device.

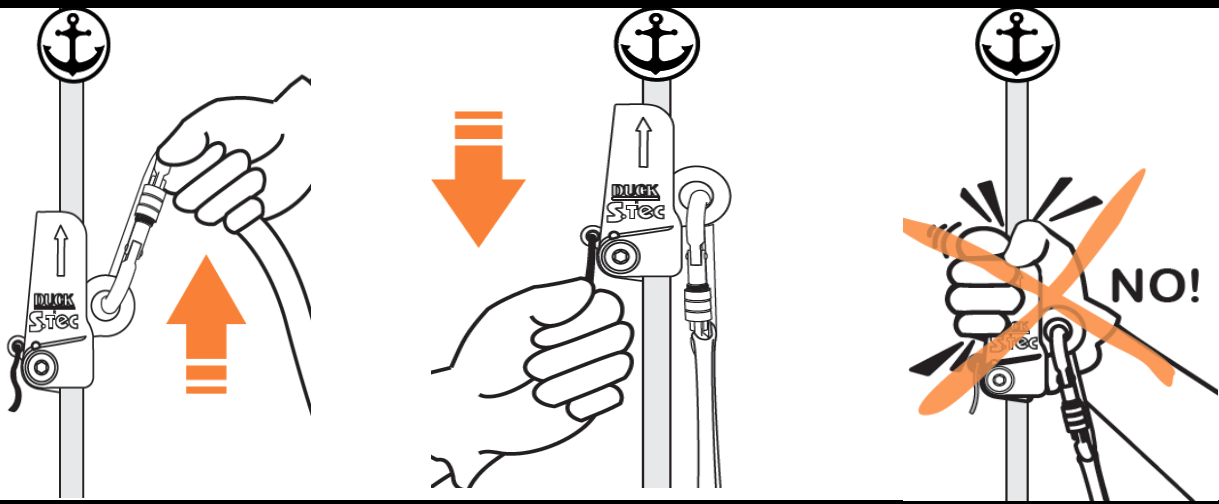

Descent: The Duck-R backup device is fitted with a Positioning cord. Users must always perform full function checks of their descent device and Duck-R before each descent. To move the Duck-R down, pull the Positioning cord down using the index finger and thumb. Users should only hold the positioning cord for as short a period as necessary and ensure that they are prepared to let go of the Positioning cord immediately at all times.

In many applications the Duck-R should be controlled independently of the descent device, in others it may be necessary to control both Duck-R and descent device simultaneously. It is the responsibility of the user to carry out a risk assessment and determine which method is best for their operational activity and environment.

WARNING

If users keep hold of the Positioning Cord, the device will not function. Users must release their hold of the Cord immediately if anything unexpected occurs. At all times users are to check the lanyard is not caught on obstacles and that it will not come in to contact with sharp edges, heat, tools or any other source of damage.



www.saftecb.com.br

Made in Brazil – SAFE TEC INDUSTRIA