



lilitab **Floor Basic**

Packing List and Assembly Instructions

v.2.0

TABLE OF CONTENTS

LILITAB FLOOR BASIC PACKAGING AND ASSEMBLY INSTRUCTIONS

lilitab Floor Basic Assembly Preparation	3
lilitab Floor Basic Features	4
lilitab Floor Basic Mount Options	5
lilitab Floor Basic Assembly Instructions.	6
Using the iPad Power Button Trigger and MagKey	8
lilitab Cleaning Instructions.	9

ASSEMBLY PREPARATION

TO ASSEMBLE YOUR LILITAB YOU WILL NEED:

- ✓ Phillips screwdriver

TO SECURE YOUR LILITAB YOU WILL NEED:

- ✓ Kensington compatible cable lock

TO BOLT YOUR LILITAB TO THE FLOOR YOU WILL NEED:

- ✓ Powered drill/driver, preferably with impact action
- ✓ Socket wrench with a neck of at least 5", this may require a socket extension
- ✓ 2 x bolts, wood screws or other fastener suitable for your floor's substrate (m6, no.14 or 1/4" diameter)

PACKING LIST

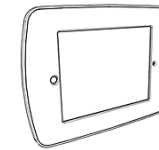

1 x head unit & faceplate

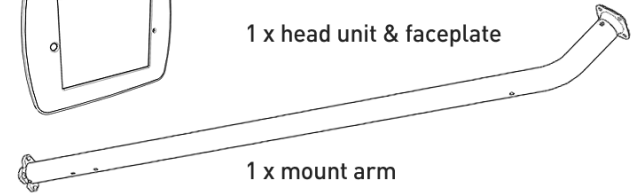

1 x mount arm

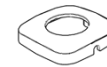

1 x foot cover
(included when purchased without base)



1 x MagKey



4 x head mount security screws



1 x L key

Optional Base Plate Items

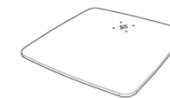

1 x base plate

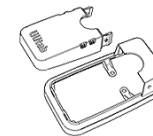

1 x base housing and cover



4 x base screws
(2x short; 2x long)



2 x base security screws

FEATURES

WIRELESS TRANSPARENCY

The lilitab head unit causes no radio interference.



USB CABLE SLOT

For peripherals

BASE HOUSING FOR TABLET'S AC ADAPTER

Included with optional base

BASE PLATE

Optional

ACCESSORY PANELS

Accepts expansion modules

MAGKEY

MAGKEY SLOT

Accepts a MagKey for securely sleeping an iPad.

2 X M4 ACCESSORY MOUNT POINTS

Accepts Banner Hanger, Printer Stand, Brochure Rack etc.

LOCK POINT

Accepts kensington lock



MOUNT OPTIONS

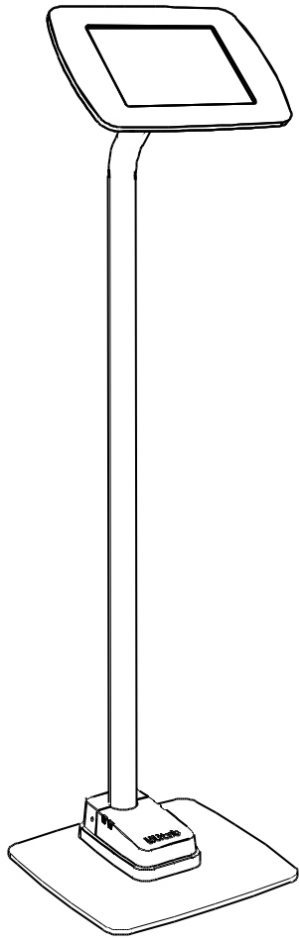

FREE STANDING WITH OPTIONAL
BASE PLATE AND BASE HOUSING

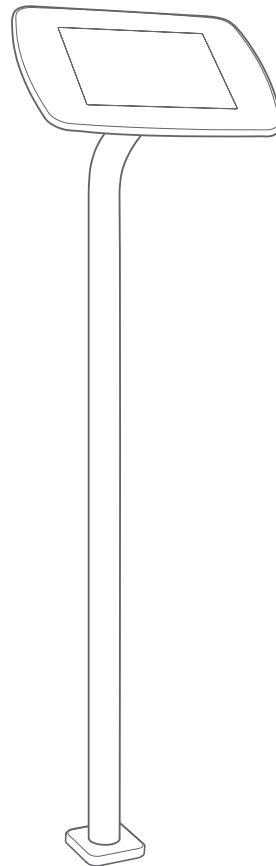

BOLT DIRECTLY TO THE FLOOR
(SHOWN WITH LOW-PROFILE FOOT COVER)

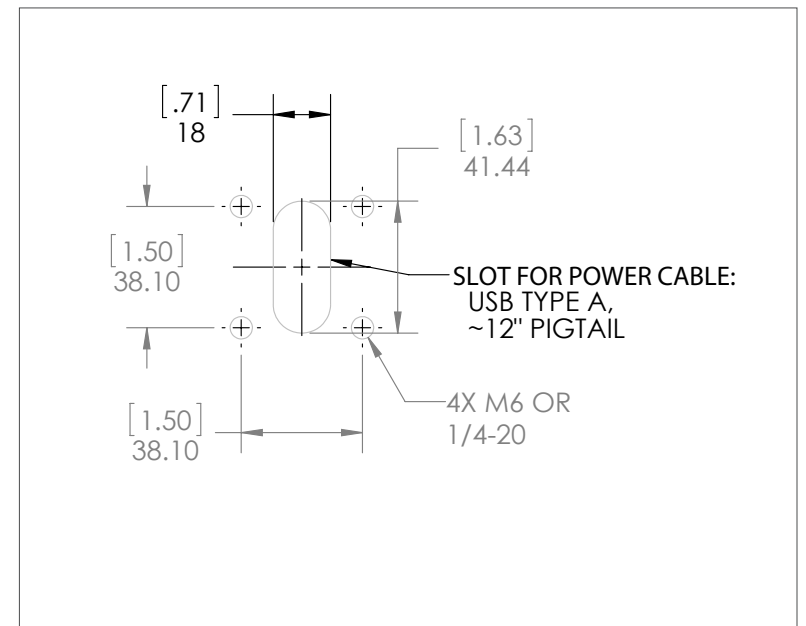

MOUNTING PATTERN

ASSEMBLY INSTRUCTIONS



- 1. Thread the charge and sync cable** through the pole. Then insert the pole mount into the base housing on an angle to clear the welded flange.

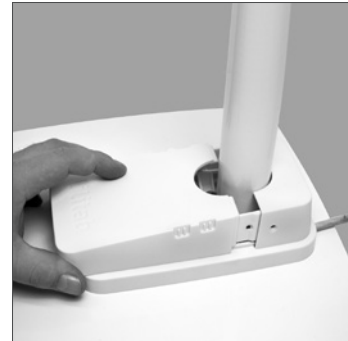

- 4. Attach the base housing cover** by sliding it into place.

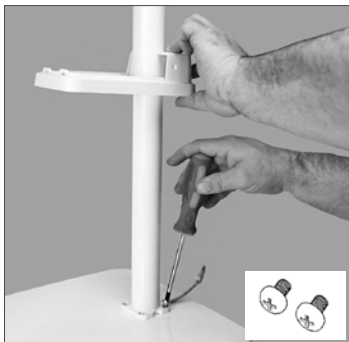

- 2. Attach base plate.** Position pole mount over the base plate. Using the **two short base screws** provided, bolt through the welded flange's two rear-most openings closest to the cable egress slot.

NOTE: You will need to hold the base housing up and out of your way while bolting.

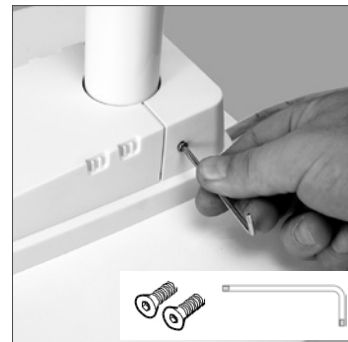

- 5. Secure the base cover** using the **two base security screws** and **L key** provided.



- 3. Connect and position cables:**

- 1.** Connect the usb cable to the tablet's AC adapter. Then connect the adapter to your extension cord.
- 2.** Position both cables underneath the two mount flanges. The extension cord should exit the rear of the housing.
- 3.** Screw down the base housing using the **two long base screws** provided.

(iPad AC adapter shown)

ASSEMBLY INSTRUCTIONS

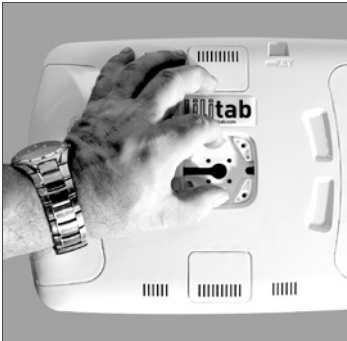

6. Open the lilitab head unit by placing it facedown on a clean surface and squeezing the finger latches together as shown. Carefully lift up and the faceplate will release, allowing access to the inside of the head unit.



9. Plug the charge and sync cable into your tablet's charge port, then place your tablet inside the enclosure face up.

If your tablet's charge connector is in the middle of the long edge ensure, your charge cable is inserted into the cable routing clips as shown in photo.

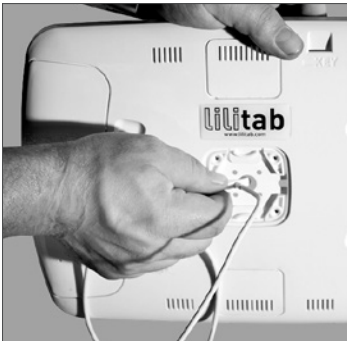

7. Thread the charge and sync cable from the top of the pole through the metal plate located in the center of the lilitab head unit and pull through to the other side.



10. Slide all four green retaining clips towards the center of the tablet.

NOTE: If clips aren't secure, adjust your tablet.

Lastly, position the faceplate over the tablet. Be sure to align the openings. Gently press down around the edges it will should snap into place.

NOTE: If the faceplate does not snap into place evenly ensure that all four green retaining clips are seated fully home.

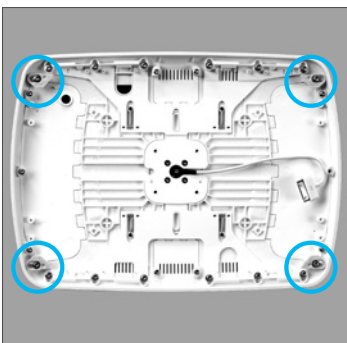

8. Place the head unit onto a clean surface with the inside of the enclosure facing up (your charge and sync cable should be on the right side of the enclosure as shown in the photo). Slide all four of the green retaining clips towards the outside of the enclosure.

NOTE: The green keepers will **NOT** be present for the iPad Air, Google Nexus, Samsung Galaxy Tab 3 or Samsung Note. Instead the faceplate's locating tabs will hold the tablet in place.

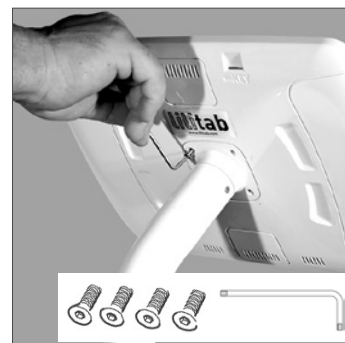

11. Attach your lilitab head unit to the top of pole with the **4 head mount security screws** and **L key** provided.

USING THE IPAD POWER BUTTON TRIGGER

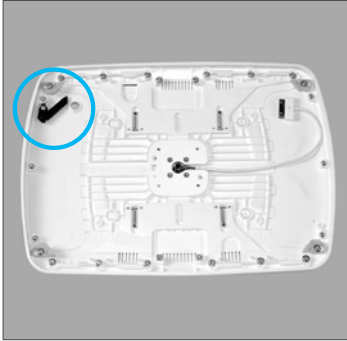

1. You can actuate the power button located on the edge of your iPad using the black Power Button Trigger shown to the left.



NOTE: Here's an iPad installed in the correct orientation with the Power Button Trigger next to the iPad's power button.

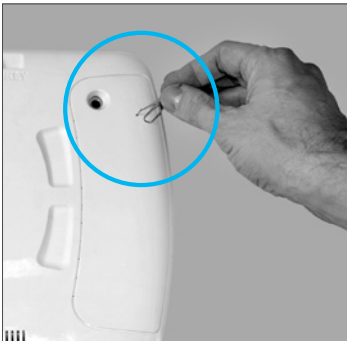

2. Once installed you can actuate the Power Button Trigger via a paper clip inserted into the small opening on the rear below the camera opening.

USING THE MAGKEY



1. You can use the included MagKey with an iPad 2,3 or 4 in your lilitab. The MagKey allows you to sleep the iPad without having any access to it. This ensures you (and your staff!) can turn your kiosk on and off at the end of the day without removing the iPad from the kiosk. You will always know when the iPad is sleeping because once inserted the MagKey pokes out the top of unit like a little flag.



2. To sleep your iPad simply insert your MagKey with the orange side facing front and the black side facing back.



3. Remove your MagKey and your lilitab will wake up, in exactly the same state it was in before it went to bed ;-)

NOTE: The MagKey is compatible with iPad 2, 3 and 4. It requires that the iPad Cover Lock/Unlock preference is turned on. You can find this in Settings→ General→ iPad Cover Lock/Unlock.

Replacement MagKeys can be ordered directly from the website: www.lilitab.com

LILITAB CLEANING INSTRUCTIONS



1. **Spray** the Brillianize onto one of the cloths provided.

WARNING: Other cloth/material may mar the surface of your lilitab



2. **DO NOT spray directly onto your lilitab!**



3. **Rub gently** in a circular motion to remove fingerprints and dirt.

WARNING: Applying excess pressure can mar the surface of your lilitab.

lilitab

QUESTIONS?

We're here to help!

EMAIL: support@lilitab.com

PHONE: (888) 705 0190