

lilitab **Surface 1.5**

Packing List and Assembly Instructions

v.1.0

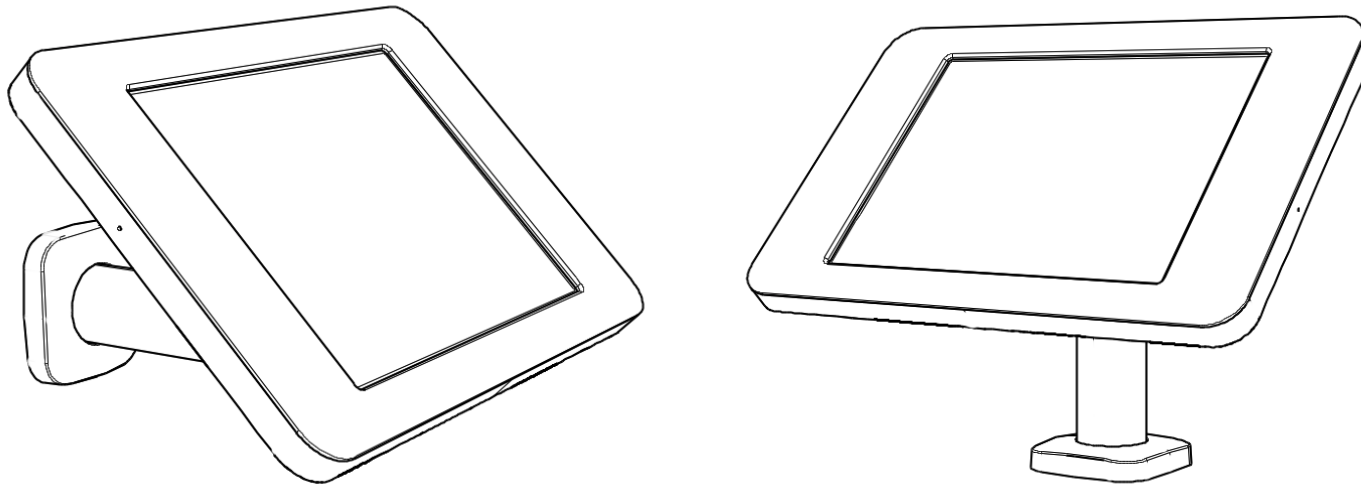

TABLE OF CONTENTS

LILITAB SURFACE PACKAGING AND ASSEMBLY INSTRUCTIONS

lilitab Surface Assembly Preparation	3
lilitab Surface Features	4
lilitab Surface Assembly Instructions	5

OPTIONAL ADD-ONS

Keyboard Mount Installation	9
---------------------------------------	---

ASSEMBLY PREPARATION

TO ASSEMBLE YOUR LILITAB YOU WILL NEED:

- ✓ Philips screwdriver

TO MOUNT YOUR LILITAB TO A SURFACE YOU WILL NEED:

- ✓ Powered drill/driver, preferably with impact action
- ✓ Four(4) bolts or wood screws (m5, no.10, no.11, 3/16" or 13/64 diameter)

PACKING LIST

1 x head unit & faceplate
(with 6' dock connector cable)

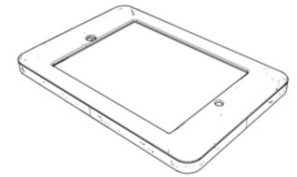

1 x surface mount



1 x foot cover



4 x faceplate security screws



1 x security L key (silver)

1 x joint screw L key (black)



FEATURES

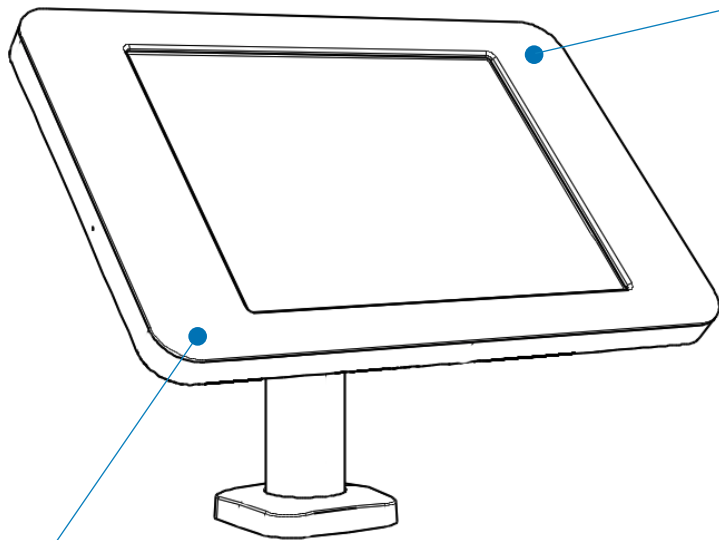

WIRELESS TRANSPARENCY

The lilitab head unit causes no radio interference.



ADJUSTABLE LILITAB HEAD

Operator can tilt lilitab head unit forward or back as well as rotate between horizontal and vertical orientations.

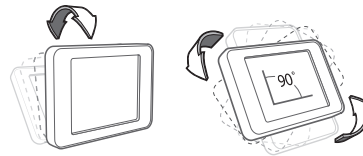

MULTI-POSITION NECK JOINT

Permits tilt up/down and landscape/portrait aspect rotation.

It has three operator configurable modes:

1. **Fixed.** The head unit has a 45° range of tilt allowing you to set the precise angle of tilt between +/-22.5° from the mount orientation.
2. **Tilt.** Can be configured to allow the user to tilt the head unit.
3. **Tilt + aspect rotation.** Can be configured to allow the user to tilt & rotate back and forth between landscape and portrait (aspect) orientation.

Note: The neck joint is designed to prevent the user over-rotating and damaging the internal usb power cable.

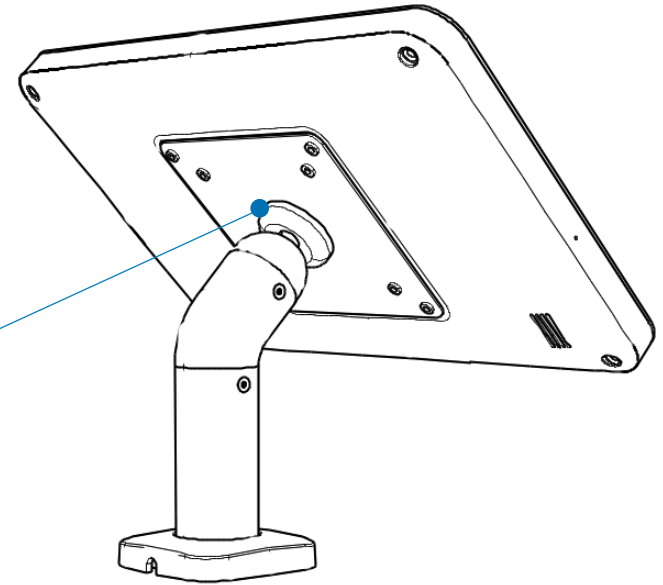

VERSATILE MOUNTING

Can be mounted to a horizontal or vertical surface.

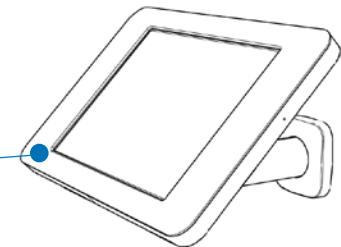

ASSEMBLY INSTRUCTIONS



- 1. Unpack unit.** There are two major components:
1. the head unit
 2. mount arm



- 2. Attach head unit to mount arm** via the two(2) screws and black allen key provided to secure the head unit to the mount arm.

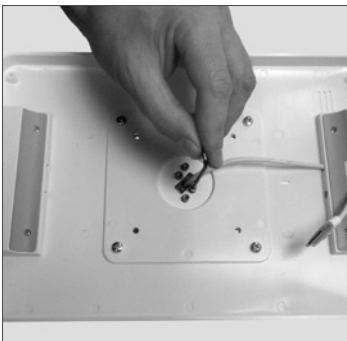

- 3. Attach to surface.** If you are not using a baseplate and instead attaching your unit directly to a counter top (or other horizontal surface) you will need to obtain four(4) fasteners suitable for your substrate.

USB cable can exit through bottom and either through mount surface or on top of the mount surface.



- 4. Fit foot cover over screws,** (velcro will hold it in place once positioned).



- 5. Plug iPad** into 30 pin dock connector cable and insert iPad into head unit.

ASSEMBLY INSTRUCTIONS



- 6.** Fit faceplate and secure via four(4) security screws (included) via security screw L key (included).

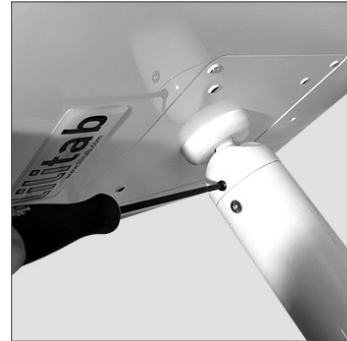

- 9.** If configuring the unit for user-operated tilt and aspect rotation, ensure all three(3) set screws are loosened such that the face of the set screw is flush with the outside of the neck joint (test to ensure the head moves freely).

NOTE: The joint is designed to prevent overrotation ensuring the internal usb cable is not accidentally or maliciously damaged.



- 7.** If configuring unit for fixed operation (no tilt, not aspect rotation), position head unit in desired position and screw all three(3) set screws in as tightly as possible (they are positioned on left, right and bottom).

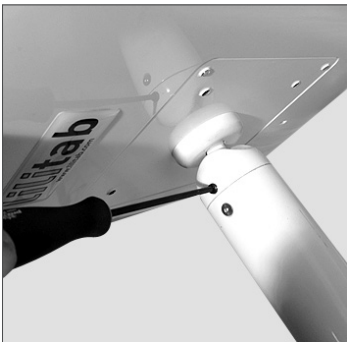

- 8.** If configuring the unit for user-operated tilt only, tighten the two(2) set screws on the left and right of the neck joint.



LILITAB SURFACE 1.5
OPTIONAL ADD-ONS



1. The keyboard mount comes already assembled, along with four(4) mounting screws.



3. Remove backing from velcro adhesive strips on keyboard mount.



2.1 FOR LANDSCAPE ORIENTATION: Attach the keyboard mount to lilitab mount plate with four(4) screws provided.



4. Place your keyboard carefully on top of tray to make contact with velcro adhesive. Press gently and secure.



2.2 FOR PORTRAIT ORIENTATION: Attach the keyboard mount to lilitab mount plate with two(2) screws provided.

lilitab

QUESTIONS?

We're here to help!

EMAIL: support@lilitab.com

PHONE: (888) 705 0190