

User Guide & Installation Manual

Deluxe Power Remote Mount Emergency Brake Kit

ASCPB02

INSTALLATION STEPS

1 CHAMBER ASSEMBLY

A) Mounting the linear actuator (LAD2) (Figure 1)

- i. Using the pre-drilled hole on the bottom of the chamber, secure the lower mounting pivot on linear actuator. Using spacer between chamber base and linear actuator, secure bolt and nut tightly.

B) Attaching the Brake Cables

- i. Insert Brake Cables into pre-drilled holes on short side of chamber base, opposite linear actuator lower mount. Tighten until snug.
- ii. Attach brake cable ends to adjustable cable clamp, securing tightly (Figure 2).
- iii. Using center hole on adjustable cable clamp, attach short cable/adjustable threaded rod to bracket (Figure 3).
- iv. Attach bracket to upper linear actuator pivot mount (Figure 3).
- v. Secure Chamber Lid using screws.

PARTS INCLUDED

- Chamber Assembly (ASCBK027)
- Linear Actuator (LAD2)
- Brake Cable Kit + Hardware (ASCBC001)
 - Adjustable Cable Clamp
 - Threaded Rod
 - Bracket
 - Spacer
 - Nuts and Bolts
 - Lid Screws
- 40 Amp Relay (RA1000)
- Weatherproof Connector (WPWC2)
- Control Unit (MotorCT2)
- 16mm Billet Button with LED (SW38R/Y)

2 MOUNT, ATTACH, ENJOY!

- A) Mount the Electric Brake Assembly in a Dry accessible space.
- B) Attach the brake cables to Rear brakes.

3 WIRING & ADJUSTMENT

Wiring: Follow the wiring diagram on page 2.

Linear Actuator Adjustment: Before operating correctly, the linear actuator must be aligned to the correct distance of travel for the cable.

The MOTORCT2 unit is used to program the distance of travel for the one touch unit. Simply wire up your negative input button to the brown input wire on the MOTORCT2. Press and hold the 'program up' and 'program down' buttons together, until both LEDs are lit, then release. Engage your momentary button for the length of time it takes the linear actuator to travel the distance needed to engage the brake lines. Your MOTORCT2 unit will now be programmed for this length of time. Test and adjust as needed.

Note: Sensitivity of the MOTORCT2 unit may need to be adjusted. As the unit senses resistance, it will disengage.

FIGURES

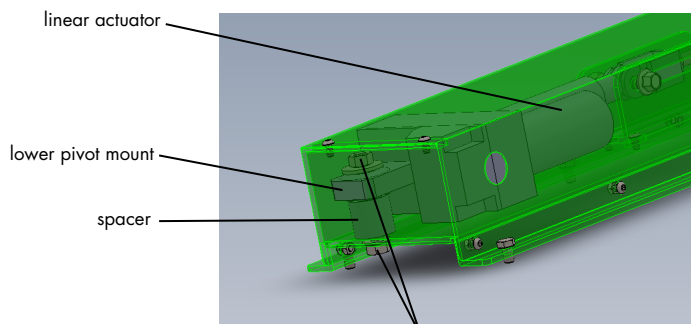

Figure 1

nut & bolt

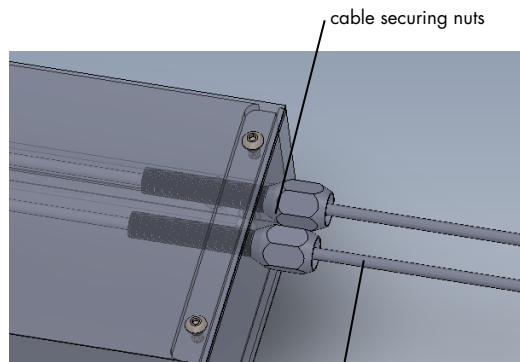

Figure 2

brake cable

User Guide & Installation Manual
Deluxe Power Remote Mount Emergency Brake Kit
ASCPB02

FIGURES CONT.

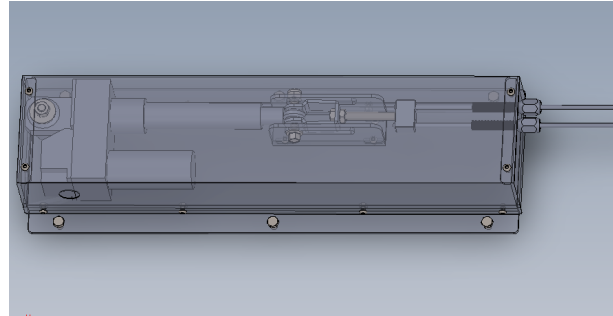
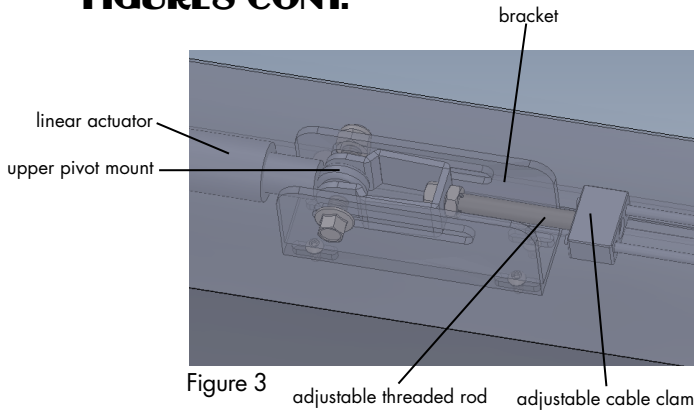

Figure 3

adjustable threaded rod adjustable cable clamp

Overview

WIRING DIAGRAM

