

PARTS LIST				PARTS LIST			
ITEM	QTY	PART NUMBER	DESCRIPTION	ITEM	QTY	PART NUMBER	DESCRIPTION
1	1	BFA02-06	SUPPORT BRACKET	41	1	15-202	BLACK BODY LABEL
2	4	25-243	Screw-10-32 x 1/2 Taptite	42	1	97-158	3/16 HEX KEY
3	1	08-245	GEARMOTOR 6RPM 120V				
4	1	BFA02-11	ROTATION BRACKET				
5	1	25-260	BOLT 1/4-20 x 3/4L TYPE F				
6	1	BFA02-03	ROTATION BRACKET				
7	2	78-901	SWITCH				
8	1	BFA02-10	LINKAGE ARM				
9	4	23-018	WASHER, NYLATRON				
10	2	25-021	SHSS 3/8 x 1/4L				
11	2	23-003	WASHER 1/4 BO				
12	1	BFA02-13	BACK COVER				
13	4	25-025	BOLT 5/16-18 X3/4 SERRATED				
14	8	24-012	NUT 5/16-18 SERRATED				
15	1	22-017	STRAIN RELIEF 1320				
16	1	97-157	FOOTSWITCH 15' CORD				
17	1	82-926	RELAY				
18	2	25-236	PHMS #6-32x.3L				
19	6	24-018	HEX NUT #6-32				
20	1	90-490	CORD 8' 5-15P 18-3				
21	1	22-070	STRAIN RELIEF 1424				
22	1	87-205	#8 RING TERMINAL				
23	1	73-278	BREAKER 2 A				
24	1	DDA-05	EATON 2604-11E SWITCH				
25	1	79-037	TIMER & BRACKET				
26	1	BFA02-01	BACK COVER				
27	1	79-035	Octal 8-Pin Socket				
28	1	BFA02-07	SIDE COVER				
29	1	BFA02-09	U-BOLT				
30	4	25-191	SCREW 6-32 x 1.0L				
31	4	25-192	#6 Int Tooth Lock Washer				
32	2	87-203	TERMINAL RED 1/4 FEMALE QC				
33	2	87-202	TERMINAL RED FORK				
34	1	BFA09-WK	WIRE KIT				
35	2	16-302	CABLE TIE 3.9L PLT1M				
36	1	97-162	COLLAR 1.688 ID				
37	1	97-152	BRG-BRNZ,1.5 ID				
38	1	16-301	CABLE TIE 14.5"L PLT4S				
39	1	BFA02-12	WRAPPER				
40	16	25-003	SCREW #10 x 3/4 PHSMS BO				

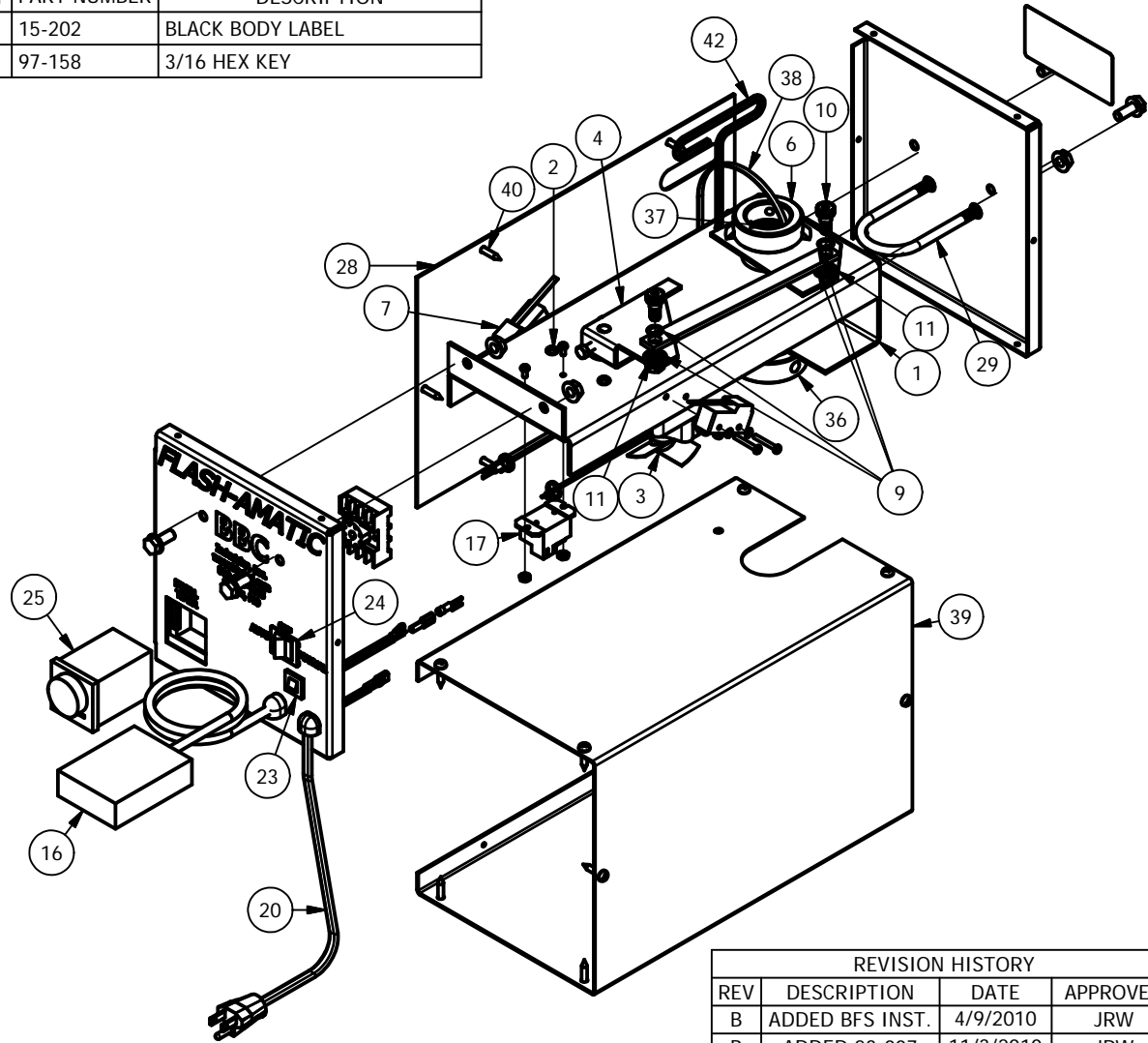

REVISION HISTORY			
REV	DESCRIPTION	DATE	APPROVED
B	ADDED BFS INST.	4/9/2010	JRW
B	ADDED 23-007	11/3/2010	JRW

PROPRIETARY DRAWING
THE INFORMATION AND DESIGN
ILLUSTRATED ON AND EMBODIED
IN THIS DRAWING IS CONFIDENTIAL
AND THE EXCLUSIVE PROPERTY
OF BBC INDUSTRIES

Black Body
INDUSTRIAL OVENS
SCREEN PRINT DRIERS

TOLERANCES
(UNLESS NOTED)
MACHINED X.X=±.02
X.XX=±.01 X.XXX=±.005
WELDED____1/16
FRACTIONAL____1/32
ANGULAR____1 DEG

BBC INDUSTRIES INC.
5 CAPPER DRIVE
PACIFIC MO 63069 USA
800-654-4205 WWW.BBCIND.COM

TITLE:
BFA-009FS MANUAL

SHEET 1 OF 2

MATERIAL: N/A

SCALE 1:6	DATE 12/4/03	NAME ZS	REV B
PART NO. 16-435			

Assembly Instructions for BF08 Stand

Notice: Flash-Amatic should be mounted away from heater face and positioned in the center of the arc movement of the heater.

1. Remove (6) #40 screws & #28 side cover.
2. Cut #39 tie holding #6 bracket, #36 collar & #37 washer.
3. Install #36 collar 4" down on lower tube of BF08 stand.
4. Install FLASH-AMATIC over lower tube resting on collar & secure with #29 u-bolt.
5. Apply grease to upper stand tube & insert into top of unit thru #6 bracket, #37 washer & into lower tube. Apply grease only to portion of upper tube inside lower tube.
6. Tighten bracket #6 set screw. Insure #8 linkage arm is level.
7. Reinstall #28 side cover & (6) #40 screws.

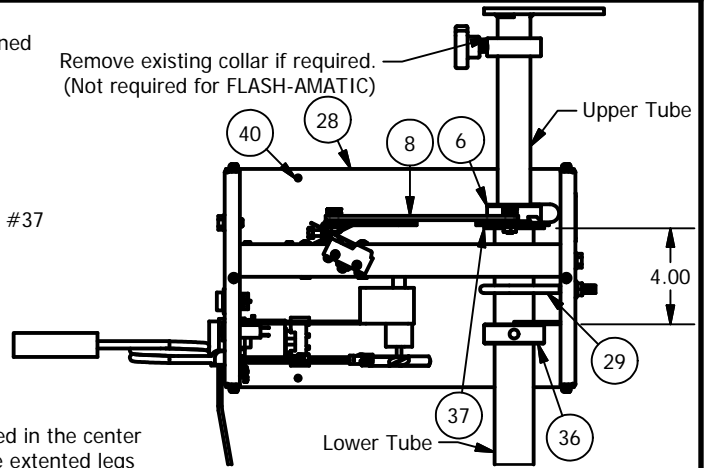

Assembly Instructions for BFS Stand

Notice: Flash-Amatic must be mounted away from heater face and positioned in the center of the arc movement of the heater. Arc movement must be centered over the extended legs of BFS stand. Remove bracket 97-197 & limit bracket 97-199 from BFS stand.

1. Remove (6) #40 screws & #28 side cover.
2. Cut #39 tie holding #6 bracket, #36 collar & #37 washer.
3. Install #37 collar 4" down on lower tube of BFS stand.
4. Install FLASH-AMATIC over lower tube resting on collar & secure with #29 u-bolt.
5. Apply grease to upper stand tube & insert into top of unit thru #6 bracket, #78 washer & into lower tube. Apply grease only to portion of upper tube inside lower tube.
6. Tighten bracket #6 set screw. Insure #8 linkage arm is level.
7. Reinstall #28 side cover & (6) #40 screws.

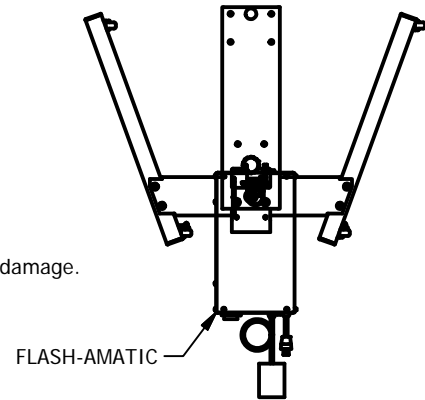

Height Adjustment & Operating Instructions

Height Adjustment:

Caution: Failure to support heater during adjustment could result in bodily injury and/or equipment damage.

1. Support heater & loosen set screw in #6 bracket.
2. Move heater to desired height.
3. Tighten set screw in #6 bracket.

Operation:

Notice: This unit has 2 modes of operation, Automatic & Manual

Automatic: Depressing the foot pedal will rotate the heater CW 110°, dwell per timer setting and return to home position.

1. Move rocker switch to Automatic.
2. Set timer to desired dwell time. (see timer settings)
3. Tap foot switch to start cycle. (When operating at 100 volts, hold foot switch for 1 second and release.)

Manual: Depressing & holding the foot pedal will rotate the heater CW 110° then rotate the heater CCW 110°. Removing foot will stop the cycle in any position.

1. Move rocker switch to Manual.
2. Depress and hold foot switch to desired location.
3. Remove foot to stop cycle.

Timer Settings

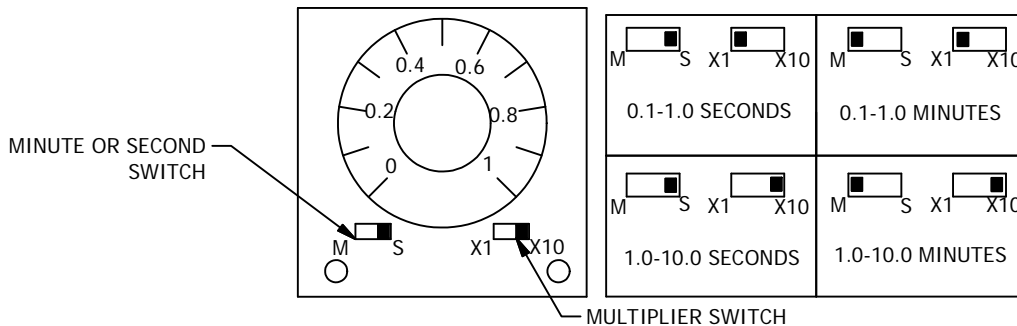

PROPRIETARY DRAWING THE INFORMATION AND DESIGN ILLUSTRATED ON AND EMBODIED IN THIS DRAWING IS CONFIDENTIAL AND THE EXCLUSIVE PROPERTY OF BBC INDUSTRIES	Black Body INDUSTRIAL OVENS SCREEN PRINT DRIERS	TITLE:	
		BFA-009FS MANUAL	
TOLERANCES (UNLESS NOTED) MACHINED X.X=±.02 X.XX=±.01 X.XXX=±.005 WELDED____1/16 FRACTIONAL____1/32 ANGULAR____1 DEG	BBC INDUSTRIES INC. 5 CAPPER DRIVE PACIFIC MO 63069 USA 800-654-4205 WWW.BBCIND.COM	SHEET 2 OF 2	
		MATERIAL: N/A	
		SCALE 1:8	DATE 9/24/09
PART NO. 16-435		REV B	