

KeySafe™ Original
User Guide
Pushbutton combination

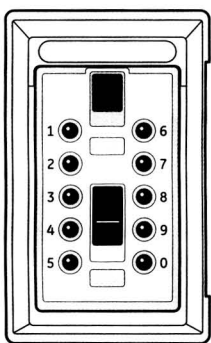

1058358A • March 2007
Copyright © 2007 GE Security

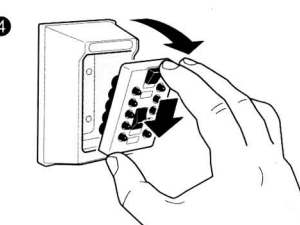
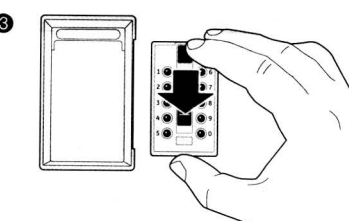
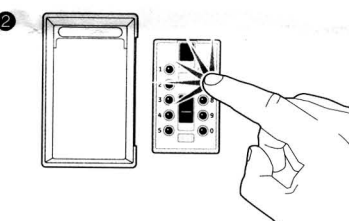
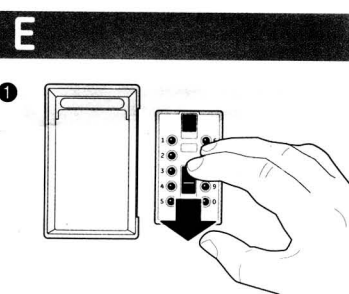
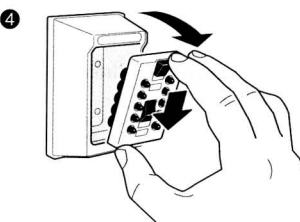
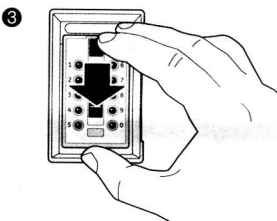
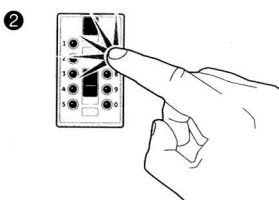
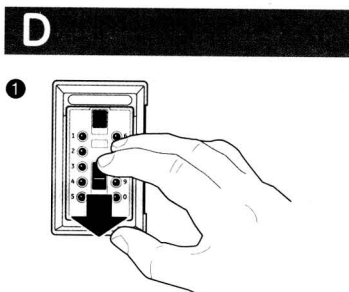
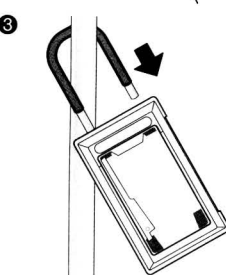
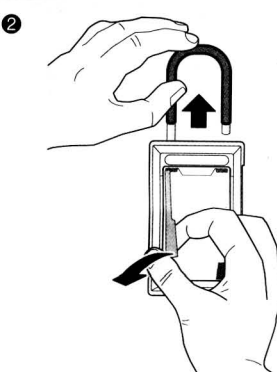
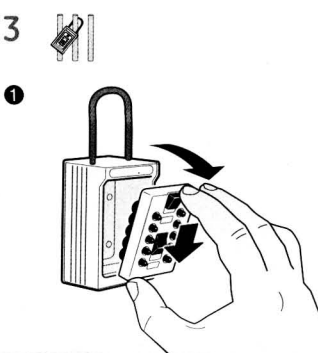
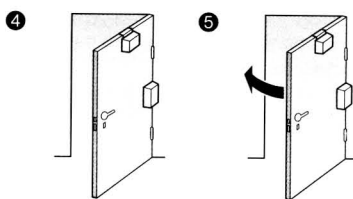
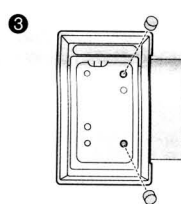
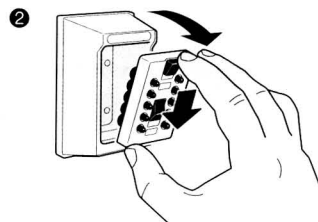
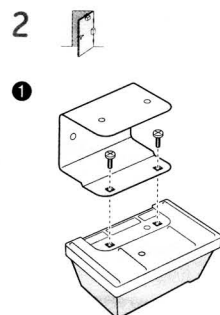
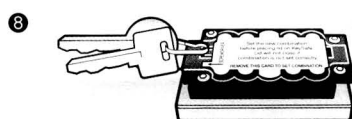
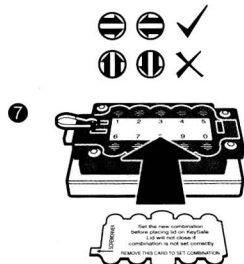
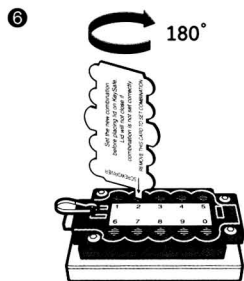

EN Installation instructions

See pictures for step-by-step instructions. Further information is provided below.

= Enter the combination.

General

KeySafe is a convenience product, not a security product.

A. Setting your combination

- There is no preset combination on your keybox. You select your own combination. Each number in a combination can only be used once.
- Do not use a number combination that can be easily guessed, such as telephone numbers or birthdays.
- Use five to seven numbers in your combination.

B. Testing your combination

1. Enter your number combination (each button pressed must click when pushed down).
2. Press down the OPEN button. If it has been set correctly, the OPEN button will slide down fully. If it has been incorrectly set, the OPEN button will not slide down fully. When this happens DO NOT return the lid to the keybox. Instead push down the CLEAR button and refer to the pictures in section A. *Setting your combination.*

C. Mounting your keybox

1. **Permanent model.** Mount the keybox on a flat surface, such as concrete or brick, preferably hidden from view.
2. **Door model.** Hang the bracket over top of door or to the side at the hinge of the door.
3. **Portable model.**

D, E. Opening and closing your keybox

You can enter the numbers of your combination in any order. If you have entered an incorrect combination, slide down the CLEAR button to return the buttons to their original settings.

Limited warranty

GE Security warrants that this product will be free of defects in material and workmanship for one year (two years in Europe) from the date of purchase. This warranty is limited to repair or replacement at GE Security's option. Damages caused by modification, abuse or misuse, wear and tear, improper installation, application, storage, or fault or negligence of a party other than GE Security are not covered. GE Security will not be responsible for labor costs of removal or reinstallation of products. The repaired or replaced product is then warranted under the terms of this limited warranty for the balance of the term of the warranty or for 90 days, whichever is longer. GE SECURITY MAKES NO OTHER WARRANTY, EXPRESS OR IMPLIED, OF MERCHANTABILITY OR FITNESS FOR A PARTICULAR PURPOSE. IN NO EVENT SHALL GE SECURITY BE LIABLE FOR LOSS OF USE, LOST PROFITS, THEFT, PROPERTY DAMAGE, OR SPECIAL, INCIDENTAL, OR CONSEQUENTIAL DAMAGES. To obtain repair or replacement information under the terms of this warranty, please contact your local supplier.

A

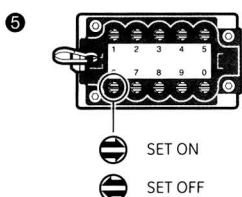
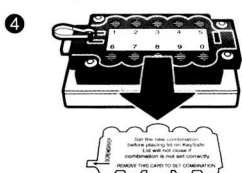
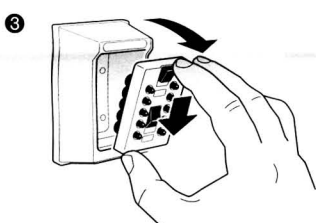
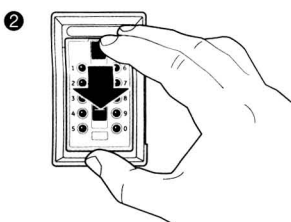
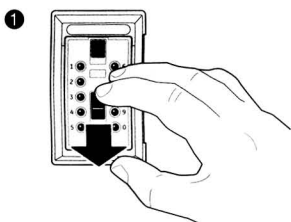

B

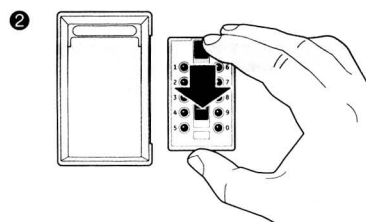
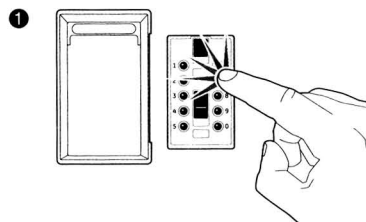

C

