



Trade, DIY, Bulk



T H R U F ● L D  
**DirectDoors.com**

All content and images are copyright protected by DirectDoors.com  
Intellectual Property Office Trademark  
No: UK00003238454

## DOOR CONFIGURATIONS & SIZES AT A GLANCE

DOOR CONFIGURATION	DOOR WIDTH OPTIONS	OVERALL WIDTH WITHOUT FRAME	OVERALL WIDTH INC. FRAME	OVERALL HEIGHT WITHOUT FRAME	OVERALL HEIGHT INC. FRAME
2 + 0	686mm	1385mm	1445mm	2054mm	2084mm
2 + 0	762mm	1537mm	1597mm	2054mm	2084mm
2 + 0	838mm	1689mm	1749mm	2054mm	2084mm
2 + 1	686mm	2076mm	2136mm	2054mm	2084mm
2 + 1	762mm	2304mm	2364mm	2054mm	2084mm
2 + 1	838mm	2532mm	2592mm	2054mm	2084mm
2 + 2	686mm	2765mm	2825mm	2054mm	2084mm
2 + 2	762mm	3069mm	3129mm	2054mm	2084mm
2 + 2	838mm	3373mm	3433mm	2054mm	2084mm
3 + 0	686mm	2074mm	2134mm	2054mm	2084mm
3 + 0	762mm	2302mm	2362mm	2054mm	2084mm
3 + 0	838mm	2530mm	2590mm	2054mm	2084mm
3 + 1	686mm	2765mm	2825mm	2054mm	2084mm
3 + 1	762mm	3069mm	3129mm	2054mm	2084mm
3 + 1	838mm	3373mm	3433mm	2054mm	2084mm
3 + 2	686mm	3454mm	3514mm	2054mm	2084mm
3 + 2	762mm	3834mm	3894mm	2054mm	2084mm
3 + 2	838mm	4214mm	4274mm	2054mm	2084mm
3 + 3	686mm	4143mm	4203mm	2054mm	2084mm
3 + 3	762mm	4599mm	4659mm	2054mm	2084mm
3 + 3	838mm	5055mm	5115mm	2054mm	2084mm

Frame materials may be supplied slightly oversized for on-site cutting, please refer to cutting size.

### IMPORTANT THURFOLD INFORMATION

Please be aware that each image or PDF's for our internal folding doors show a position of a flush pull, hinges, slip bolt etc but the position of each item is very dependent on how you and your carpenter decide the doors should open.

There will be occasions when you may decide that the flush pull is better fitted in the centre of the middle door for a 3 door set or indeed a latch handle is fitted on the main opening door, you may also decide that you do not want to fit the slip bolt - each and every decision is yours to make - just decide before fitting any of the above items.

The small door stops (25x12mm) for some of the configurations will have to be "offset" so one leg allows the main door to close against it in a traditional manner whereas the same door stop will be fitted on the opposite side at the other frame leg.

Walnut veneered doors are supplied with white primed frames and associated material, walnut veneered frames are not available but we could supply unfinished oak frames at an extra cost to allow you to stain them.

Unfinished and prefinished oak veneer doors are supplied with unfinished oak veneer frames and associated material.

White primed, white painted or coloured doors (Grey/Ivory/Laminates etc) are supplied with white primed frames and associated material.

Please be prepared to locally source readily available screw fixings for the systems.

Any mention of pre-finished, pre-finishing or fully varnished refers to the door alone.

Please note that we may use narrower doors for some sizes of this product whether panelled or glazed, they may have narrower panels or glass than the image shown, this is because the timber sections that make up the doors construction remain the same size across the full range of door sizes.

## FOLDING HARDWARE PACK CONTENTS

2 + 0

Product	Quantity
Aluminium Top Track	1
Pivot Set	1
2 Wheel Hanger	1
4 Wheel Hanger	0
Hinges (3 per pack)	1 pack
Surface Bolt	1

2 + 1

Product	Quantity
Aluminium Top Track	1
Pivot Set	2
2 Wheel Hanger	2
4 Wheel Hanger	0
Hinges (3 per pack)	1 pack
Surface Bolt	2

2 + 2

Product	Quantity
Aluminium Top Track	1
Pivot Set	2
2 Wheel Hanger	2
4 Wheel Hanger	0
Hinges (3 per pack)	2 packs
Surface Bolt	2

3 + 0

Product	Quantity
Aluminium Top Track	1
Pivot Set	1
2 Wheel Hanger	0
4 Wheel Hanger	1
Hinges (3 per pack)	2 packs
Surface Bolt	1

3 + 1

Product	Quantity
Aluminium Top Track	1
Pivot Set	2
2 Wheel Hanger	0
4 Wheel Hanger	1
Hinges (3 per pack)	2 packs
Surface Bolt	2

## FOLDING HARDWARE PACK CONTENTS

3 + 2

Product	Quantity
Aluminium Top Track	1
Pivot Set	2
2 Wheel Hanger	1
4 Wheel Hanger	1
Hinges (3 per pack)	3 packs
Surface Bolt	2

3 + 3

Product	Quantity
Aluminium Top Track	1
Pivot Set	2
2 Wheel Hanger	0
4 Wheel Hanger	2
Hinges (3 per pack)	4 packs
Surface Bolt	2

### IMPORTANT

Please note: You can only assemble these door configurations by using the frame provided. Your warranty will be invalid if other alternatives are used.

All loads are taken by the top track to ensure smooth, light operation and long life.

Prior to installing this doorset, inspect for damage and do not proceed to fit if any noticeable damage or defect is evident. This doorset should be stored in a dry flat location before installation.

### CAUTION



**SAFETY:** This product needs to be installed by a competent tradesperson with assistance. Two people are required to carry out the installation, as some components are heavy.

The outer frame requires fixing to the supporting structure above the opening.

The opening **MUST** be capable of carrying the load of the doorset in all conditions.

### IMPORTANT NOTE:

If the width of the doors require trimming, please ensure that all trimming is made equal. For instance: to reduce a 3 door set by 18mm width, 3mm should be taken off **each side** of **ALL** doors within that set, to ensure that all doors have an equal width after trimming. Not trimming uniformly could affect the running gear and cause problems operating the set.

SECTION A-A

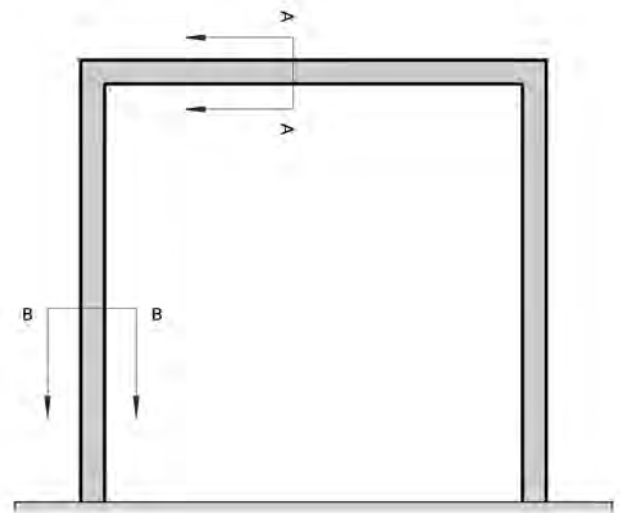
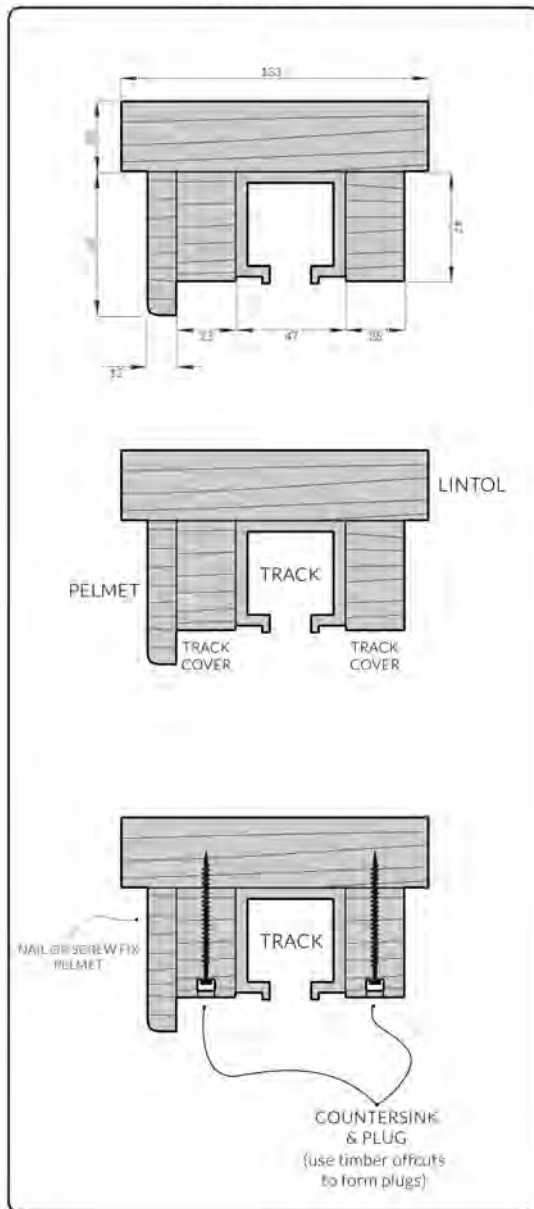

SECTION B-B

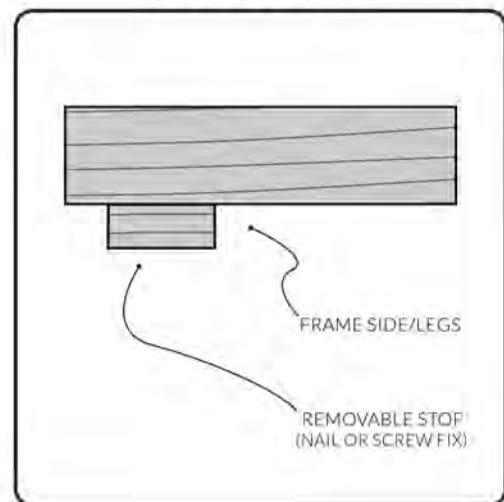

FRAME MUST BE PERFECTLY ALIGNED ON ALL THREE AXIS

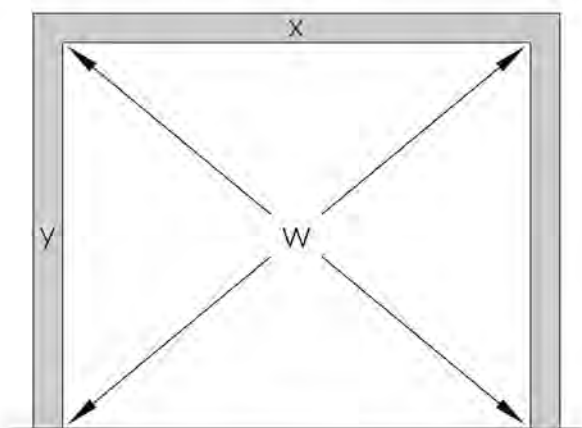

FRONT VIEW



SIDE VIEW

X: horizontal. Y: vertical. Z: lateral = all must be true  
W = must be perfectly symmetrical/square

# 3 POSSIBLE OPTIONS FOR JOINING FRAME SECTIONS

All frame legs & lintols supplied longer for site trimming.

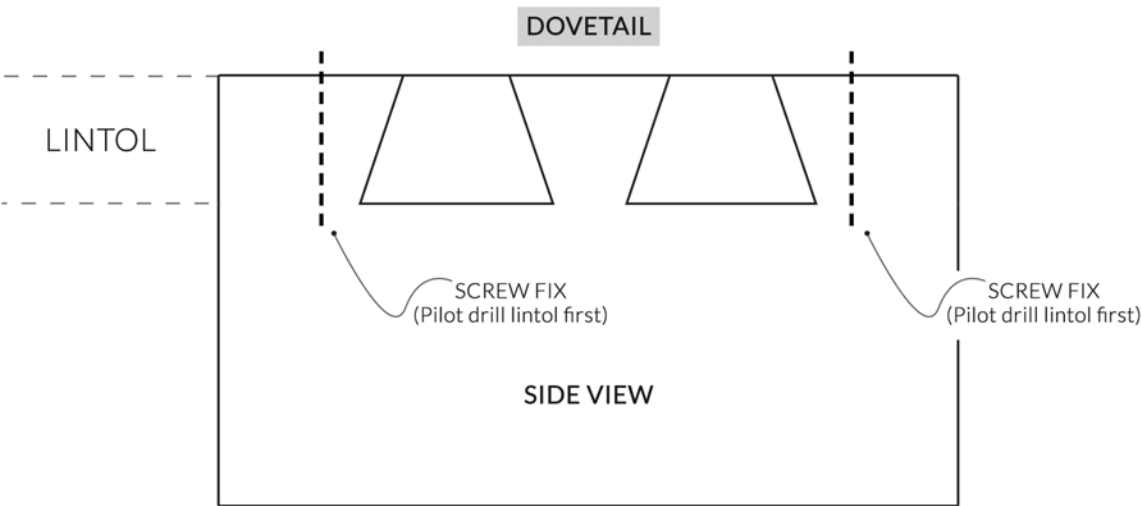
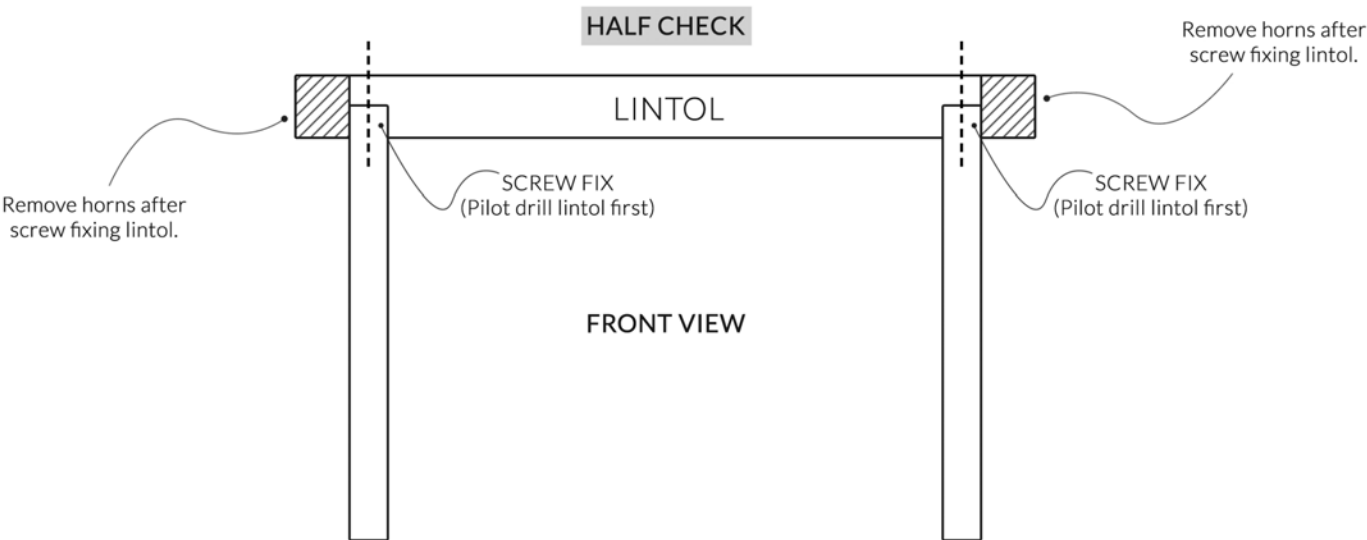
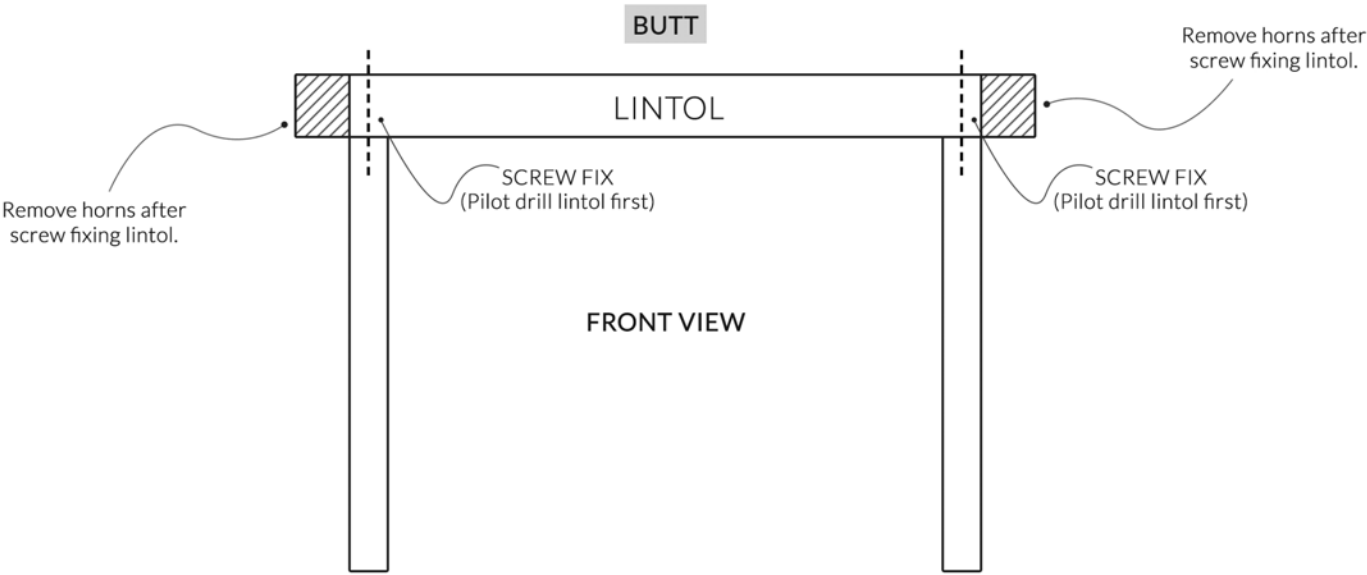

## DOOR CONFIGURATION OPTIONS

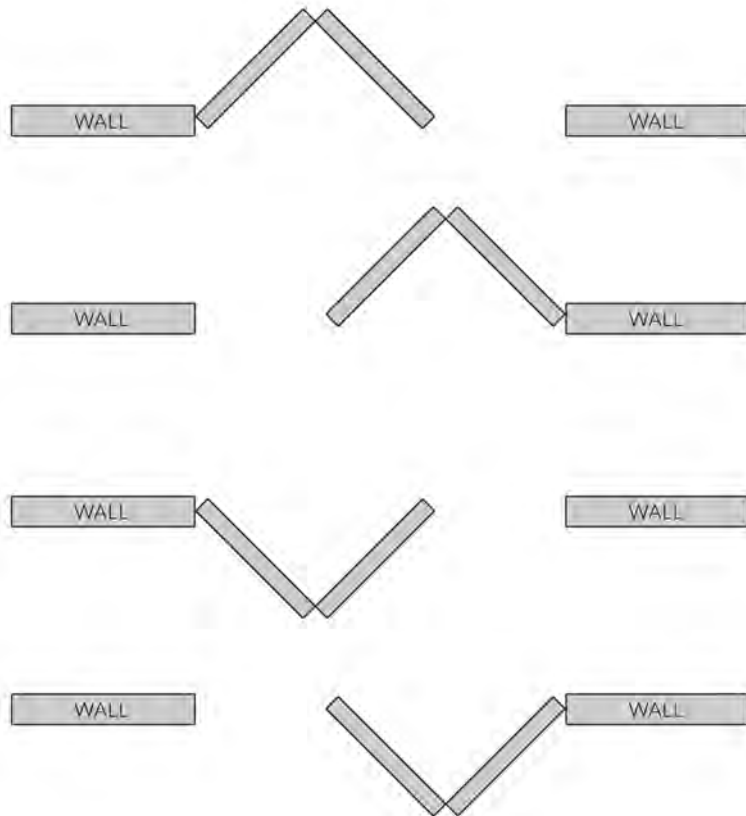

## DOOR HARDWARE ORIENTATION

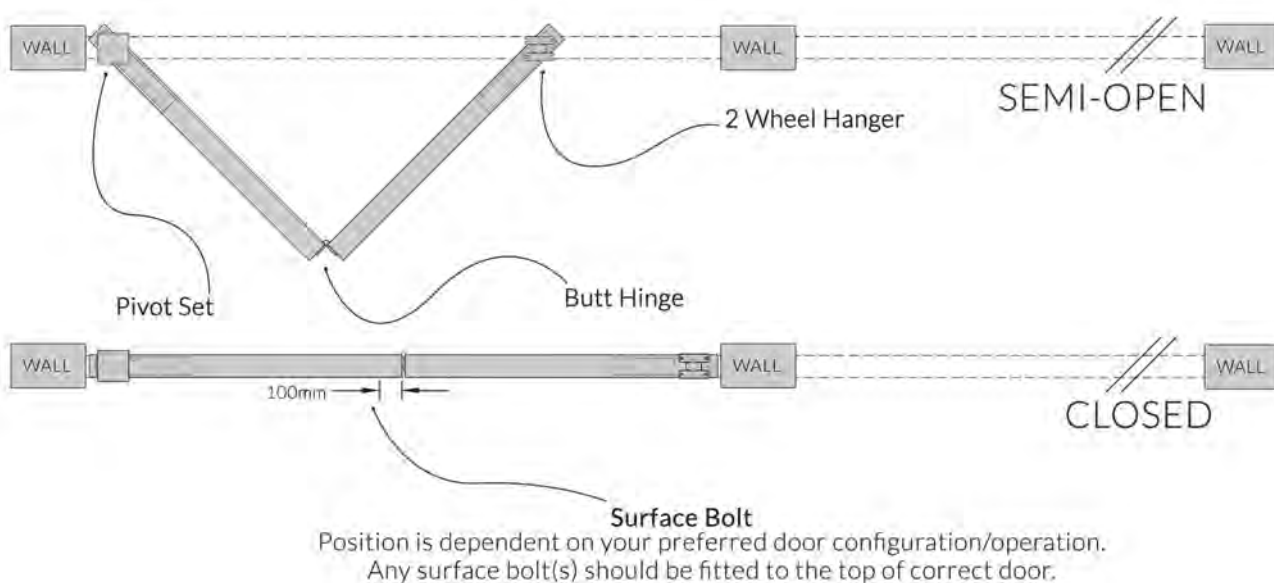

## DOOR CONFIGURATION OPTIONS

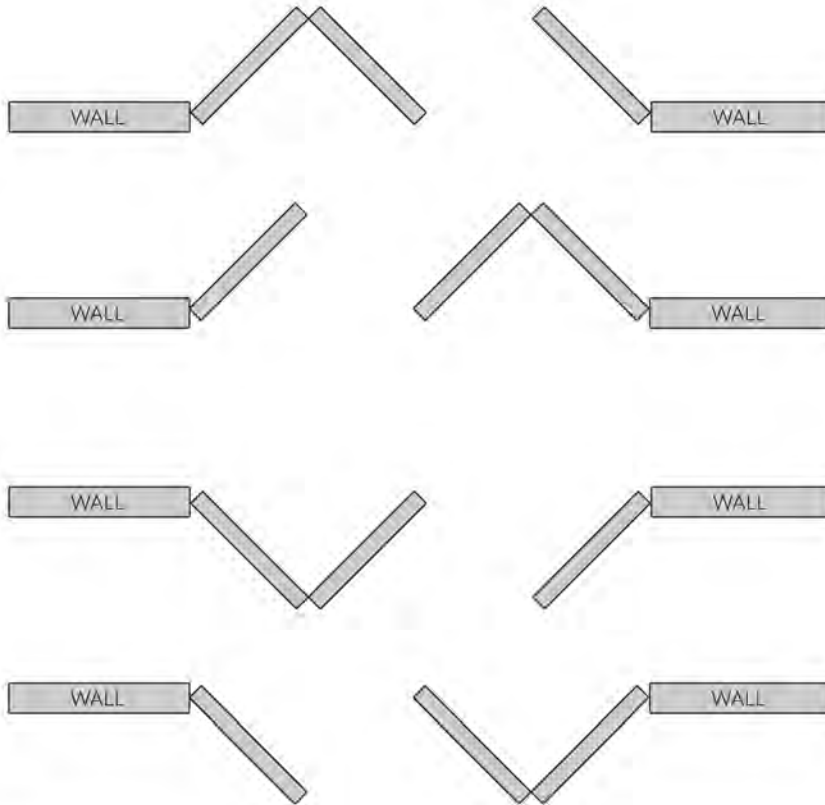

## DOOR HARDWARE ORIENTATION

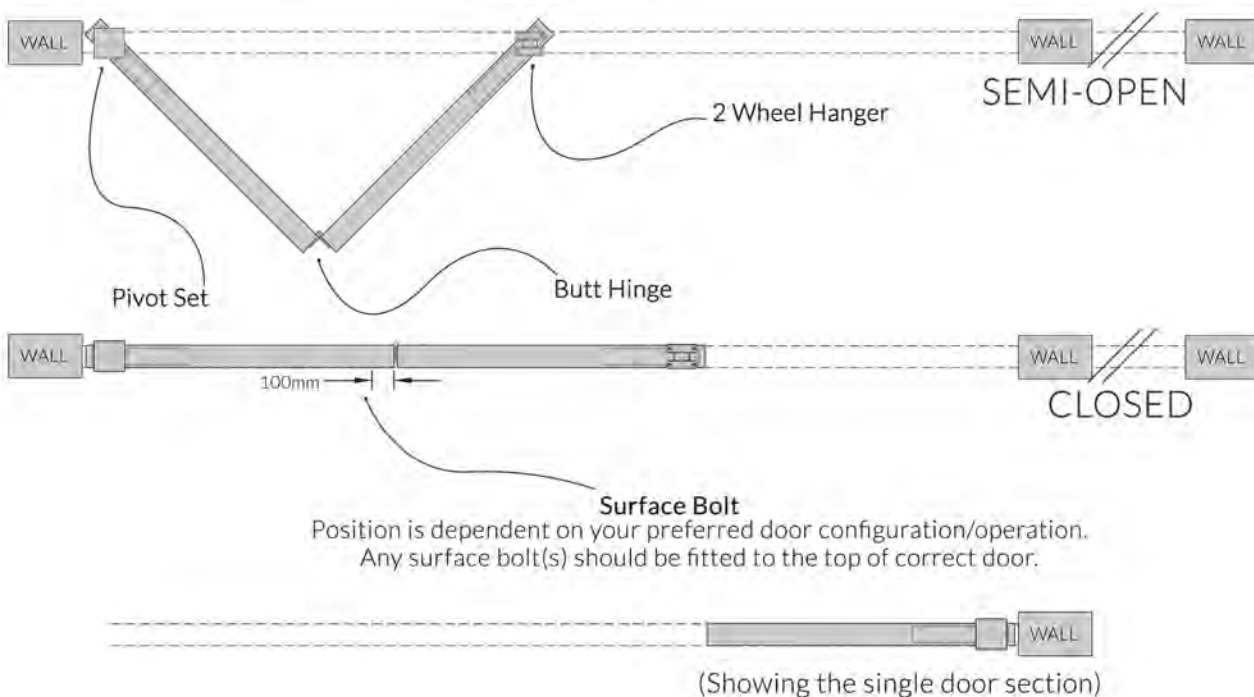



## DOOR CONFIGURATION OPTIONS

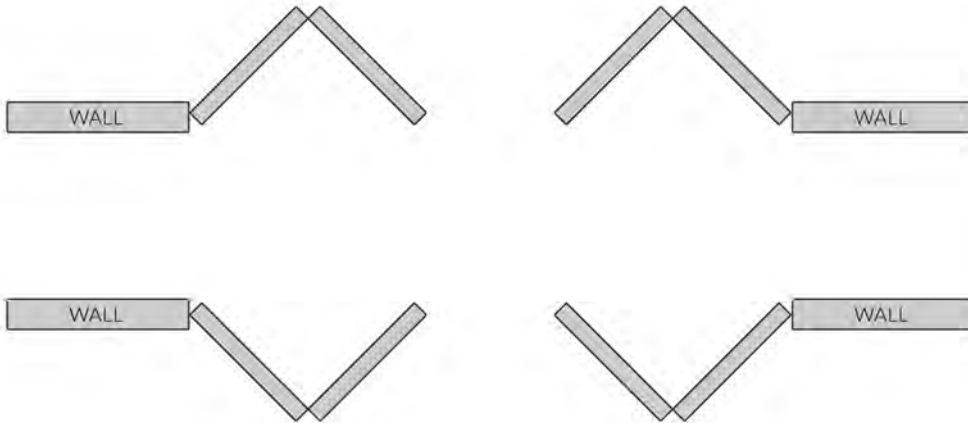

## DOOR HARDWARE ORIENTATION

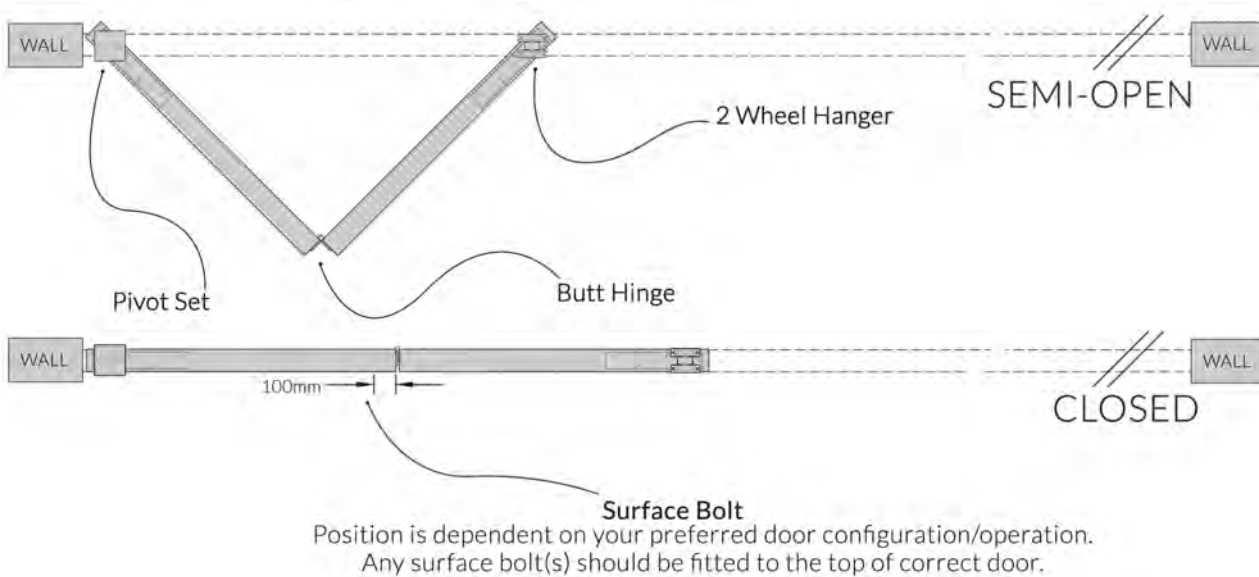

(Images showing half of the full set)

## DOOR CONFIGURATION OPTIONS

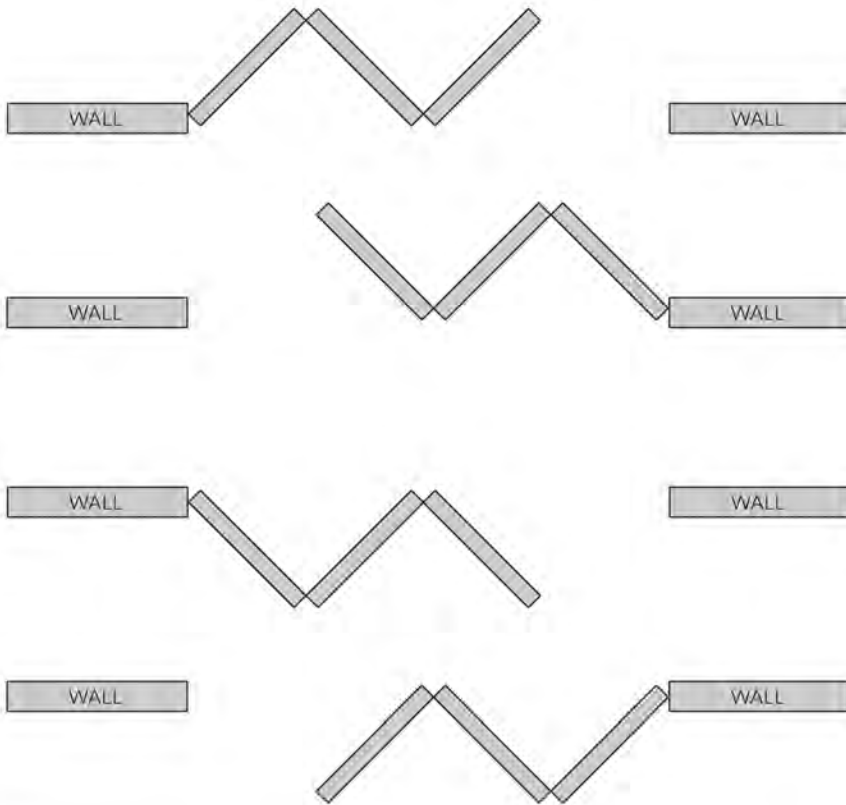

## DOOR HARDWARE ORIENTATION

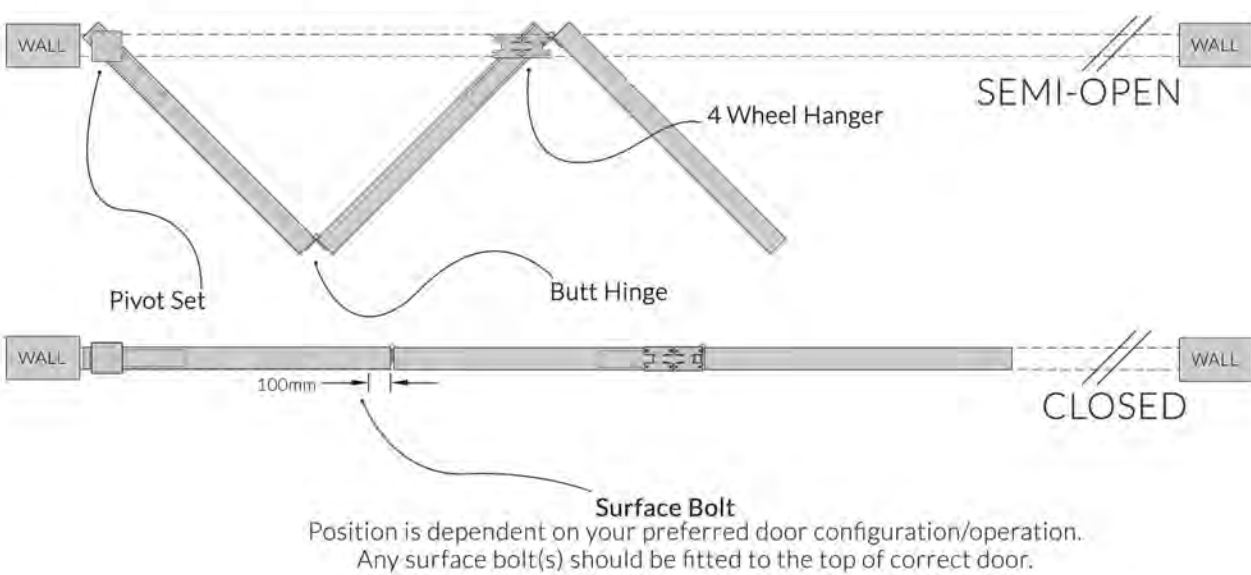

# 3 + 1 DOOR CONFIGURATION

## DOOR CONFIGURATION OPTIONS

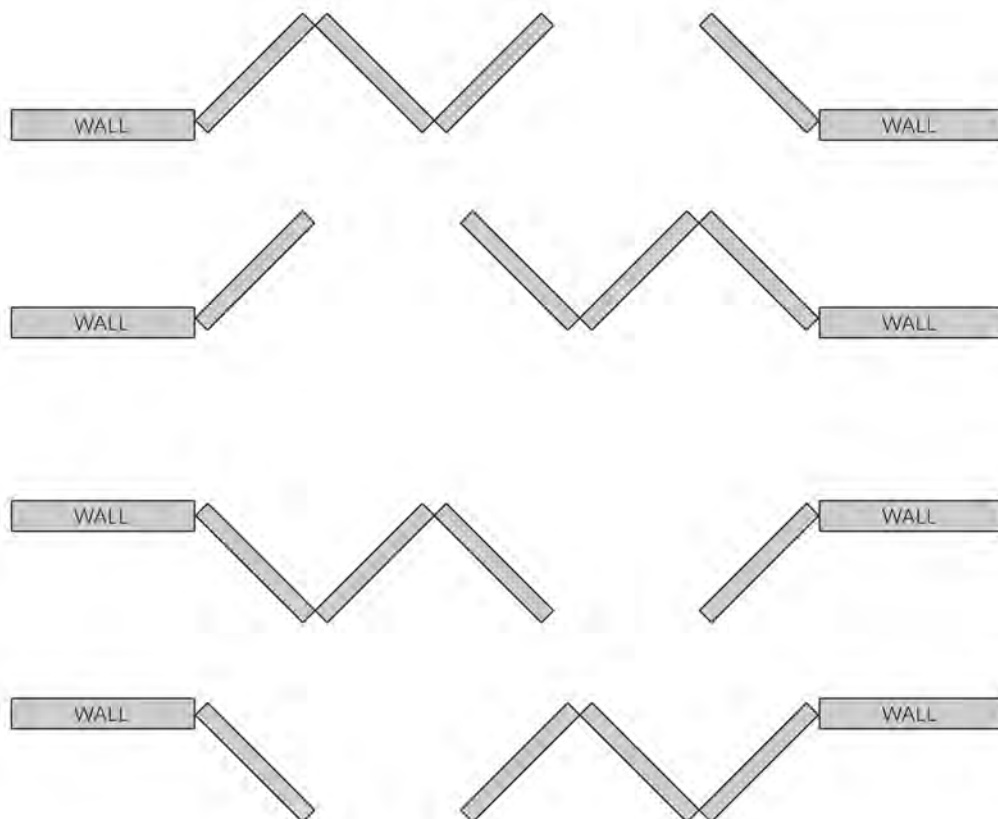

## DOOR HARDWARE ORIENTATION

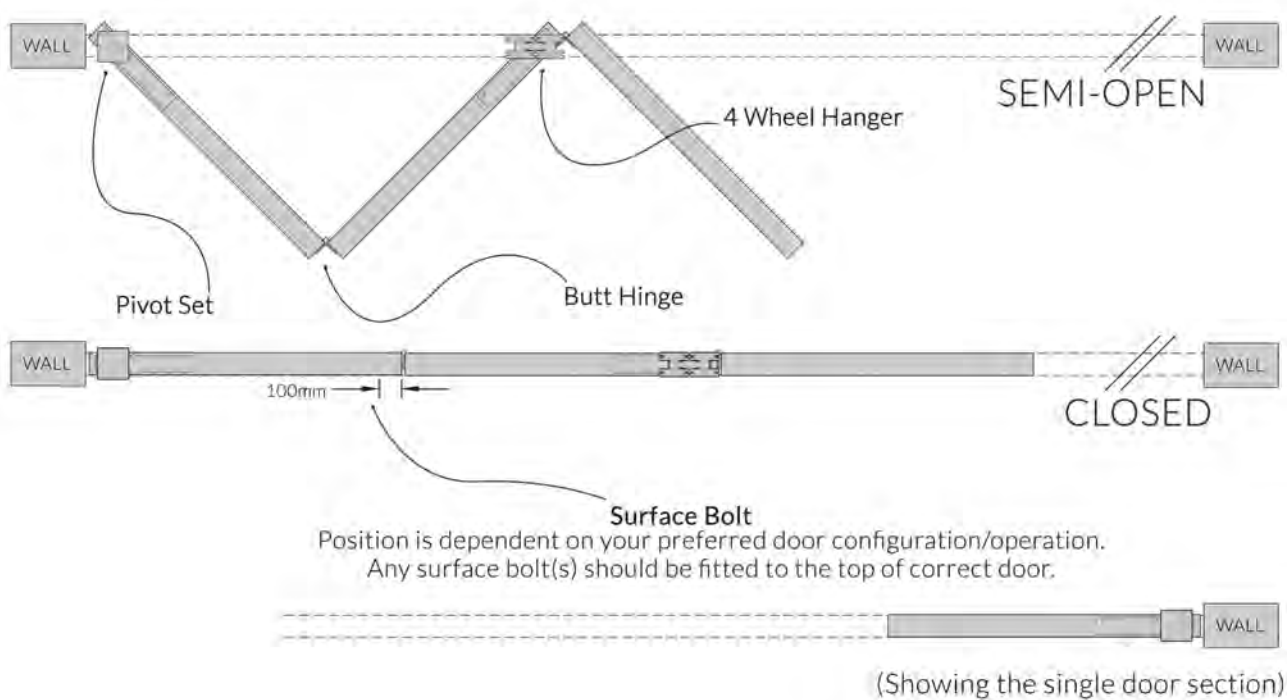

# 3 + 2 DOOR CONFIGURATION

## DOOR CONFIGURATION OPTIONS

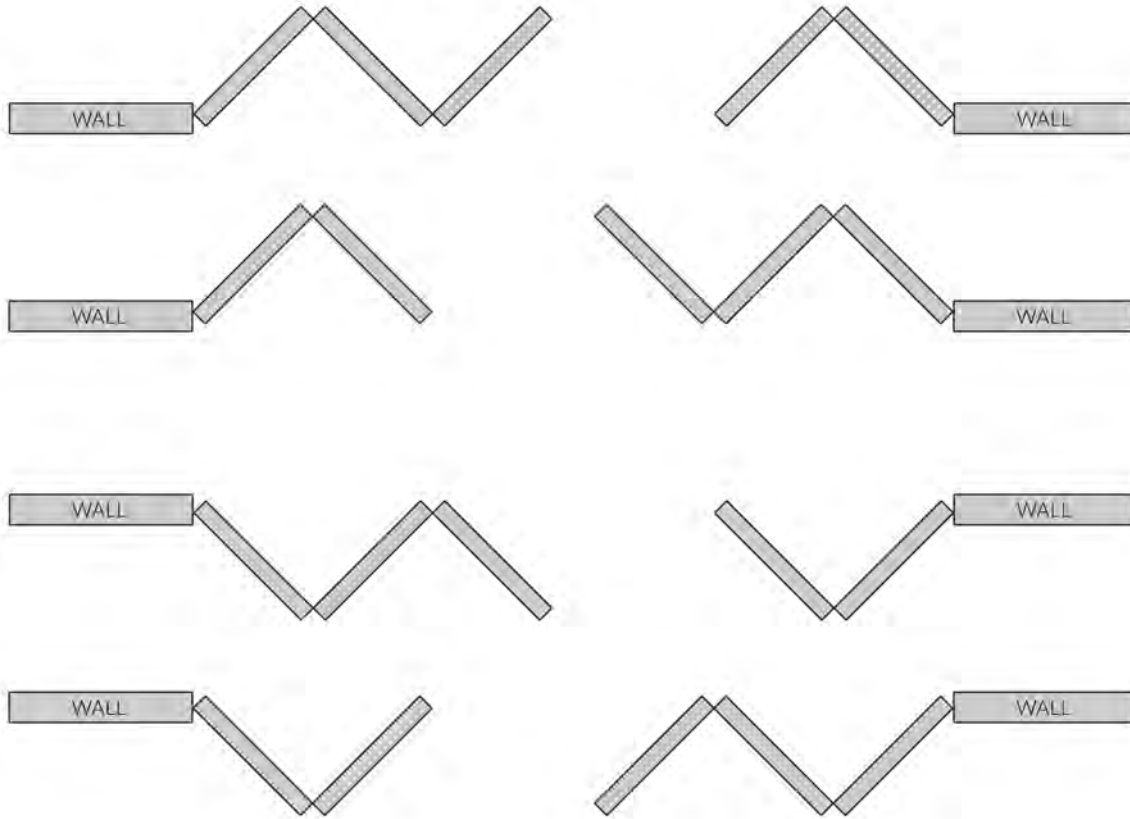

## DOOR HARDWARE ORIENTATION

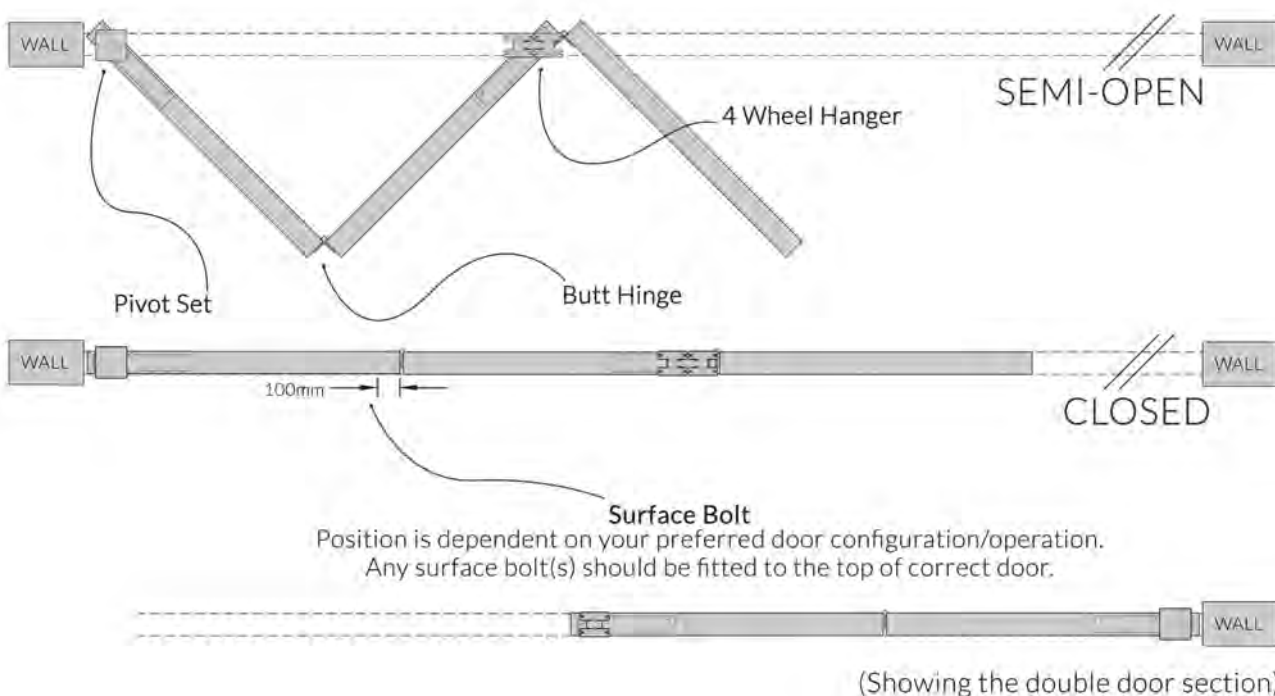

## 3 + 3 DOOR CONFIGURATION

### DOOR CONFIGURATION OPTIONS

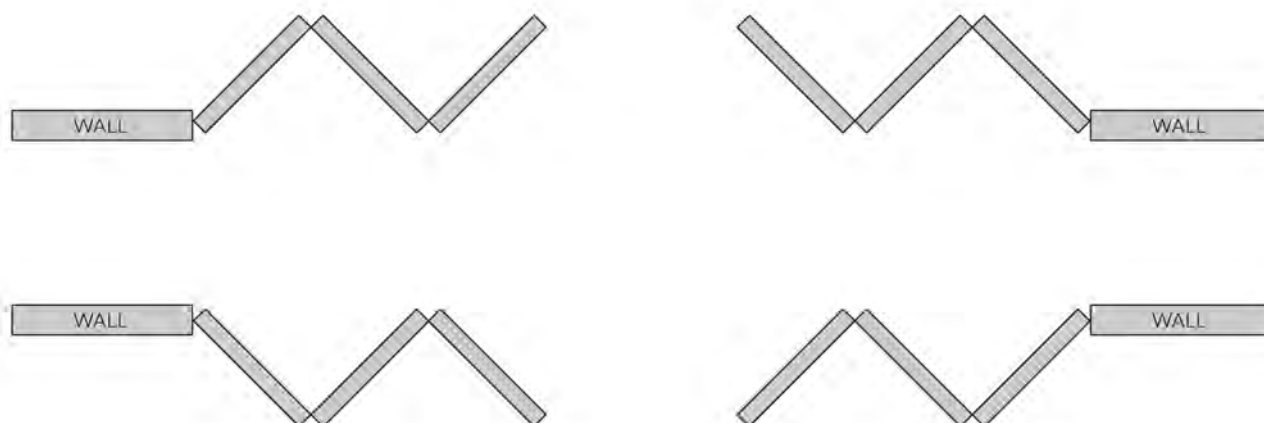

### DOOR HARDWARE ORIENTATION

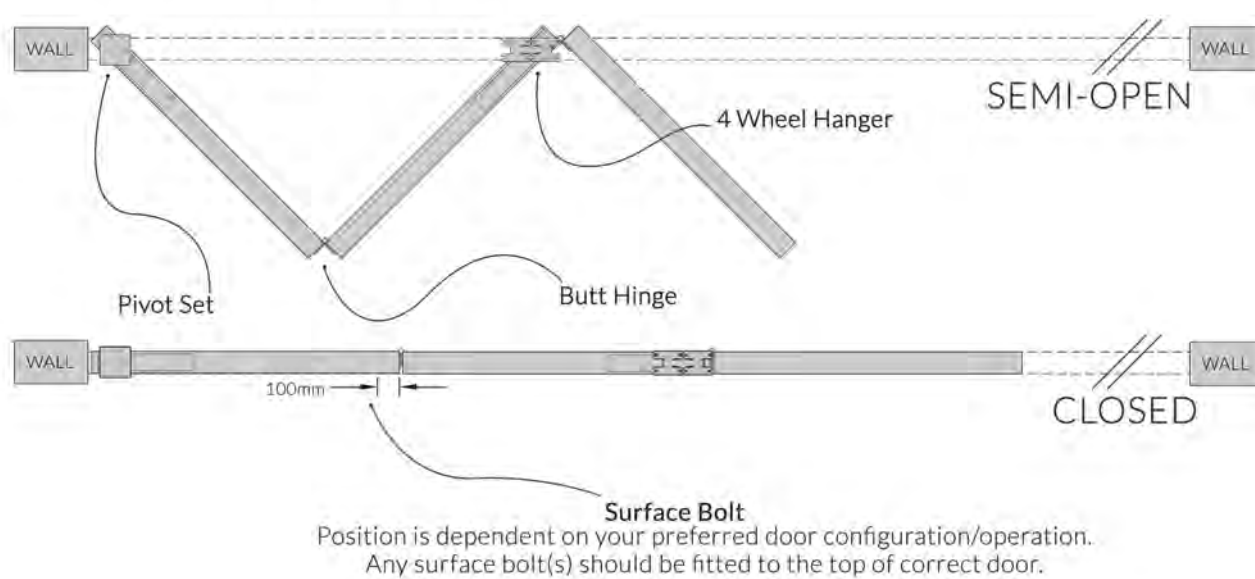

(Images showing half of the full set)

## SECTION A-A

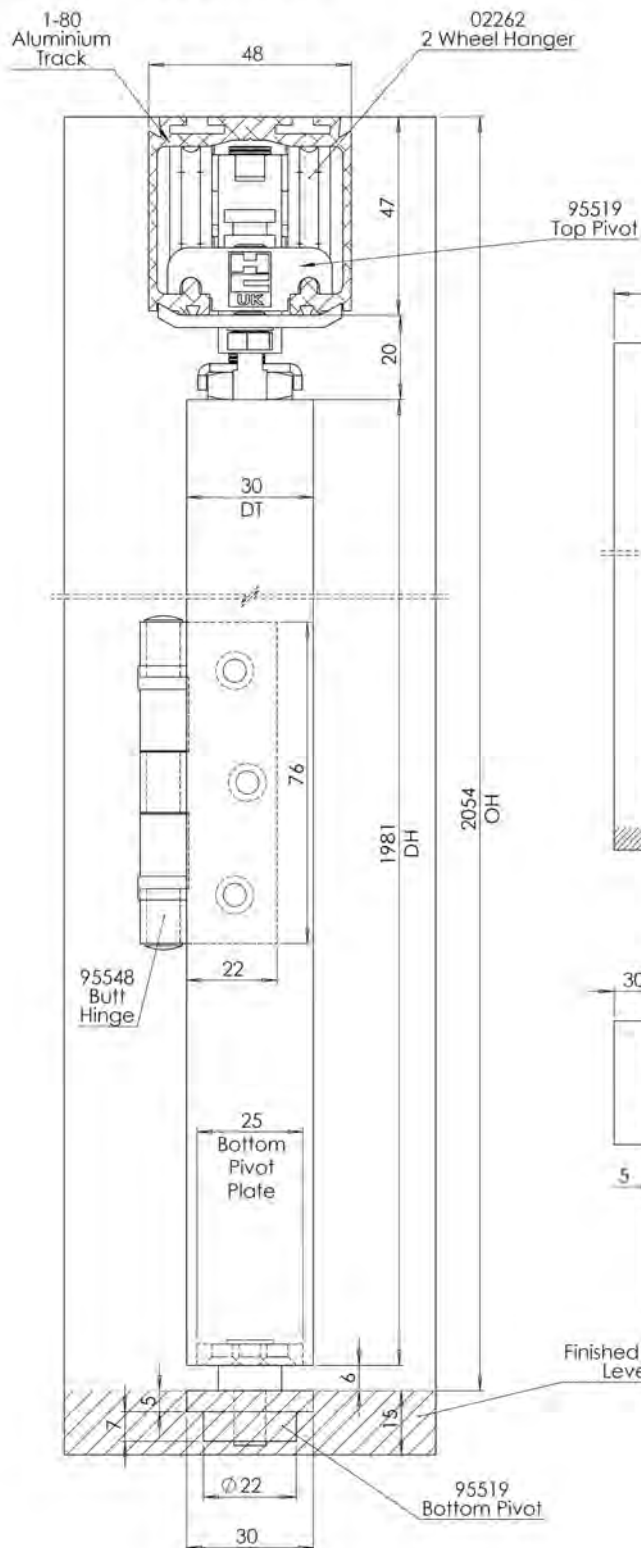

Front View

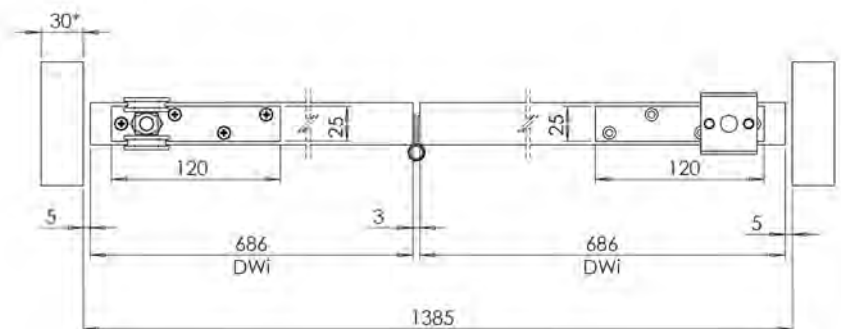
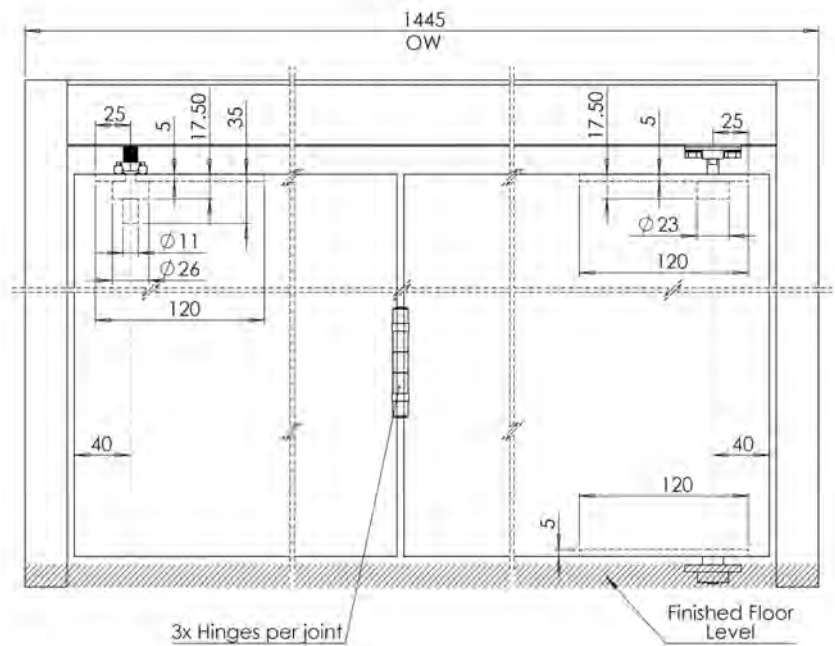

Maximum door weight 50kg  
 DH - Door height, maximum door height 3000mm  
 DWi - Door width, maximum 850mm  
 DT - Door thickness between 30mm and 50mm  
 OW - Opening width  
 OH - Opening height  
 \* - Recommended value

## SECTION A-A

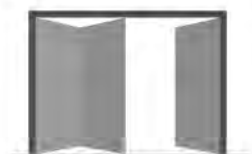
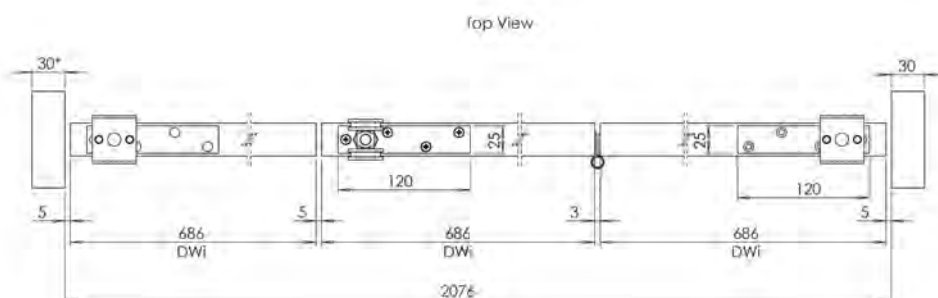
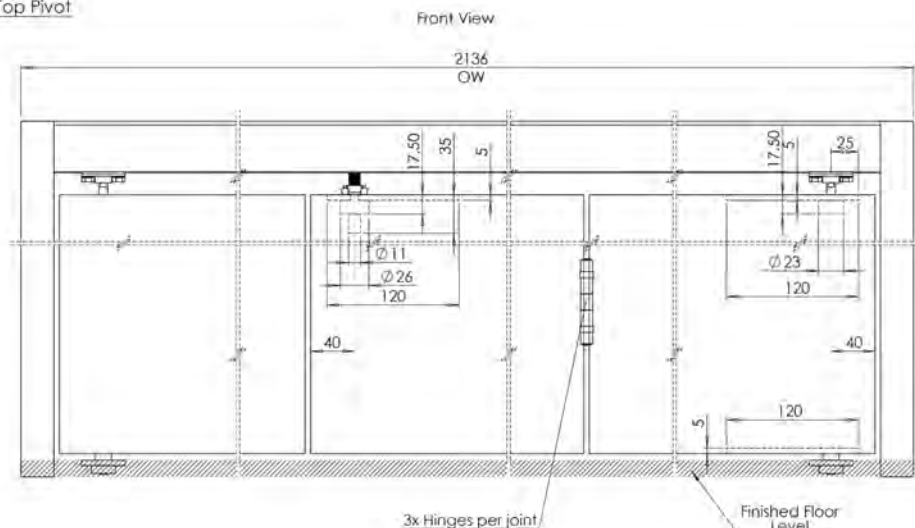
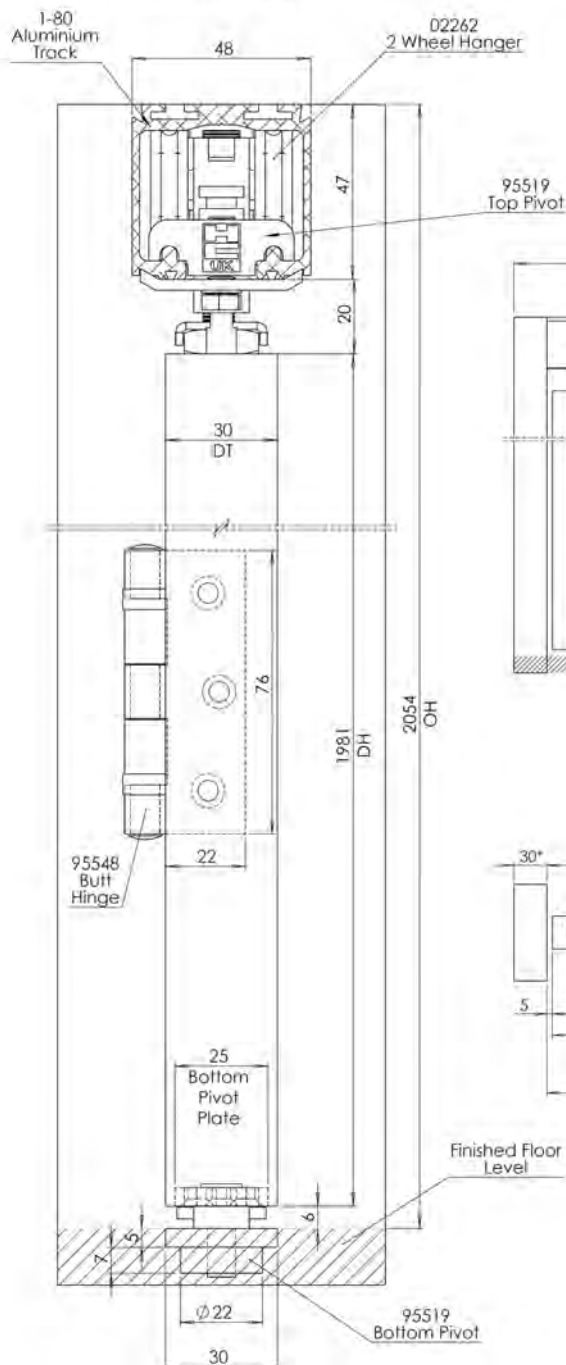

Maximum door weight 50kg  
 DH - Door height, maximum door height 3000mm  
 DWi - Door width, maximum 850mm  
 DT - Door thickness between 30mm and 50mm  
 OW - Opening width  
 OH - Opening height  
 \* - Recommended value

## SECTION A-A

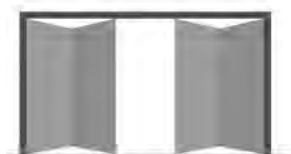
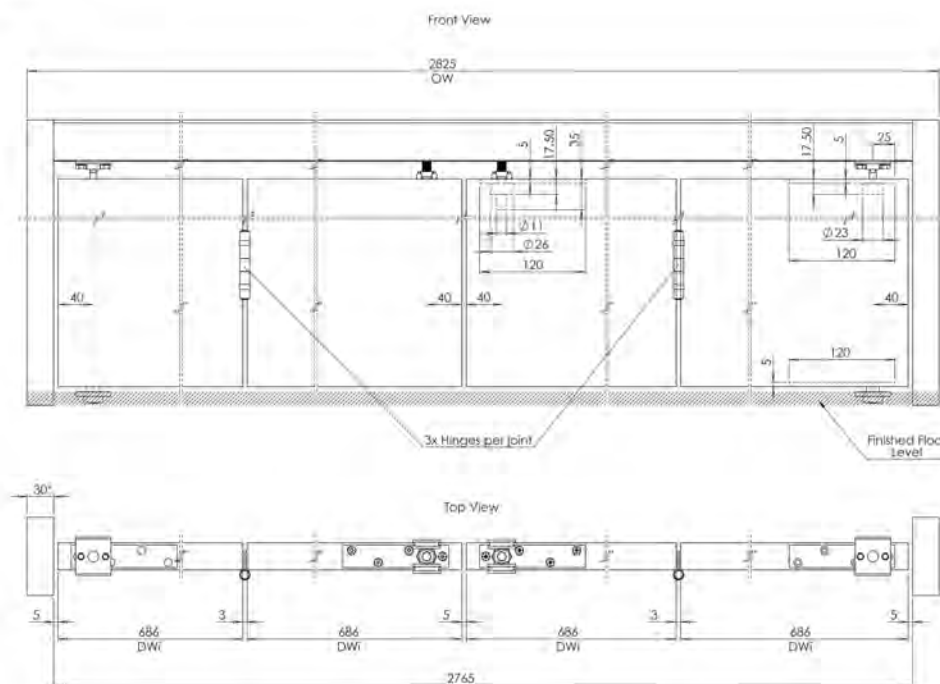
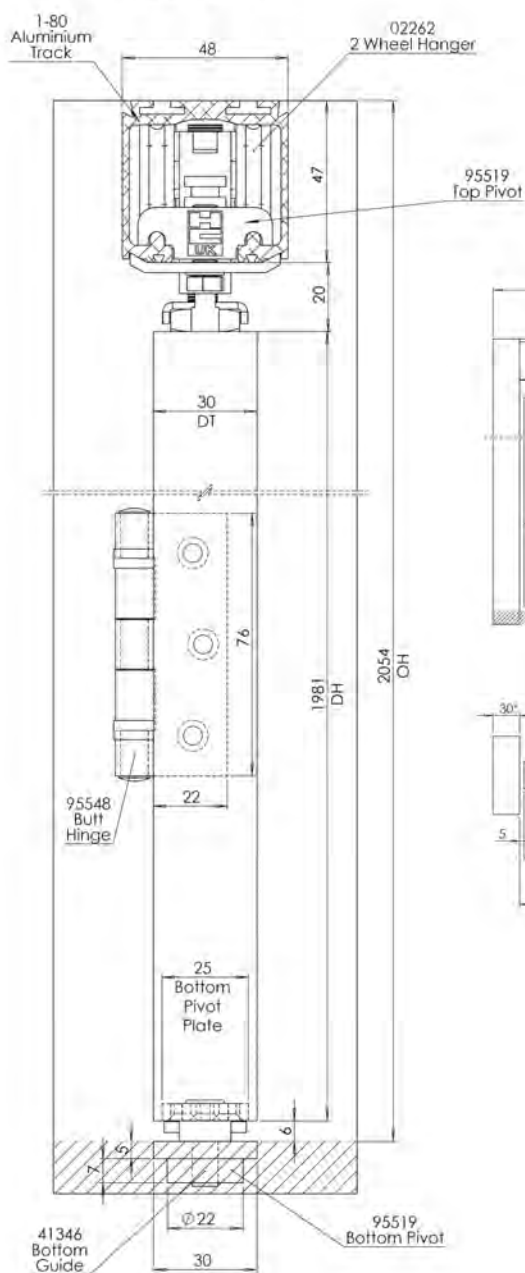

Maximum door weight 50kg  
 DH - Door height, maximum door height 3000mm  
 DWi - Door width, maximum 850mm  
 DT - Door thickness between 30mm and 50mm  
 OW - Opening width  
 OH - Opening height  
 \* - Recommended value



## SECTION A-A

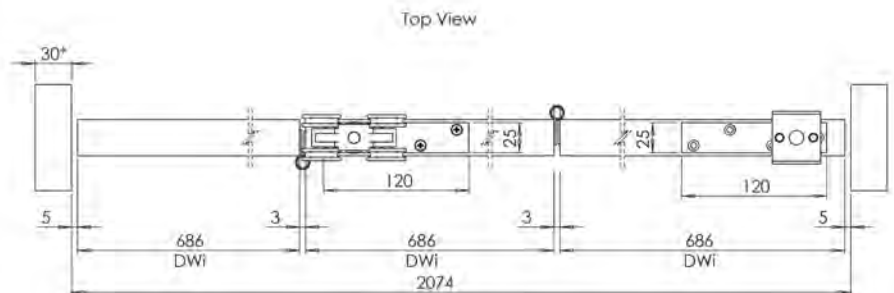
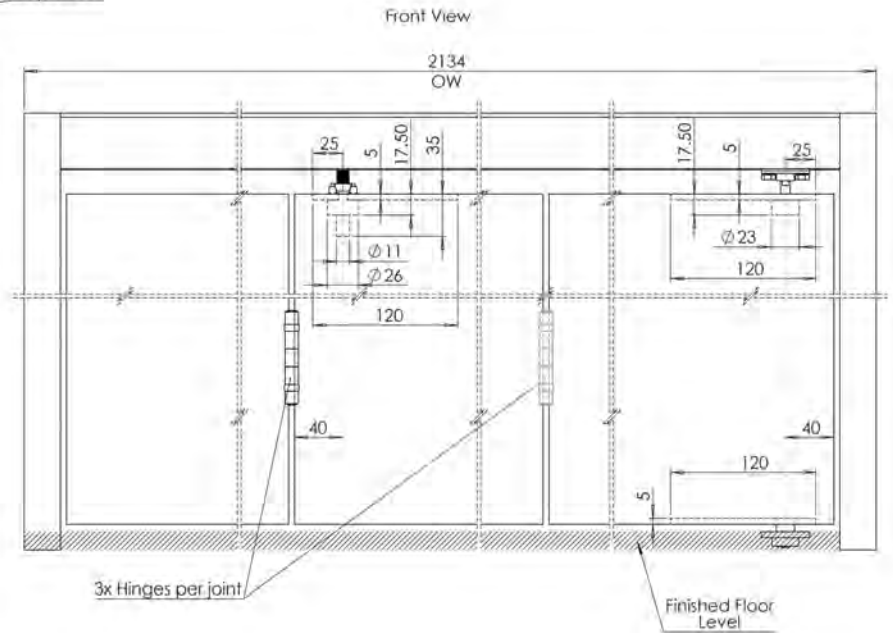
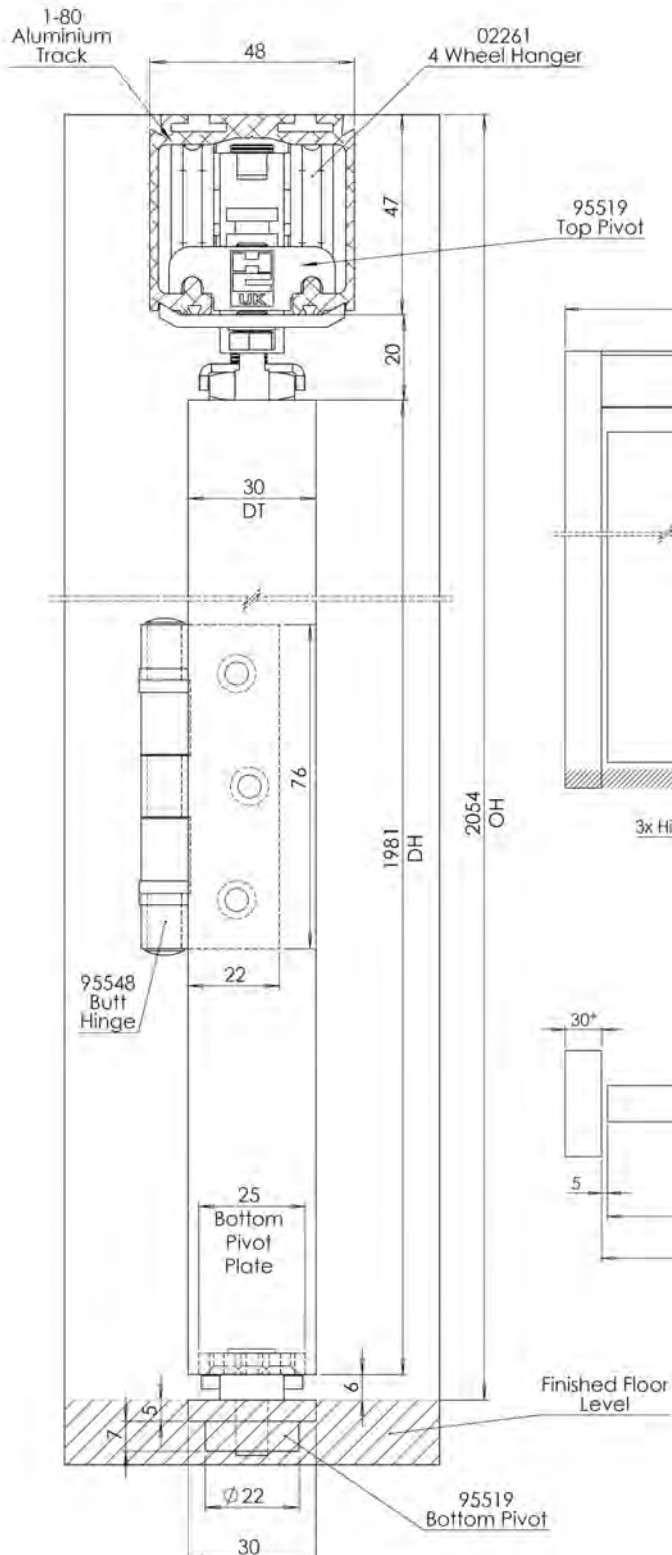

Maximum door weight 50kg  
 DH - Door height, maximum door height 3000mm  
 DWI - Door width, maximum 850mm  
 DT - Door thickness between 30mm and 50mm  
 OW - Opening width  
 OH - Opening height  
 \* - Recommended value

## SECTION A-A

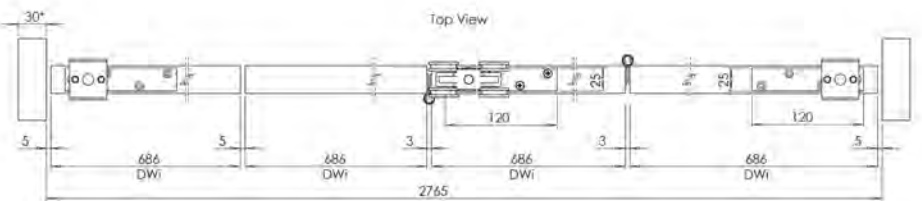
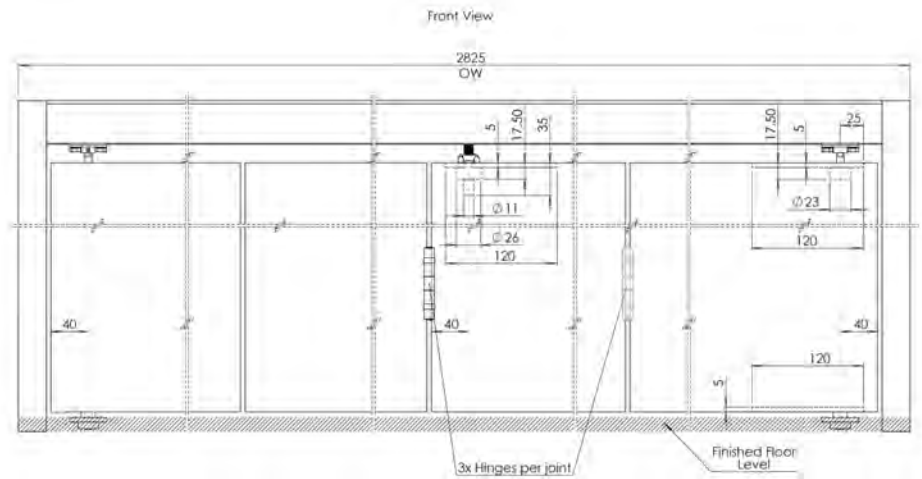
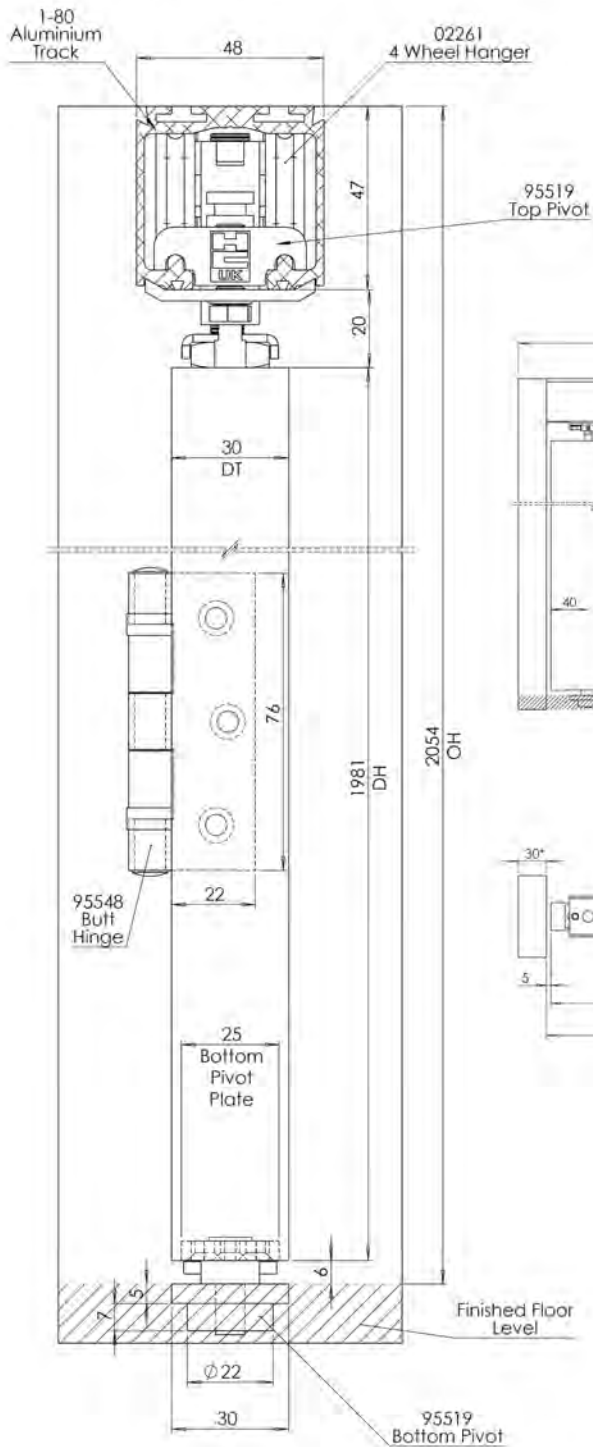

Maximum door weight 50kg  
 DH - Door height, maximum door height 3000mm  
 DWi - Door width, maximum 850mm  
 DT - Door thickness between 30mm and 50mm  
 OW - Opening width  
 OH - Opening height  
 \* - Recommended value

## SECTION A-A

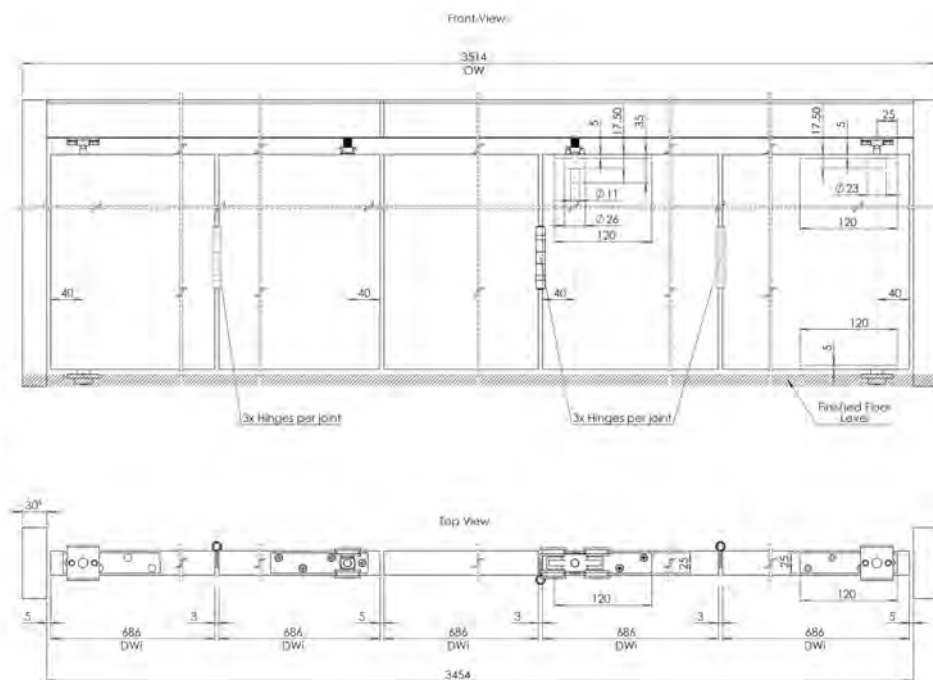
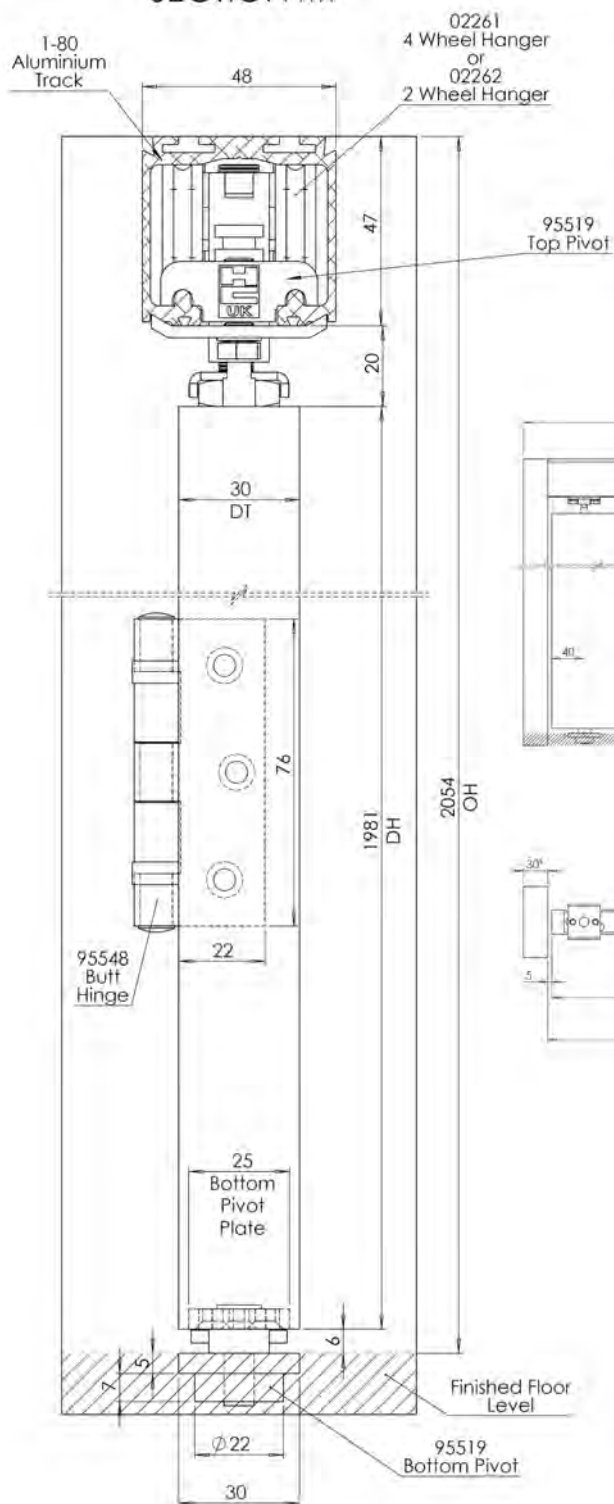

Maximum door weight 50kg  
 DH - Door height, maximum door height 3000mm  
 DWI - Door width, maximum 850mm  
 DT - Door thickness between 30mm and 50mm  
 OW - Opening width  
 OH - Opening height  
 \* - Recommended value

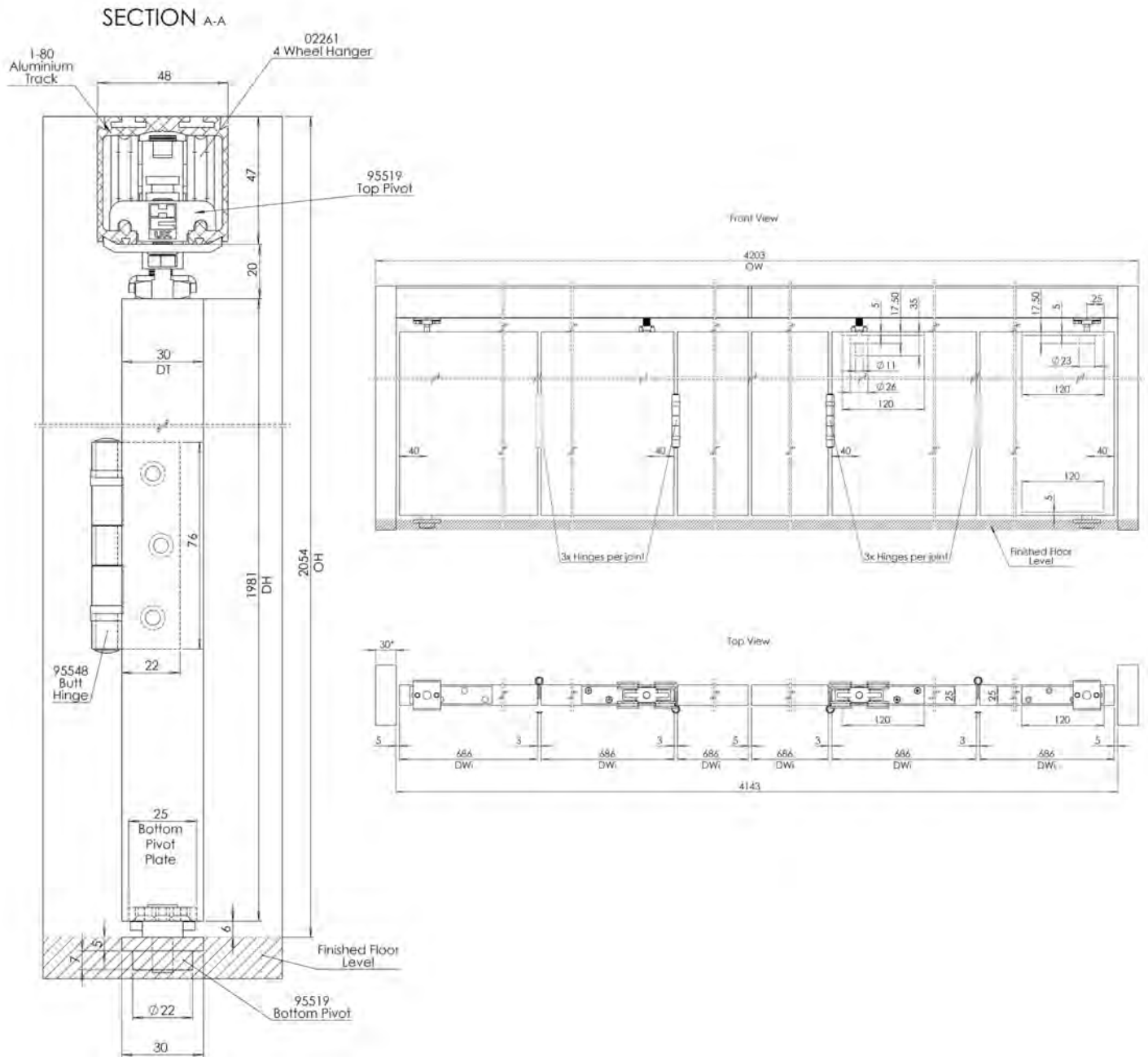

Maximum door weight 50kg  
 DH - Door height, maximum door height 3000mm  
 DWI - Door width, maximum 850mm  
 DT - Door thickness between 30mm and 50mm  
 OW - Opening width  
 OH - Opening height

## SURFACE BOLT SPECIFICATIONS

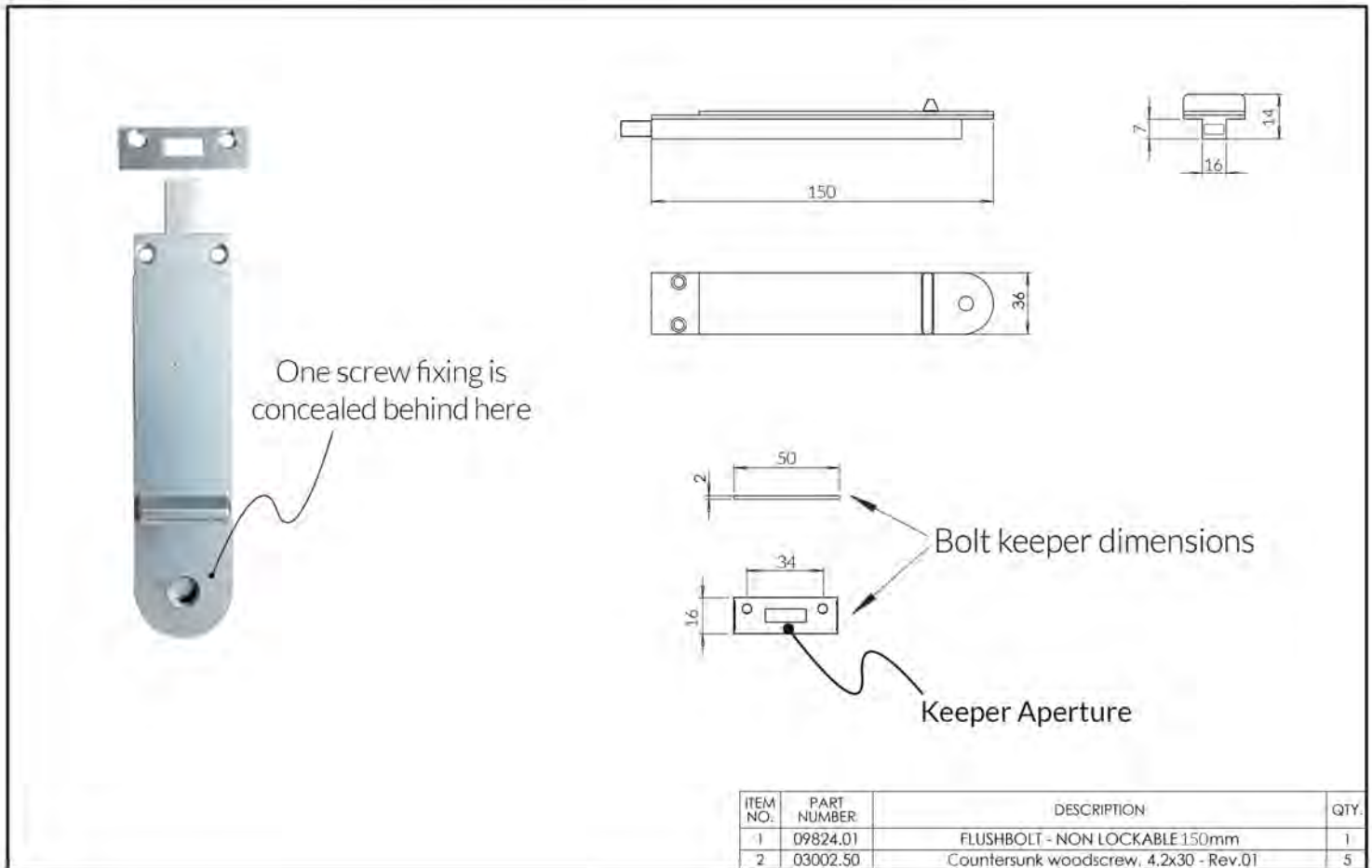

### Bolt Positioning:

#### Bottom of Door Advice (**Preferred Method**) :

When fitting bolts to the bottom of the door be aware that the floor will need a recess cut to accommodate the bolt keeper, wooden floors are the easiest to recess, other floors depending on floor type may need you to obtain rawl plugs and a decision whether to recess the bolt keeper or fit it on the surface of the floor.

#### Top of Door Advice:

When fitting bolts to the top of the door be aware that the top channel will need drilling to form a keeper aperture in the top track.

Additionally, using the supplied bolt keeper will require screw holes, any surface fixed keeper screws should then be fitted, removed and the thread cut so that the screws do not project into the track channel when the screws are refitted - leaving the screws at their full length will damage the running gear when in operation.

# COMPONENTS



## Top & Bottom pivot assembly



4 Wheel  
intermediate  
hanger set



2 Wheel end  
hanger set



### 3 Hinge Set, SS

Maximum door weight: 50kg  
Maximum door width: 850mm  
Maximum door height: 3000mm  
Door Thickness: 30 – 50mm

Track Dimensions:  
47mm (w) x 48mm (h)

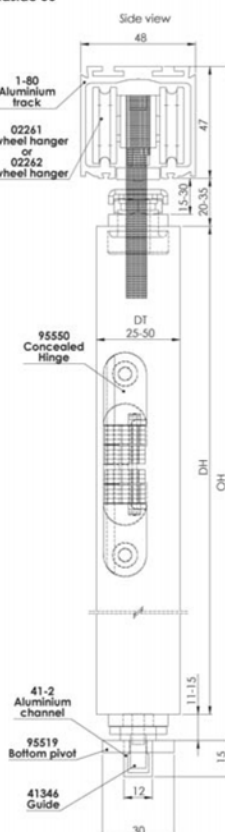

Maximum door weight 50kg  
DH - Door height, maximum door height 3000mm  
DW - Door width, maximum 850mm  
DT - Door thickness between 25mm and 50mm  
OW - Opening width  
OH - Opening height

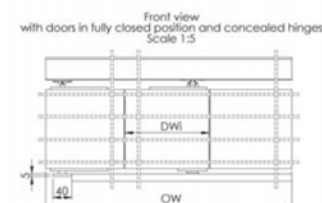
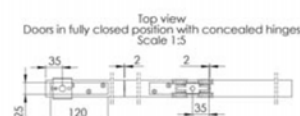
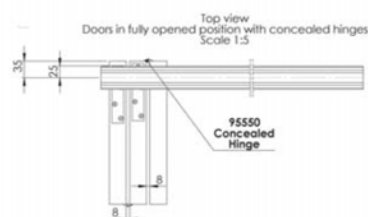
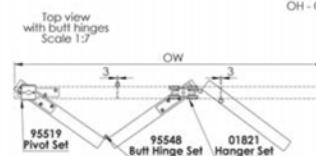

Step 1. Door preparation: cut-out for pivots.

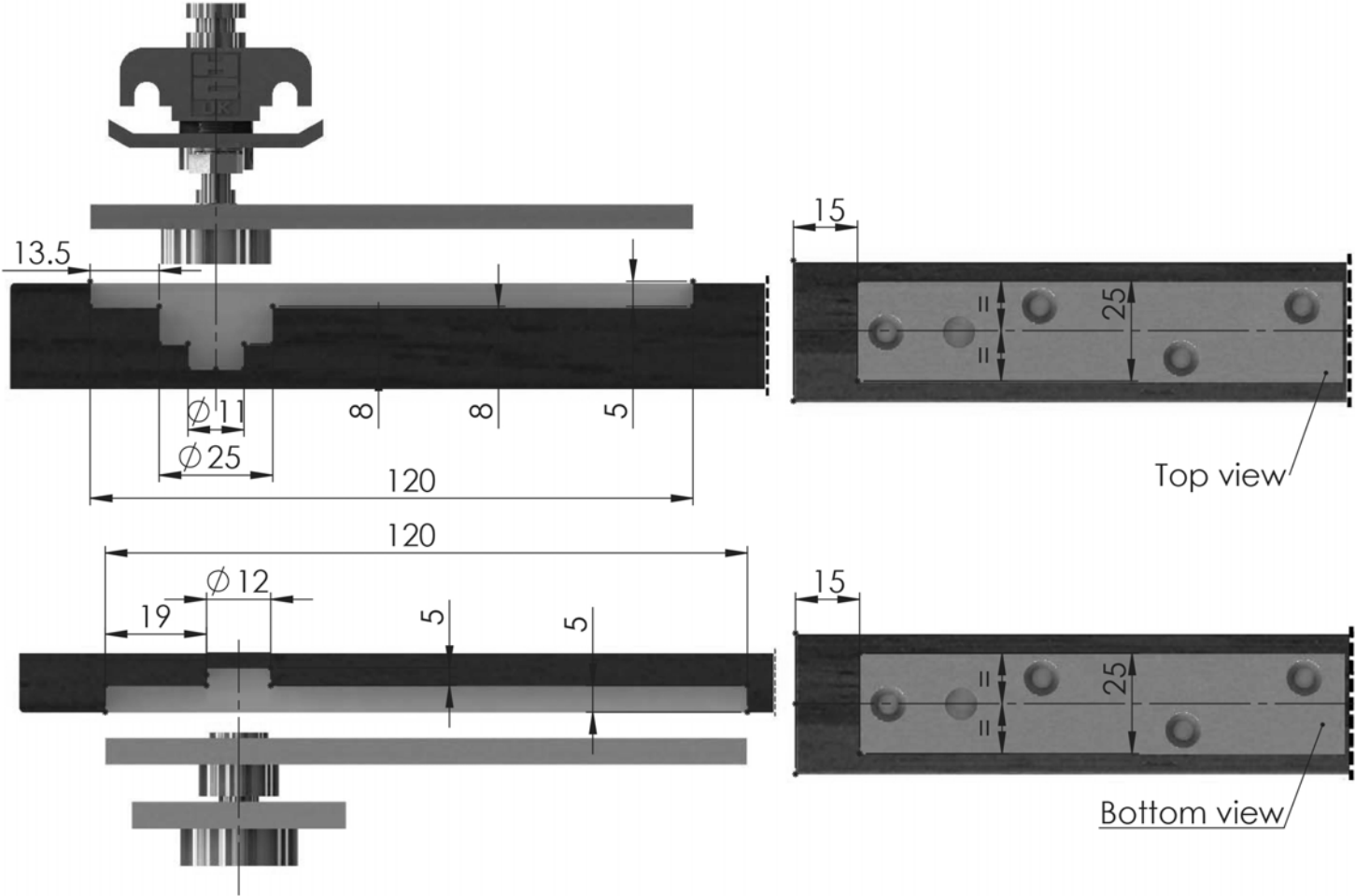

Step 2. Door preparation: cut-out for longer plate and hanger.

NOTE: Before making the routing for plates see Step 4 for door configuration

Top dimensions can be used for the 4 wheel hanger (01821) and the 2 wheel hanger (01822)

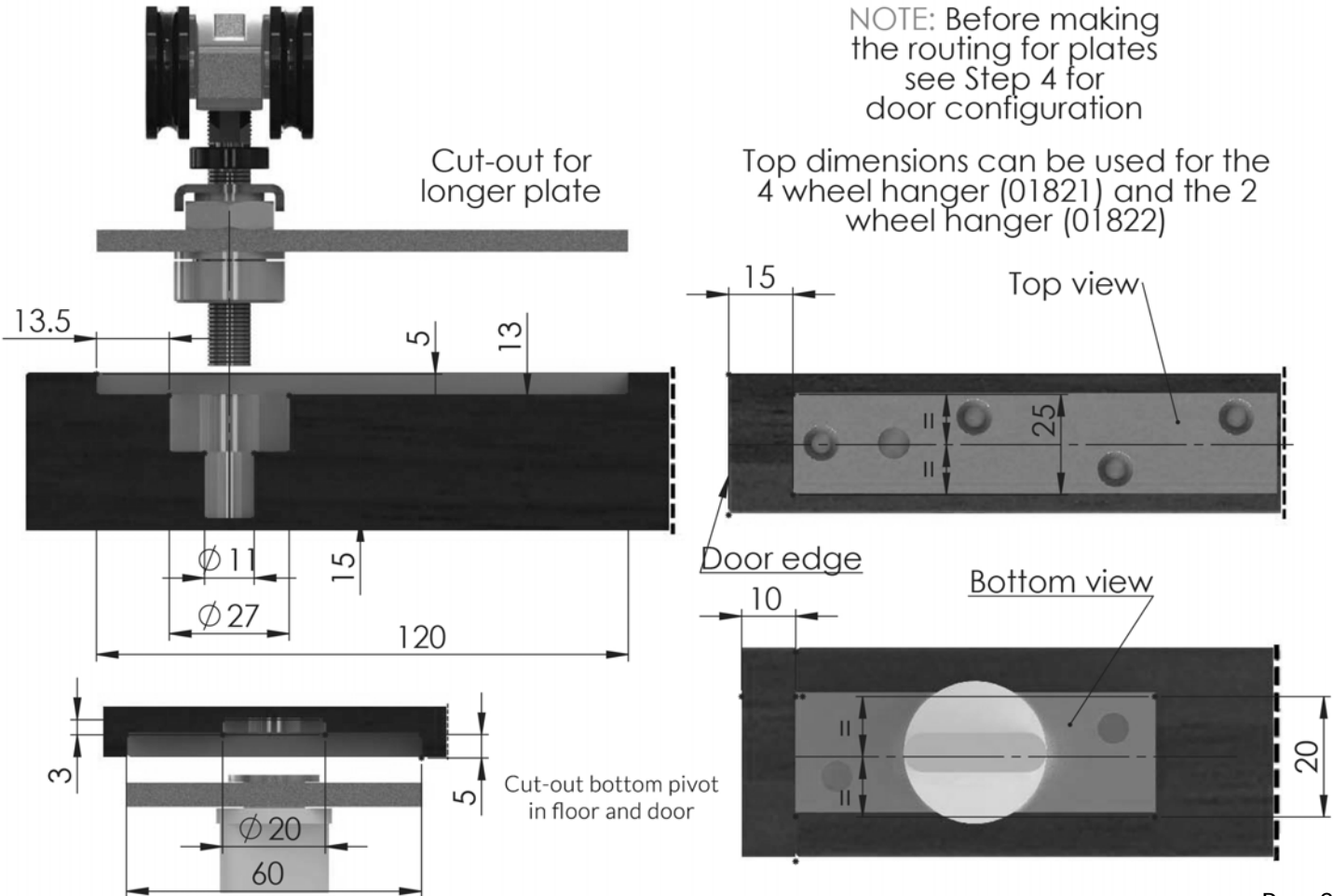

### Step 3. Preparing the door and track.

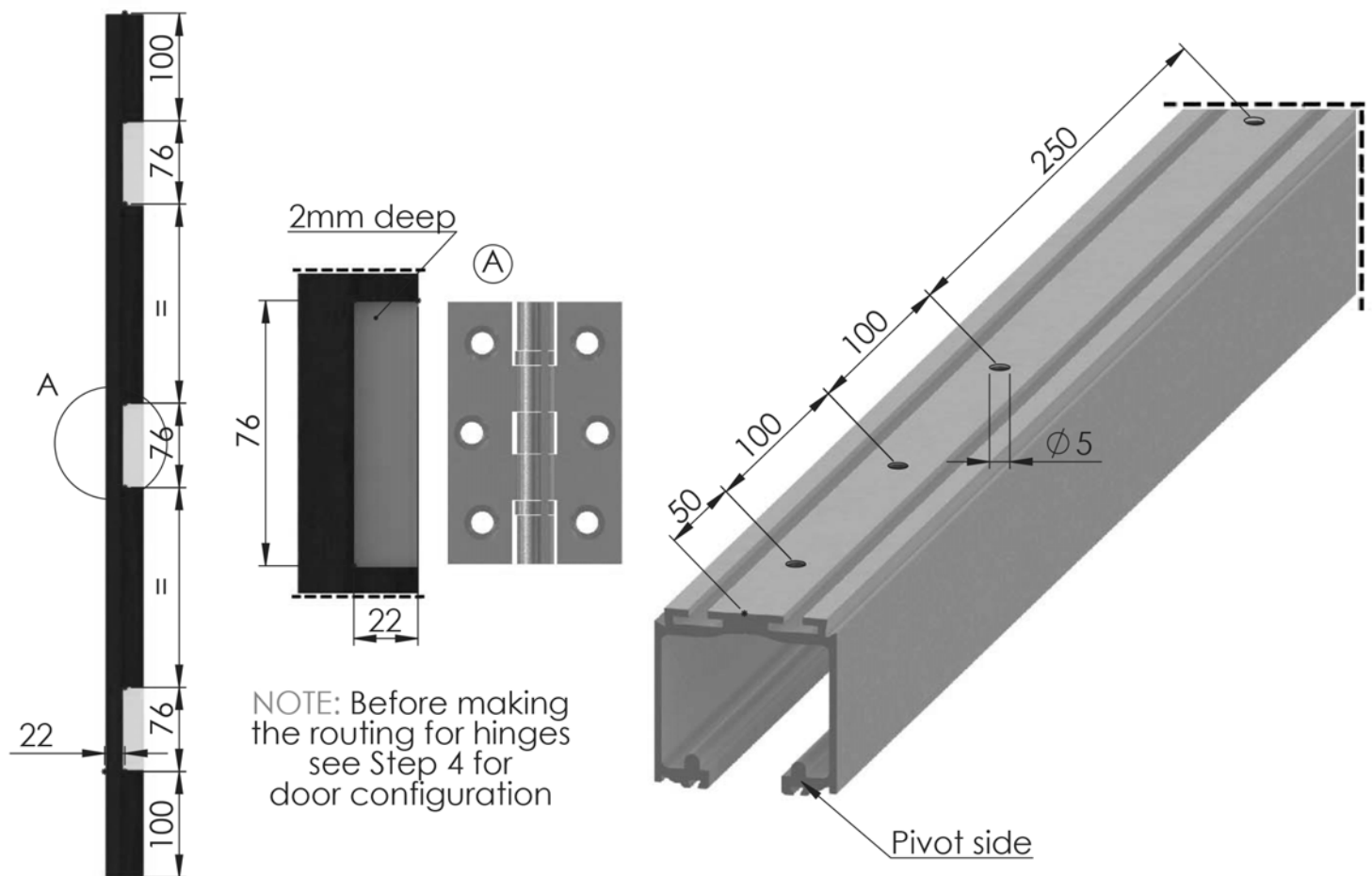

### Step 4. Door configuration.

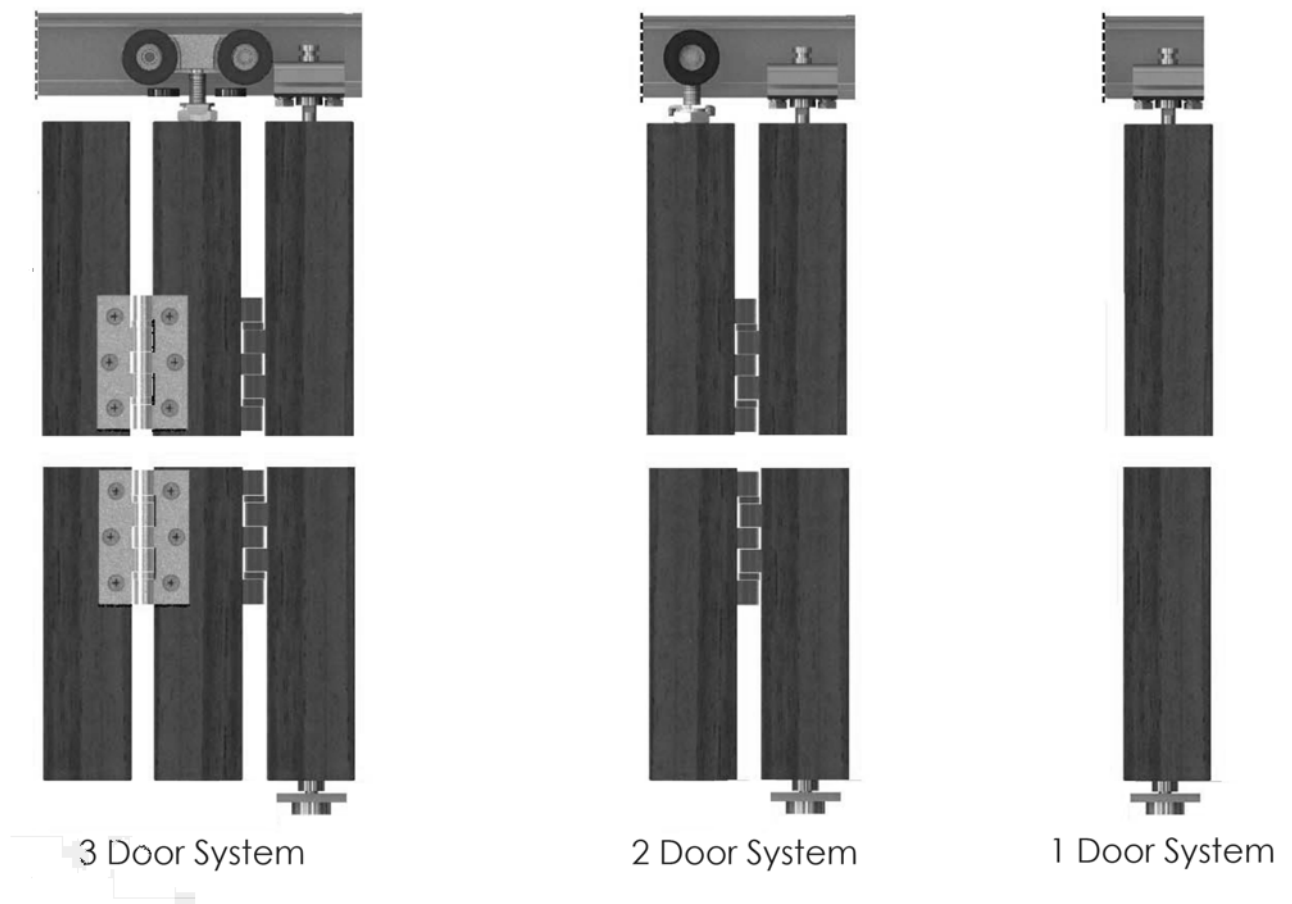



## Step 5. Bottom pivot base.

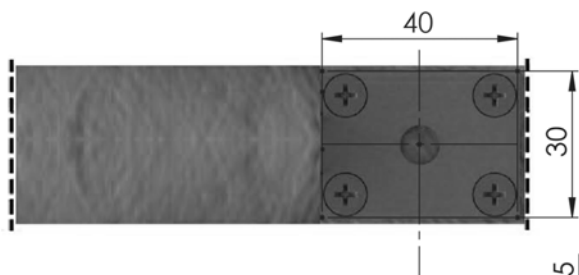

Fix the bottom pivot base plate with 4 screws.



Insert the top pivot into track and raise the top pivot pin so that the door can go under the assembly

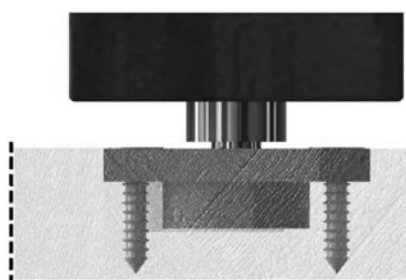

Insert the bottom pivot pin in the base plate and release the top pivot pin inside the top plate.

## Step 6. Leveling the door and insert the next leaf.

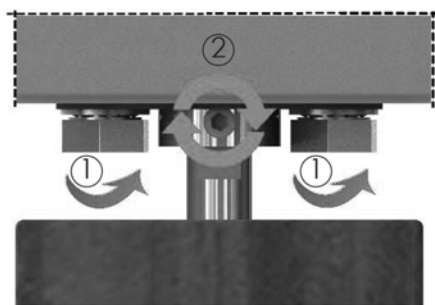

After ensuring the door level, tighten the 2 screws to fix the top pivot(1), afterwards tighten the grub screw to secure the top pivot pin(2)



Insert the top hanger into track and door into bottom pivot.

Bring assembly in position as seen in the left picture, ensure the level by adjusting the hanger bolt (after adjusting put the lock washer in place) and secure with screws.

Follow this step until the desired number of doors is achieved

